

10街区

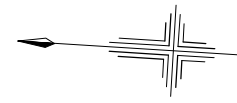

S = 1 / 500

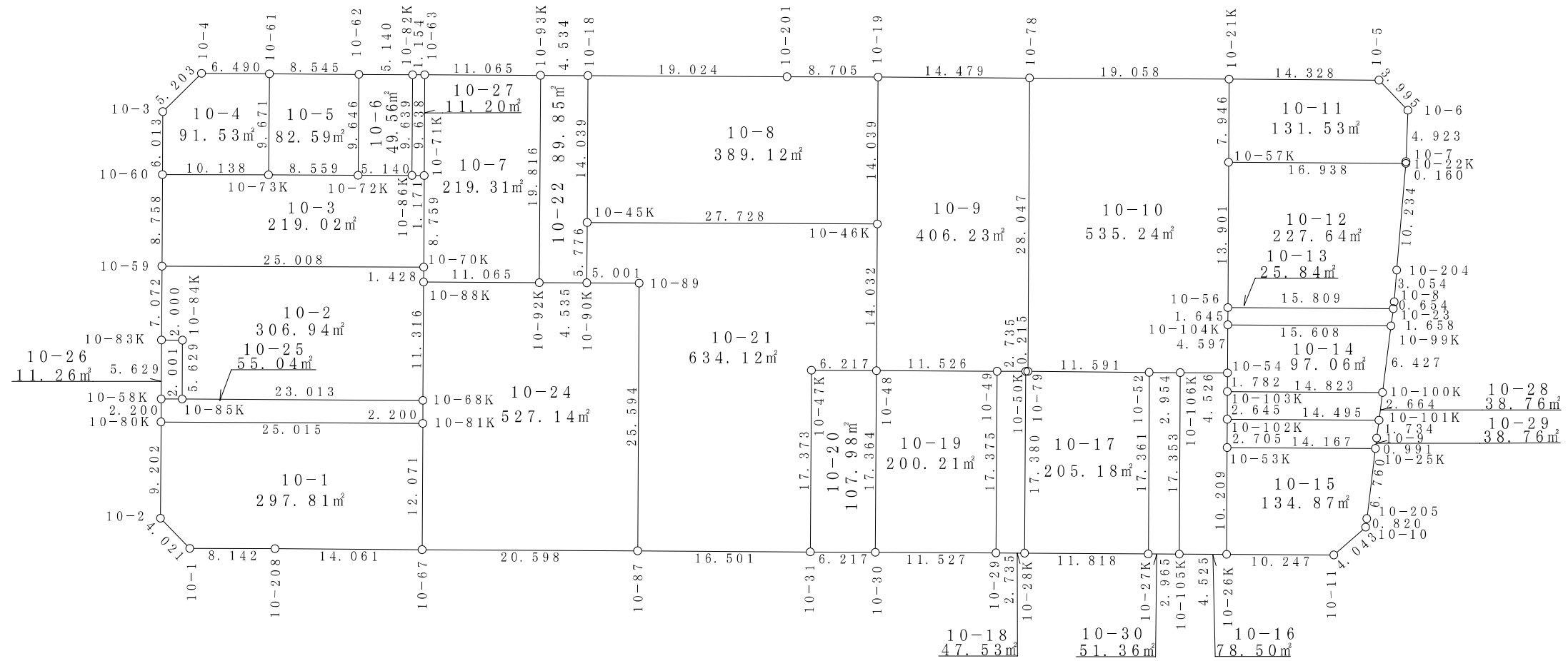

面積 (座標法) 計算書

地番 = 10-1

測点名	[1] X(i)	[2] X(i+1)-X(i-1)	[3] Y(i)	[4] Y(i+1)-Y(i-1)	[2]*[3]	[1]*[4]	方向角	夾角	距離
10-81K	-149394.620	-25.648	-38623.755	-10.666	990622.068240	1593443.016920	266-48-48	269-59-22	12.071
10-67	-149395.291	13.369	-38635.807	-12.819	-516522.103783	1915098.235329	356-52-23	270-03-35	14.061
10-208	-149381.251	22.169	-38636.574	-1.230	-856534.209006	183738.938730	356-44-25	179-52-02	8.142
10-1	-149373.122	11.101	-38637.037	2.245	-428909.747737	-335342.658890	42-20-20	225-35-55	4.021
10-2	-149370.150	3.479	-38634.329	11.896	-134408.830591	-1776907.304400	86-50-30	224-30-10	9.202
10-80K	-149369.643	-24.470	-38625.141	10.574	945157.200270	-15779434.605082	176-49-26	269-58-56	25.015
合計				倍面積 面積	-595.622607 297.81	595.622607 297.81			72.512

面積 (座標法) 計算書

地番 = 10-2

測点名	[1] X(i)	[2] X(i+1)-X(i-1)	[3] Y(i)	[4] Y(i+1)-Y(i-1)	[2]*[3]	[1]*[4]	方向角	夾角	距離
10-85K	-149371.520	23.289	-38622.833	4.345	-899487.157737	-649019.254400	86-49-57	270-00-30	5.629
10-84K	-149371.209	2.308	-38617.213	5.509	-89128.527604	-822885.990381	356-49-07	89-59-10	2.000
10-83K	-149369.212	2.386	-38617.324	6.950	-92140.935064	-1038116.023400	86-50-48	270-01-41	7.072
10-59	-149368.823	-24.578	-38610.263	8.491	948963.044014	-1268290.676093	176-43-19	269-52-31	25.008
10-70K	-149393.790	-25.046	-38608.833	0.004	966996.831318	-597.575160	266-49-45	270-06-26	1.428
10-88K	-149393.869	-0.708	-38610.259	-12.725	27336.063372	1901036.983025	266-48-49	179-59-04	11.316
10-68K	-149394.498	22.349	-38621.558	-12.574	-863153.199742	1878486.417852	356-49-27	270-00-38	23.013
合計				倍面積 面積	-613.881443 306.94	613.881443 306.94			75.466

面積 (座標法) 計算書

地番 = 10-3

測点名	[1] X(i)	[2] X(i+1)-X(i-1)	[3] Y(i)	[4] Y(i+1)-Y(i-1)	[2]*[3]	[1]*[4]	方向角	夾角	距離
10-71K	-149393.303	-1.656	-38600.088	-8.678	63921.745728	1296435.083434	266-48-45	270-05-34	8.759
10-70K	-149393.790	24.480	-38608.833	-10.175	-945144.231840	1520081.813250	356-43-19	269-54-34	25.008
10-59	-149368.823	25.454	-38610.263	7.314	-982785.634402	-1092483.571422	86-48-44	270-05-25	8.758
10-60	-149368.336	-9.634	-38601.519	9.324	371887.034046	-1392710.364864	176-43-13	269-54-29	10.138
10-73K	-149378.457	-18.666	-38600.939	1.070	720525.127374	-159834.948990	176-43-05	179-59-52	8.559
10-72K	-149387.002	-13.677	-38600.449	0.784	527938.340973	-117119.409568	176-43-16	180-00-11	5.140
10-86K	-149392.134	-6.301	-38600.155	0.361	243219.576655	-53930.560374	176-43-11	179-59-55	1.171
合計				倍面積 面積	-438.041466 219.02	438.041466 219.02			67.533

面積 (座標法) 計算書

地番 = 10-4

測点名	[1] X(i)	[2] X(i+1)-X(i-1)	[3] Y(i)	[4] Y(i+1)-Y(i-1)	[2]*[3]	[1]*[4]	方向角	夾角	距離
10-73K	-149378.457	9.616	-38600.939	-10.238	-371186.629424	1529336.642766	356-43-13	269-42-48	10.138
10-60	-149368.336	10.456	-38601.519	5.424	-403617.482664	-810173.854464	86-48-23	270-05-10	6.013
10-3	-149368.001	-3.136	-38595.515	9.880	121035.535040	-1475755.849880	131-50-41	225-02-18	5.203
10-4	-149371.472	-9.951	-38591.639	4.234	384025.399689	-632438.812448	176-50-16	224-59-35	6.490
10-61	-149377.952	-6.985	-38591.281	-9.300	269560.097785	1389214.953600	267-00-25	270-10-09	9.671
合計				倍面積 面積	-183.079574 91.53	183.079574 91.53			37.515

面積 (座標法) 計算書

地番 = 10-5

測点名	[1] X(i)	[2] X(i+1)-X(i-1)	[3] Y(i)	[4] Y(i+1)-Y(i-1)	[2]*[3]	[1]*[4]	方向角	夾角	距離
10-72K	-149387.002	8.027	-38600.449	-10.122	-309845.804123	1512095.234244	356-43-05	269-47-47	8.559
10-73K	-149378.457	9.050	-38600.939	9.168	-349338.497950	-1369501.693776	87-00-25	270-17-20	9.671
10-61	-149377.952	-8.027	-38591.281	10.122	309772.212587	-1512003.630144	176-53-14	269-52-49	8.545
10-62	-149386.484	-9.050	-38590.817	-9.168	349246.893850	1369575.285312	266-55-18	270-02-04	9.646
合計				倍面積 面積	-165.195636 82.59	165.195636 82.59			36.421

面積 (座標法) 計算書

地番 = 10-6

測点名	[1] X(i)	[2] X(i+1)-X(i-1)	[3] Y(i)	[4] Y(i+1)-Y(i-1)	[2]*[3]	[1]*[4]	方向角	夾角	距離
10-86K	-149392.134	4.614	-38600.155	-9.919	-178101.115170	1481820.577146	356-43-16	269-48-06	5.140
10-72K	-149387.002	5.650	-38600.449	9.338	-218092.536850	-1394975.824676	86-55-18	270-12-02	9.646
10-62	-149386.484	-4.614	-38590.817	9.919	178058.029638	-1481764.534796	176-47-57	269-52-39	5.140
10-82K	-149391.616	-5.650	-38590.530	-9.338	218036.494500	1395018.910208	266-55-10	270-07-13	9.639
合計				倍面積 面積	-99.127882 49.56	99.127882 49.56			29.565

面積 (座標法) 計算書

地番 = 10-7

測点名	[1] X(i)	[2] X(i+1)-X(i-1)	[3] Y(i)	[4] Y(i+1)-Y(i-1)	[2]*[3]	[1]*[4]	方向角	夾角	距離
10-92K	-149404.917	9.947	-38609.638	-20.406	-384050.069186	3048756.736302	356-46-58	269-58-04	11.065
10-88K	-149393.869	11.127	-38610.259	0.805	-429616.351893	-120262.064545	86-49-45	270-02-47	1.428
10-70K	-149393.790	0.566	-38608.833	10.171	-21852.599478	-1519484.238090	86-48-45	179-59-00	8.759
10-71K	-149393.303	1.022	-38600.088	18.368	-39449.289936	-2744056.189504	86-49-04	180-00-19	9.638
10-63	-149392.768	-10.513	-38590.465	10.235	405701.558545	-1529034.980480	176-49-46	270-00-42	11.065
10-93K	-149403.816	-12.149	-38589.853	-19.173	468828.124097	2864519.364168	266-48-54	269-59-08	19.816
合計				倍面積 面積	-438.627851 219.31	438.627851 219.31			61.771

面積 (座標法) 計算書

地番 = 10-8

測点名	[1] X(i)	[2] X(i+1)-X(i-1)	[3] Y(i)	[4] Y(i+1)-Y(i-1)	[2]*[3]	[1]*[4]	方向角	夾角	距離
10-45K	-149409.124	28.465	-38603.614	12.464	-1098851.872510	-1862235.321536	86-48-39	270-01-18	14.039
10-18	-149408.343	-18.214	-38589.597	15.072	702870.919758	-2251882.545696	176-49-16	270-00-37	19.024
10-201	-149427.338	-27.686	-38588.542	1.553	1068362.373812	-232060.655914	176-43-14	179-53-58	8.705
10-19	-149436.029	-9.470	-38588.044	-13.519	365428.776680	2020225.676051	266-49-09	270-05-55	14.039
10-46K	-149436.808	26.905	-38602.061	-15.570	-1038588.451205	2326731.100560	356-47-21	269-58-12	27.728
合計				倍面積 面積	-778.253465 389.12	778.253465 389.12			83.535

面積 (座標法) 計算書

地番 = 10-9

測点名	[1] X(i)	[2] X(i+1)-X(i-1)	[3] Y(i)	[4] Y(i+1)-Y(i-1)	[2]*[3]	[1]*[4]	方向角	夾角	距離
10-48	-149437.587	12.287	-38616.071	13.361	-474475.664377	-1996635.599907	86-49-03	270-02-43	14.032
10-46K	-149436.808	1.558	-38602.061	28.027	-60142.011038	-4188265.417816	86-49-09	180-00-06	14.039
10-19	-149436.029	-13.678	-38588.044	14.809	527807.265832	-2212998.153461	176-51-51	270-02-42	14.479
10-78	-149450.486	-16.012	-38587.252	-27.212	617859.079024	4066846.625032	266-49-18	269-57-27	28.047
10-79	-149452.041	-1.340	-38615.256	-28.016	51744.443040	4187048.380656	356-48-19	269-59-01	0.215
10-50K	-149451.826	2.946	-38615.268	-0.166	-113760.579528	24809.003116	356-46-21	179-58-02	2.735
10-49	-149449.095	14.239	-38615.422	-0.803	-549844.993858	120007.623285	356-46-20	179-59-59	11.526
合計				倍面積 面積	-812.460905 406.23	812.460905 406.23			85.073

面積 (座標法) 計算書

地番 = 10-10

測点名	[1] X(i)	[2] X(i+1)-X(i-1)	[3] Y(i)	[4] Y(i+1)-Y(i-1)	[2]*[3]	[1]*[4]	方向角	夾角	距離
10-54	-149471.085	4.266	-38614.239	-4.835	-164728.343574	722692.695975	356-53-48	270-03-06	4.526
10-106K	-149466.566	7.469	-38614.484	-0.405	-288411.580996	60533.959230	356-53-44	179-59-56	2.954
10-52	-149463.616	14.525	-38614.644	-0.772	-560877.704100	115385.911552	356-58-24	180-04-40	11.591
10-79	-149452.041	13.130	-38615.256	27.392	-507018.311280	-4093790.307072	86-49-18	269-50-54	28.047
10-78	-149450.486	-17.474	-38587.252	29.062	674273.641448	-4343330.024132	176-49-04	269-59-46	19.058
10-21K	-149469.515	-19.475	-38586.194	-6.875	751466.128150	1027602.915625	266-46-56	269-57-52	7.946
10-57K	-149469.961	-1.227	-38594.127	-21.812	47354.993829	3260238.789332	266-46-45	179-59-49	13.901
10-56	-149470.742	-0.871	-38608.006	-15.522	33627.573226	2320084.857324	266-51-53	180-05-08	1.645
10-104K	-149470.832	-0.343	-38609.649	-6.233	13243.109607	931651.695856	266-50-42	179-58-49	4.597
合計				倍面積 面積	-1070.493690 535.24	1070.493690 535.24			94.265

面積 (座標法) 計算書

地番 = 10-11

測点名	[1] X(i)	[2] X(i+1)-X(i-1)	[3] Y(i)	[4] Y(i+1)-Y(i-1)	[2]*[3]	[1]*[4]	方向角	夾角	距離
10-57K	-149469.961	17.359	-38594.127	7.007	-669955.450593	-1047336.016727	86-46-56	269-54-58	7.946
10-21K	-149469.515	-13.861	-38586.194	8.716	534843.235034	-1302776.292740	176-52-03	270-05-07	14.328
10-5	-149483.822	-17.244	-38585.411	-1.925	665366.827284	287756.357350	222-40-37	225-48-34	3.995
10-6	-149486.759	-3.056	-38588.119	-7.630	117925.291664	1140583.971170	268-36-54	225-56-17	4.923
10-7	-149486.878	-0.115	-38593.041	-5.082	4438.199715	759692.313996	271-25-56	182-49-02	0.160
10-22K	-149486.874	16.917	-38593.201	-1.086	-652881.181317	162342.745164	356-51-58	265-26-02	16.938
合計				倍面積 面積	-263.078213 131.53	263.078213 131.53			48.290

面積 (座標法) 計算書

地番 = 10-12

測点名	[1] X(i)	[2] X(i+1)-X(i-1)	[3] Y(i)	[4] Y(i+1)-Y(i-1)	[2]*[3]	[1]*[4]	方向角	夾角	距離
10-22K	-149486.874	-16.661	-38593.201	-9.305	643001.321861	1390975.362570	271-24-39	274-32-41	10.234
10-204	-149486.622	0.301	-38603.432	-13.285	-11619.633032	1985929.773270	270-55-09	179-30-30	3.054
10-8	-149486.573	0.095	-38606.486	-3.706	-3667.616170	553997.239538	274-02-08	183-06-59	0.654
10-23	-149486.527	15.831	-38607.138	-1.520	-611189.601678	227219.521040	356-51-09	262-49-01	15.809
10-56	-149470.742	16.566	-38608.006	13.011	-639580.227396	-1944763.824162	86-46-45	269-55-36	13.901
10-57K	-149469.961	-16.132	-38594.127	14.805	622600.456764	-2212902.772605	176-51-58	270-05-13	16.938
合計				倍面積 面積	-455.299651 227.64	455.299651 227.64			60.590

面積 (座標法) 計算書

地番 = 10-13

測点名	[1] X(i)	[2] X(i+1)-X(i-1)	[3] Y(i)	[4] Y(i+1)-Y(i-1)	[2]*[3]	[1]*[4]	方向角	夾角	距離
10-104K	-149470.832	15.674	-38609.649	0.786	-605167.638426	-117484.073952	86-51-53	270-00-45	1.645
10-56	-149470.742	-15.695	-38608.006	2.511	605952.654170	-375321.033162	176-51-09	269-59-16	15.809
10-23	-149486.527	-15.674	-38607.138	-0.786	605128.281012	117496.410222	273-50-22	276-59-13	1.658
10-99K	-149486.416	15.695	-38608.792	-2.511	-605964.990440	375360.390576	356-51-08	263-00-46	15.608
合計				倍面積 面積	-51.693684 25.84	51.693684 25.84			34.720

面積 (座標法) 計算書

地番 = 10-14

測点名	[1] X(i)	[2] X(i+1)-X(i-1)	[3] Y(i)	[4] Y(i+1)-Y(i-1)	[2]*[3]	[1]*[4]	方向角	夾角	距離
10-103K	-149471.185	14.901	-38616.018	0.966	-575417.284218	-144389.164710	86-46-58	269-55-36	1.782
10-54	-149471.085	0.353	-38614.239	6.369	-13630.826367	-951981.340365	86-50-42	180-03-44	4.597
10-104K	-149470.832	-15.331	-38609.649	5.447	591924.528819	-814167.621904	176-51-08	270-00-26	15.608
10-99K	-149486.416	-15.154	-38608.792	-5.556	585077.633968	830546.527296	273-50-10	276-59-02	6.427
10-100K	-149485.986	15.231	-38615.205	-7.226	-588148.187355	1080185.734836	356-51-22	263-01-12	14.823
合計				倍面積 面積	-194.135153 97.06	194.135153 97.06			43.237

面積 (座標法) 計算書

地番 = 10-15

測点名	[1] X(i)	[2] X(i+1)-X(i-1)	[3] Y(i)	[4] Y(i+1)-Y(i-1)	[2]*[3]	[1]*[4]	方向角	夾角	距離
10-25K	-149485.632	-13.742	-38620.582	-5.970	530724.037844	892429.223040	273-25-34	276-34-27	6.760
10-205	-149485.228	0.465	-38627.330	-7.566	-17961.708450	1131005.235048	274-15-53	180-50-19	0.820
10-10	-149485.167	2.938	-38628.148	-3.659	-113489.498824	546966.226053	315-21-39	221-05-46	4.043
10-11	-149482.290	13.108	-38630.989	-3.405	-506375.003812	508987.197450	356-50-41	221-29-02	10.247
10-26K	-149472.059	10.804	-38631.553	9.629	-417375.298612	-1439266.456111	86-46-57	269-56-16	10.209
10-53K	-149471.486	-13.573	-38621.360	10.971	524207.719280	-1639851.672906	176-51-07	270-04-10	14.167
合計				倍面積 面積	-269.752574 134.87	269.752574 134.87			46.246

面積 (座標法) 計算書

地番 = 10-16

測点名	[1] X(i)	[2] X(i+1)-X(i-1)	[3] Y(i)	[4] Y(i+1)-Y(i-1)	[2]*[3]	[1]*[4]	方向角	夾角	距離
10-106K	-149466.566	-3.544	-38614.484	17.571	136849.731296	-2626277.031186	176-53-48	270-07-03	4.526
10-54	-149471.085	-4.619	-38614.239	-1.534	178359.169941	229288.644390	266-46-58	269-53-10	1.782
10-103K	-149471.185	-0.249	-38616.018	-4.420	9615.388482	660662.637700	266-46-15	179-59-17	2.645
10-102K	-149471.334	-0.301	-38618.659	-5.342	11624.216359	798475.866228	266-46-45	180-00-30	2.705
10-53K	-149471.486	-0.725	-38621.360	-12.894	28000.486000	1927285.340484	266-46-57	180-00-12	10.209
10-26K	-149472.059	3.945	-38631.553	-10.450	-152401.476585	1561983.016550	356-44-40	269-57-43	4.525
10-105K	-149467.541	5.493	-38631.810	17.069	-212204.532330	-2551261.457329	86-46-45	270-02-05	17.353
合計				倍面積 面積	-157.016837 78.50	157.016837 78.50			43.745

面積 (座標法) 計算書

地番 = 10-17

測点名	[1] X(i)	[2] X(i+1)-X(i-1)	[3] Y(i)	[4] Y(i+1)-Y(i-1)	[2]*[3]	[1]*[4]	方向角	夾角	距離
10-50K	-149451.826	0.740	-38615.268	17.366	-28575.298320	-2595380.410316	176-48-19	269-57-18	0.215
10-79	-149452.041	-11.790	-38615.256	0.624	455273.868240	-93258.073584	176-58-24	180-10-05	11.591
10-52	-149463.616	-12.540	-38614.644	-16.722	484227.635760	2499330.586752	266-48-49	269-50-25	17.361
10-27K	-149464.581	10.835	-38631.978	-17.978	-418577.481630	2687074.237218	356-52-34	270-03-45	11.818
10-28K	-149452.781	12.755	-38632.622	16.710	-492759.093610	-2497355.970510	86-51-01	269-58-27	17.380
合計				倍面積 面積	-410.369560 205.18	410.369560 205.18			58.365

面積 (座標法) 計算書

地番 = 10-18

測点名	[1] X(i)	[2] X(i+1)-X(i-1)	[3] Y(i)	[4] Y(i+1)-Y(i-1)	[2]*[3]	[1]*[4]	方向角	夾角	距離
10-28K	-149452.781	1.776	-38632.622	-17.503	-68611.536672	2615872.025843	356-52-38	270-01-37	2.735
10-29	-149450.050	3.686	-38632.771	17.200	-142400.393906	-2570540.860000	86-50-57	269-58-19	17.375
10-49	-149449.095	-1.776	-38615.422	17.503	68580.989472	-2615807.509785	176-46-21	269-55-24	2.735
10-50K	-149451.826	-3.686	-38615.268	-17.200	142335.877848	2570571.407200	266-51-01	270-04-40	17.380
合計				倍面積 面積	-95.063258 47.53	95.063258 47.53			40.225

面積 (座標法) 計算書

地番 = 10-19

測点名	[1] X(i)	[2] X(i+1)-X(i-1)	[3] Y(i)	[4] Y(i+1)-Y(i-1)	[2]*[3]	[1]*[4]	方向角	夾角	距離
10-30	-149438.541	12.463	-38633.409	16.700	-481488.176367	-2495623.634700	86-51-02	270-01-25	17.364
10-48	-149437.587	-10.554	-38616.071	17.987	407554.013334	-2687933.877369	176-46-20	269-55-18	11.526
10-49	-149449.095	-12.463	-38615.422	-16.700	481264.004386	2495799.886500	266-50-57	270-04-37	17.375
10-29	-149450.050	10.554	-38632.771	-17.987	-407730.265134	2688158.049350	356-49-37	269-58-40	11.527
合計				倍面積 面積	-400.423781 200.21	400.423781 200.21			57.792

面積 (座標法) 計算書

地番 = 10-20

測点名	[1] X(i)	[2] X(i+1)-X(i-1)	[3] Y(i)	[4] Y(i+1)-Y(i-1)	[2]*[3]	[1]*[4]	方向角	夾角	距離
10-47K	-149431.379	-5.253	-38616.412	17.688	202852.012236	-2643142.231752	176-51-21	270-00-25	6.217
10-48	-149437.587	-7.162	-38616.071	-16.997	276568.300502	2539990.666239	266-51-02	269-59-41	17.364
10-30	-149438.541	5.253	-38633.409	-17.688	-202941.297477	2643268.913208	356-46-21	269-55-19	6.217
10-31	-149432.334	7.162	-38633.759	16.997	-276694.981958	-2539901.380998	86-50-56	270-04-35	17.373
合計				倍面積 面積	-215.966697 107.98	215.966697 107.98			47.171

面積 (座標法) 計算書

地番 = 10-21

測点名	[1] X(i)	[2] X(i+1)-X(i-1)	[3] Y(i)	[4] Y(i+1)-Y(i-1)	[2]*[3]	[1]*[4]	方向角	夾角	距離
10-87	-149415.857	17.896	-38634.653	24.661	-691405.750088	-3684744.449477	86-49-18	269-55-38	25.594
10-89	-149414.438	6.412	-38609.098	25.272	-247561.536376	-3776001.677136	356-45-22	89-56-04	5.001
10-90K	-149409.445	5.314	-38609.381	5.484	-205170.250634	-819361.396380	86-48-51	270-03-29	5.776
10-45K	-149409.124	-27.363	-38603.614	7.320	1056310.689882	-1093674.787680	176-47-21	269-58-30	27.728
10-46K	-149436.808	-28.463	-38602.061	-12.457	1098730.462243	1861534.317256	266-49-03	270-01-42	14.032
10-48	-149437.587	5.429	-38616.071	-14.351	-209646.649459	2144578.811037	356-51-21	270-02-18	6.217
10-47K	-149431.379	5.253	-38616.412	-17.688	-202852.012236	2643142.231752	266-50-56	89-59-35	17.373
10-31	-149432.334	15.522	-38633.759	-18.241	-599673.207198	2725795.204494	356-53-40	270-02-44	16.501
合計				倍面積 面積	-1268.253866 634.12	1268.253866 634.12			118.222

面積 (座標法) 計算書

地番 = 10-22

測点名	[1] X(i)	[2] X(i+1)-X(i-1)	[3] Y(i)	[4] Y(i+1)-Y(i-1)	[2]*[3]	[1]*[4]	方向角	夾角	距離
10-90K	-149409.445	4.207	-38609.381	-6.024	-162429.665867	900042.496680	356-45-05	269-56-14	4.535
10-92K	-149404.917	5.629	-38609.638	19.528	-217333.652302	-2917579.219176	86-48-54	270-03-49	19.816
10-93K	-149403.816	-3.426	-38589.853	20.041	132208.836378	-2994201.876456	176-45-48	269-56-54	4.534
10-18	-149408.343	-5.308	-38589.597	-13.761	204833.580876	2056008.208023	266-48-39	270-02-51	14.039
10-45K	-149409.124	-1.102	-38603.614	-19.784	42541.182628	2955910.109216	266-48-51	180-00-12	5.776
合計				倍面積 面積	-179.718287 89.85	179.718287 89.85			48.700

面積 (座標法) 計算書

地番 = 10-24

測点名	[1] X(i)	[2] X(i+1)-X(i-1)	[3] Y(i)	[4] Y(i+1)-Y(i-1)	[2]*[3]	[1]*[4]	方向角	夾角	距離
10-67	-149395.291	21.237	-38635.807	10.898	-820508.633259	-1628109.881318	86-48-48	270-01-30	12.071
10-81K	-149394.620	0.793	-38623.755	14.249	-30628.637715	-2128723.940380	86-49-18	180-00-30	2.200
10-68K	-149394.498	0.751	-38621.558	13.496	-29004.790058	-2016228.145008	86-48-49	179-59-31	11.316
10-88K	-149393.869	-10.419	-38610.259	11.920	402280.288521	-1780774.918480	176-46-58	269-58-09	11.065
10-92K	-149404.917	-15.576	-38609.638	0.878	601383.721488	-131177.517126	176-45-05	179-58-07	4.535
10-90K	-149409.445	-9.521	-38609.381	0.540	367599.916501	-80681.100300	176-45-22	180-00-17	5.001
10-89	-149414.438	-6.412	-38609.098	-25.272	247561.536376	3776001.677136	266-49-18	270-03-56	25.594
10-87	-149415.857	19.147	-38634.653	-26.709	-739737.700991	3990748.124613	356-47-18	269-58-00	20.598
合計				倍面積 面積	-1054.299137 527.14	1054.299137 527.14			92.380

面積 (座標法) 計算書

地番 = 10-25

測点名	[1] X(i)	[2] X(i+1)-X(i-1)	[3] Y(i)	[4] Y(i+1)-Y(i-1)	[2]*[3]	[1]*[4]	方向角	夾角	距離
10-68K	-149394.498	-23.100	-38621.558	-0.922	892157.989800	137741.727156	266-49-18	269-59-51	2.200
10-81K	-149394.620	24.855	-38623.755	-3.583	-959993.430525	535280.923460	356-49-26	270-00-08	25.015
10-80K	-149369.643	25.098	-38625.141	0.811	-969413.788818	-121138.780473	86-50-51	270-01-25	2.200
10-58K	-149369.522	-1.877	-38622.944	2.308	72495.265888	-344744.856776	176-49-13	269-58-22	2.001
10-85K	-149371.520	-24.976	-38622.833	1.386	964643.877008	-207028.926720	176-49-27	180-00-14	23.013
合計				倍面積 面積	-110.086647 55.04	110.086647 55.04			54.429

面積 (座標法) 計算書

地番 = 10-26

測点名	[1] X(i)	[2] X(i+1)-X(i-1)	[3] Y(i)	[4] Y(i+1)-Y(i-1)	[2]*[3]	[1]*[4]	方向角	夾角	距離
10-84K	-149371.209	-2.308	-38617.213	-5.509	89128.527604	822885.990381	266-49-57	270-00-50	5.629
10-85K	-149371.520	1.687	-38622.833	-5.731	-65156.719271	856048.181120	356-49-13	269-59-16	2.001
10-58K	-149369.522	2.308	-38622.944	5.509	-89141.754752	-822876.696698	86-50-34	270-01-21	5.629
10-83K	-149369.212	-1.687	-38617.324	5.731	65147.425588	-856034.953972	176-49-07	269-58-33	2.000
合計				倍面積 面積	-22.520831 11.26	22.520831 11.26			15.259

面積 (座標法) 計算書

地番 = 10-27

測点名	[1] X(i)	[2] X(i+1)-X(i-1)	[3] Y(i)	[4] Y(i+1)-Y(i-1)	[2]*[3]	[1]*[4]	方向角	夾角	距離
10-82K	-149391.616	-0.634	-38590.530	9.690	24466.396020	-1447604.759040	176-46-14	269-51-04	1.154
10-63	-149392.768	-1.687	-38590.465	-9.558	65102.114455	1427896.076544	266-49-04	270-02-50	9.638
10-71K	-149393.303	0.634	-38600.088	-9.690	-24472.455792	1447621.106070	356-43-11	269-54-07	1.171
10-86K	-149392.134	1.687	-38600.155	9.558	-65118.461485	-1427890.016772	86-55-10	270-11-59	9.639
合計				倍面積 面積	-22.406802 11.20	22.406802 11.20			21.602

面積 (座標法) 計算書

地番 = 10-28

測点名	[1] X(i)	[2] X(i+1)-X(i-1)	[3] Y(i)	[4] Y(i+1)-Y(i-1)	[2]*[3]	[1]*[4]	方向角	夾角	距離
10-102K	-149471.334	14.622	-38618.659	1.845	-564682.031898	-275774.611230	86-46-15	269-55-08	2.645
10-103K	-149471.185	-14.652	-38616.018	3.454	565801.895736	-516273.472990	176-51-22	270-05-07	14.823
10-100K	-149485.986	-14.622	-38615.205	-1.845	564631.527510	275801.644170	273-51-10	276-59-48	2.664
10-101K	-149485.807	14.652	-38617.863	-3.454	-565828.928676	516323.977378	356-51-07	262-59-57	14.495
合計				倍面積 面積	-77.537328 38.76	77.537328 38.76			34.627

面積 (座標法) 計算書

地番 = 10-29

測点名	[1] X(i)	[2] X(i+1)-X(i-1)	[3] Y(i)	[4] Y(i+1)-Y(i-1)	[2]*[3]	[1]*[4]	方向角	夾角	距離
10-53K	-149471.486	14.298	-38621.360	1.923	-552208.205280	-287433.667578	86-46-45	269-55-38	2.705
10-102K	-149471.334	-14.321	-38618.659	3.497	553057.815539	-522701.254998	176-51-07	270-04-22	14.495
10-101K	-149485.807	-14.357	-38617.863	-0.934	554436.659091	139619.743738	273-50-10	276-59-03	1.734
10-9	-149485.691	0.175	-38619.593	-2.719	-6758.428775	406451.593829	273-24-50	179-34-40	0.991
10-25K	-149485.632	14.205	-38620.582	-1.767	-548605.367310	264141.111744	356-51-07	263-26-17	14.167
合計				倍面積 面積	-77.526735 38.76	77.526735 38.76			34.092

面積 (座標法) 計算書

地番 = 10-30

測点名	[1] X(i)	[2] X(i+1)-X(i-1)	[3] Y(i)	[4] Y(i+1)-Y(i-1)	[2]*[3]	[1]*[4]	方向角	夾角	距離
10-105K	-149467.541	1.985	-38631.810	-17.494	-76684.142850	2614785.162254	356-45-06	269-58-21	2.965
10-27K	-149464.581	3.925	-38631.978	17.166	-151630.513650	-2565708.997446	86-48-49	270-03-43	17.361
10-52	-149463.616	-1.985	-38614.644	17.494	76650.068340	-2614716.498304	176-53-44	270-04-55	2.954
10-106K	-149466.566	-3.925	-38614.484	-17.166	151561.849700	2565743.071956	266-46-45	269-53-01	17.353
合計				倍面積 面積	-102.738460 51.36	102.738460 51.36			40.633