

21街区

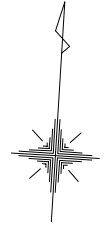

S = 1 / 500

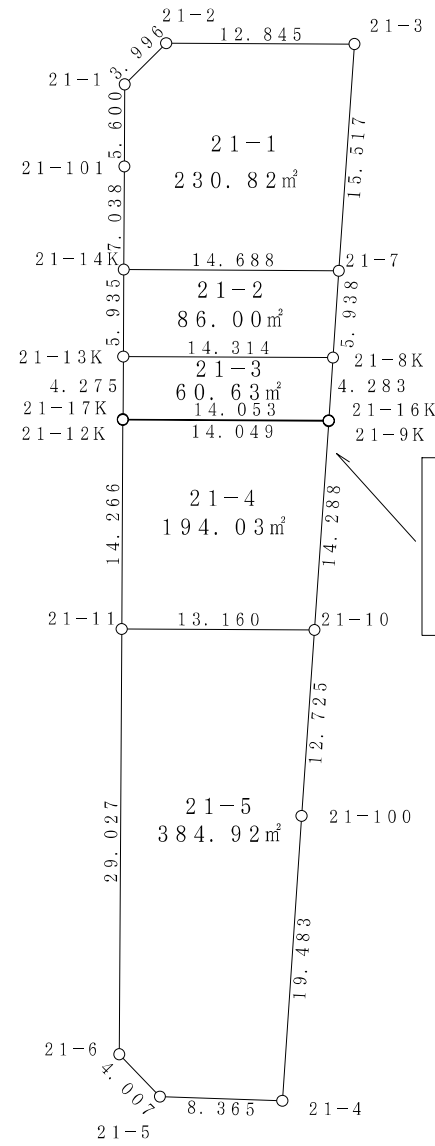

拡大図

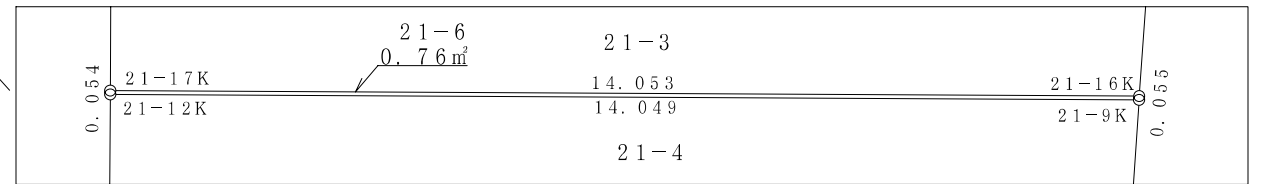

面積 (座標法) 計算書

地番 = 21-1

測点名	[1] X(i)	[2] X(i+1)-X(i-1)	[3] Y(i)	[4] Y(i+1)-Y(i-1)	[2]*[3]	[1]*[4]	方向角	夾角	距離
21-1	-149416.242	8.571	-38567.149	2.339	-330559.034079	-349484.590038	41-46-27	225-04-50	3.996
21-2	-149413.262	3.706	-38564.487	15.486	-142919.988822	-2313813.775332	86-45-35	224-59-08	12.845
21-3	-149412.536	-14.791	-38551.663	12.709	570217.647433	-1898883.920024	180-25-29	273-39-54	15.517
21-7	-149428.053	-16.325	-38551.778	-14.781	629357.775850	2208696.051393	266-50-48	266-25-19	14.688
21-14K	-149428.861	6.220	-38566.444	-15.048	-239883.281680	2248605.500328	356-53-20	270-02-32	7.038
21-101	-149421.833	12.619	-38566.826	-0.705	-486674.777294	105342.392265	356-41-37	179-48-17	5.600
合計				倍面積 面積	-461.658592 230.82	461.658592 230.82			59.684

面積 (座標法) 計算書

地番 = 21-2

測点名	[1] X(i)	[2] X(i+1)-X(i-1)	[3] Y(i)	[4] Y(i+1)-Y(i-1)	[2]*[3]	[1]*[4]	方向角	夾角	距離
21-13K	-149434.787	5.130	-38566.109	-14.627	-197844.139170	2185782.629449	356-45-52	269-57-08	5.935
21-14K	-149428.861	6.734	-38566.444	14.331	-259706.433896	-2141465.006991	86-50-48	270-04-56	14.688
21-7	-149428.053	-5.130	-38551.778	14.627	197770.621140	-2185684.131231	180-22-35	273-31-47	5.938
21-8K	-149433.991	-6.734	-38551.817	-14.331	259607.935678	2141538.525021	266-48-44	266-26-09	14.314
合計				倍面積 面積	-172.016248 86.00	172.016248 86.00			40.875

面積 (座標法) 計算書

地番 = 21-3

測点名	[1] X(i)	[2] X(i+1)-X(i-1)	[3] Y(i)	[4] Y(i+1)-Y(i-1)	[2]*[3]	[1]*[4]	方向角	夾角	距離
21-8K	-149433.991	-3.487	-38551.817	14.265	134430.185879	-2131675.881615	180-21-40	273-32-56	4.283
21-16K	-149438.274	-5.065	-38551.844	-14.058	195265.089860	2100803.255892	266-48-36	266-26-56	14.053
21-17K	-149439.056	3.487	-38565.875	-14.265	-134479.206125	2131748.133840	356-51-45	270-03-09	4.275
21-13K	-149434.787	5.065	-38566.109	14.058	-195337.342085	-2100754.235646	86-48-44	269-56-59	14.314
合計				倍面積 面積	-121.272471 60.63	121.272471 60.63			36.925

面積 (座標法) 計算書

地番 = 21-4

測点名	[1] X(i)	[2] X(i+1)-X(i-1)	[3] Y(i)	[4] Y(i+1)-Y(i-1)	[2]*[3]	[1]*[4]	方向角	夾角	距離
21-9K	-149438.329	-13.507	-38551.845	13.927	520719.770415	-2081227.607983	180-24-04	273-35-17	14.288
21-10	-149452.617	-15.025	-38551.945	-13.239	579242.973625	1978603.196463	266-47-22	266-23-18	13.160
21-11	-149453.354	13.507	-38565.084	-13.927	-520898.589588	2081436.861158	356-50-01	270-02-39	14.266
21-12K	-149439.110	15.025	-38565.872	13.239	-579452.226800	-1978424.377290	86-48-47	269-58-46	14.049
合計				倍面積 面積	-388.072348 194.03	388.072348 194.03			55.763

面積 (座標法) 計算書

地番 = 21-5
測点名

	[1] X(i)	[2] X(i+1)-X(i-1)	[3] Y(i)	[4] Y(i+1)-Y(i-1)	[2]*[3]	[1]*[4]	方向角	夾角	距離
21-11	-149453.354	29.720	-38565.084	11.537	-1146154.296480	-1724243.345098	86-47-22	269-57-11	13.160
21-10	-149452.617	-11.988	-38551.945	13.038	462160.716660	-1948563.220446	180-27-17	273-39-55	12.725
21-100	-149465.342	-32.208	-38552.046	-0.222	1241684.297568	33181.305924	180-21-21	179-54-04	19.483
21-4	-149484.825	-19.704	-38552.167	-8.483	759631.898568	1268079.770475	268-29-10	268-07-49	8.365
21-5	-149485.046	2.488	-38560.529	-11.315	-95938.596152	1691423.295490	312-31-57	224-02-47	4.007
21-6	-149482.337	31.692	-38563.482	-4.555	-1222153.871544	680892.045035	356-50-11	224-18-14	29.027
合計				倍面積 面積	-769.851380 384.92	769.851380 384.92			86.767

面積 (座標法) 計算書

地番 = 21-6
測点名

	[1] X(i)	[2] X(i+1)-X(i-1)	[3] Y(i)	[4] Y(i+1)-Y(i-1)	[2]*[3]	[1]*[4]	方向角	夾角	距離
21-16K	-149438.274	0.727	-38551.844	14.030	-28027.190588	-2096618.984220	181-02-30	274-13-54	0.055
21-9K	-149438.329	-0.836	-38551.845	-14.028	32229.342420	2096320.879212	266-48-47	265-46-17	14.049
21-12K	-149439.110	-0.727	-38565.872	-14.030	28037.388944	2096630.713300	356-49-13	270-00-26	0.054
21-17K	-149439.056	0.836	-38565.875	14.028	-32241.071500	-2096331.077568	86-48-36	269-59-23	14.053
合計				倍面積 面積	-1.530724 0.76	1.530724 0.76			28.211