

2街区

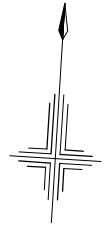

S = 1 / 5 0 0

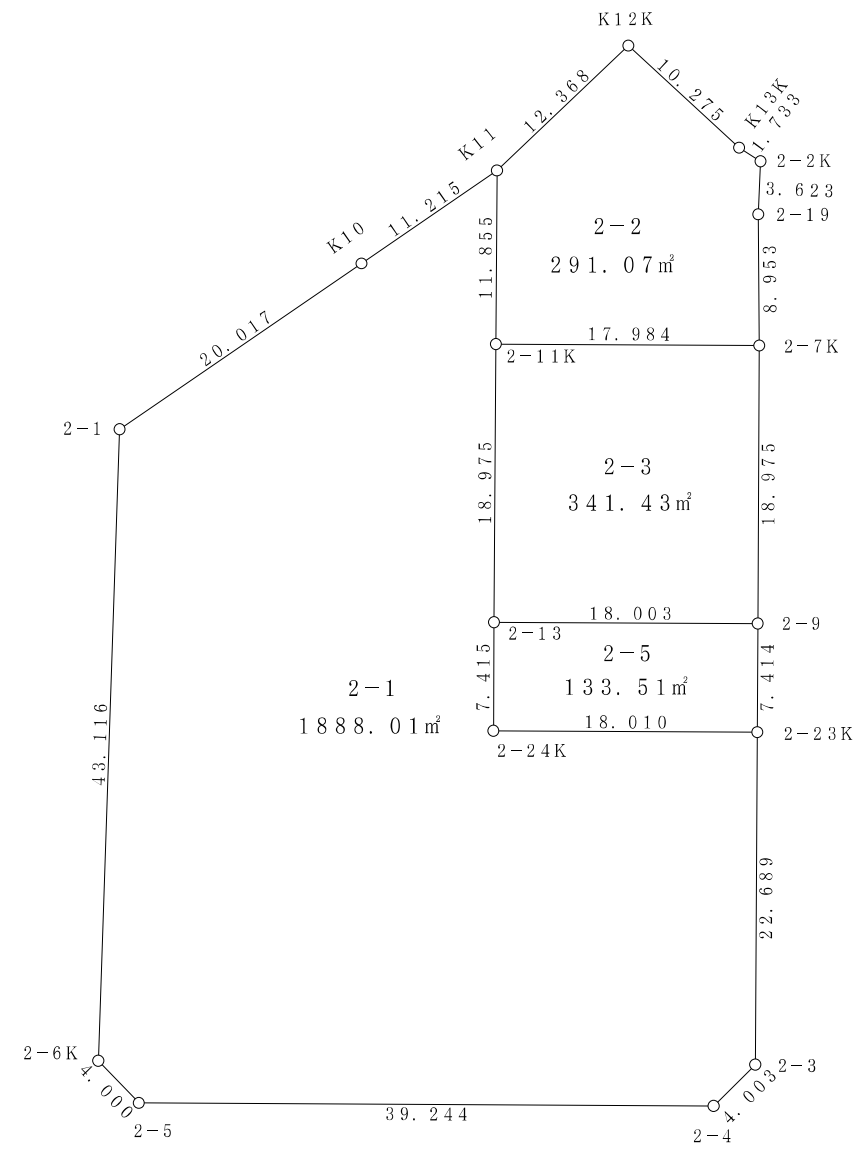

面積 (座標法) 計算書

地番 = 2-1
測点名

	[1] X(i)	[2] X(i+1)-X(i-1)	[3] Y(i)	[4] Y(i+1)-Y(i-1)	[2]*[3]	[1]*[4]	方向角	夾角	距離
2-1	-149223.572	55.407	-38695.043	14.618	-2143976.247501	-2181350.175496	52-03-41	233-36-54	20.017
K10	-149211.265	19.208	-38679.256	24.628	-742951.149248	-3674775.034420	52-01-32	179-57-51	11.215
K11	-149204.364	-4.936	-38670.415	9.497	190877.168440	-1416993.844908	176-49-41	304-48-09	11.855
2-11K	-149216.201	-30.784	-38669.759	1.690	1190409.861056	-252175.379690	176-52-35	180-02-54	18.975
2-13	-149235.148	-26.351	-38668.725	1.438	1018959.572475	-214600.142824	176-52-36	180-00-01	7.415
2-24K	-149242.552	-6.399	-38668.321	18.386	247438.586079	-2743973.561072	86-48-04	89-55-28	18.010
2-23K	-149241.547	-21.649	-38650.339	19.238	836741.189011	-2871108.881186	176-49-36	270-01-32	22.689
2-3	-149264.201	-25.641	-38649.083	-1.409	991001.137203	210313.259209	221-44-22	224-54-46	4.003
2-4	-149267.188	-5.180	-38651.748	-41.848	200216.054640	6246533.283424	266-47-48	225-03-26	39.244
2-5	-149269.381	0.516	-38690.931	-42.126	-19964.520396	6288121.944006	312-37-45	225-49-57	4.000
2-6K	-149266.672	45.809	-38693.874	-4.112	-1772527.674066	613784.555264	358-26-47	225-49-02	43.116
合計				倍面積 面積	-3776.022307 1888.01	3776.022307 1888.01			200.539

面積 (座標法) 計算書

地番 = 2-2
測点名

	[1] X(i)	[2] X(i+1)-X(i-1)	[3] Y(i)	[4] Y(i+1)-Y(i-1)	[2]*[3]	[1]*[4]	方向角	夾角	距離
2-11K	-149216.201	10.834	-38669.759	-18.612	-418948.169006	2777211.933012	356-49-41	270-01-31	11.855
K11	-149204.364	20.881	-38670.415	7.780	-807476.935615	-1160809.951920	43-00-28	226-10-47	12.368
K12K	-149195.320	2.561	-38661.979	16.407	-99013.328219	-2447847.615240	129-07-20	266-06-52	10.275
K13K	-149201.803	-7.325	-38654.008	9.486	283140.608600	-1415328.303258	119-03-51	169-56-31	1.733
2-2K	-149202.645	-4.464	-38652.493	1.580	172544.728752	-235740.179100	178-58-19	239-54-28	3.623
2-19	-149206.267	-12.553	-38652.428	0.690	485203.928684	-102952.324230	175-59-49	177-01-30	8.953
2-7K	-149215.198	-9.934	-38651.803	-17.331	383967.011002	2586048.596538	266-48-10	270-48-21	17.984
合計				倍面積 面積	-582.155802 291.07	582.155802 291.07			66.791

面積 (座標法) 計算書

地番 = 2-3
測点名

	[1] X(i)	[2] X(i+1)-X(i-1)	[3] Y(i)	[4] Y(i+1)-Y(i-1)	[2]*[3]	[1]*[4]	方向角	夾角	距離
2-11K	-149216.201	19.950	-38669.759	16.922	-771461.692050	-2525036.553322	86-48-10	269-55-35	17.984
2-7K	-149215.198	-17.943	-38651.803	19.009	693529.301229	-2836431.698782	176-49-08	270-00-58	18.975
2-9	-149234.144	-19.950	-38650.750	-16.922	771082.462500	2525340.184768	266-48-11	269-59-03	18.003
2-13	-149235.148	17.943	-38668.725	-19.009	-693832.932675	2836810.928332	356-52-35	270-04-24	18.975
合計				倍面積 面積	-682.860996 341.43	682.860996 341.43			73.937

面積 (座標法) 計算書

地番 = 2-5
測点名

	[1] X(i)	[2] X(i+1)-X(i-1)	[3] Y(i)	[4] Y(i+1)-Y(i-1)	[2]*[3]	[1]*[4]	方向角	夾角	距離
2-24K	-149242.552	6.399	-38668.321	-18.386	-247438.586079	2743973.561072	356-52-36	270-04-32	7.415
2-13	-149235.148	8.408	-38668.725	17.571	-325126.639800	-2622210.785508	86-48-11	269-55-35	18.003
2-9	-149234.144	-6.399	-38650.750	18.386	247326.149250	-2743818.971584	176-49-20	270-01-09	7.414
2-23K	-149241.547	-8.408	-38650.339	-17.571	324972.050312	2622323.222337	266-48-04	269-58-44	18.010
合計					倍面積 面積 -267.026317 133.51	267.026317 133.51			50.842