

7街区

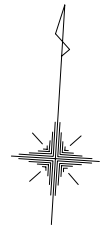

S = 1 / 500

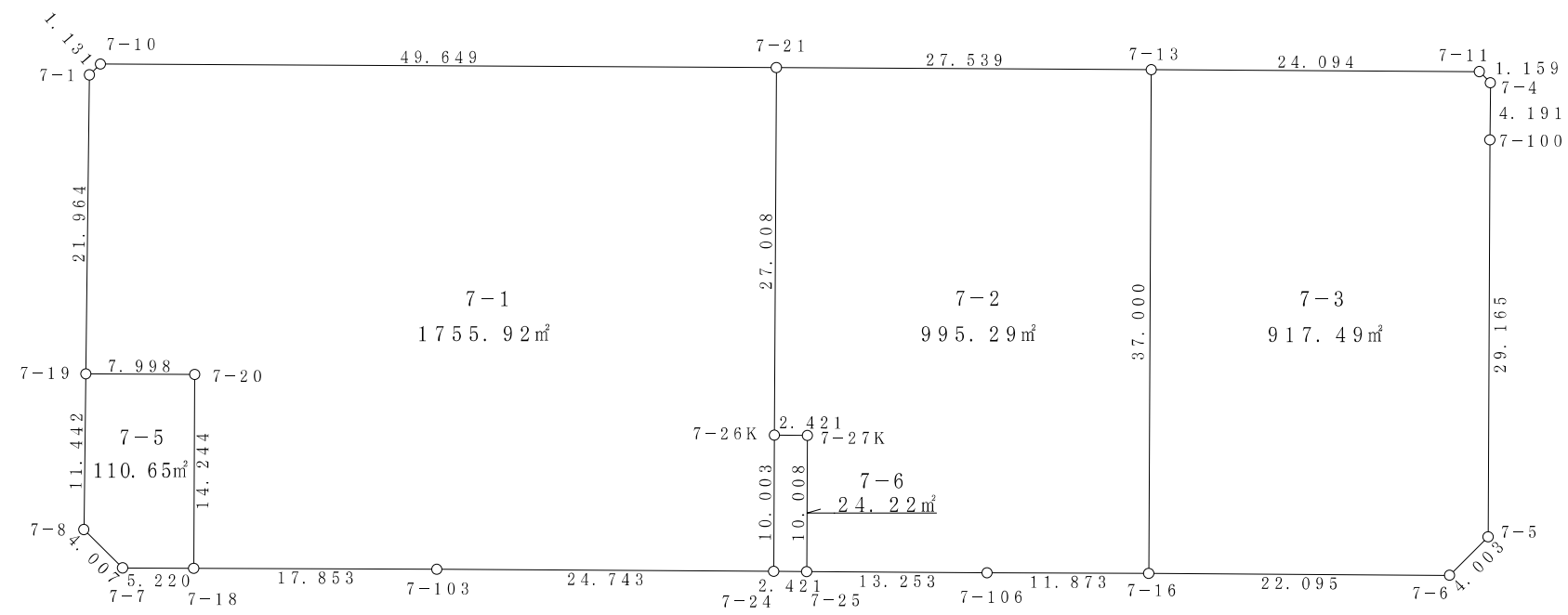

面積 (座標法) 計算書

地番 = 7-1
測点名

	[1] X(i)	[2] X(i+1)-X(i-1)	[3] Y(i)	[4] Y(i+1)-Y(i-1)	[2]*[3]	[1]*[4]	方向角	夾角	距離
7-1	-149377.160	22.772	-38745.894	-0.317	-882321.498168	47352.559720	42-25-13	225-14-20	1.131
7-10	-149376.325	3.612	-38745.131	50.334	-139947.413172	-7518707.942550	86-47-37	224-22-24	49.649
7-21	-149373.548	-24.189	-38695.560	51.071	936006.900840	-7628656.469908	176-48-58	270-01-21	27.008
7-26K	-149400.514	-36.954	-38694.060	2.056	1429900.293240	-307167.456784	176-48-50	179-59-52	10.003
7-24	-149410.502	-11.344	-38693.504	-24.150	438939.109376	3608263.623300	266-51-30	270-02-40	24.743
7-103	-149411.858	-2.370	-38718.210	-42.530	91762.157700	6354486.320740	266-44-38	179-53-08	17.853
7-18	-149412.872	13.208	-38736.034	-18.619	-511625.537072	2781918.263768	356-48-02	270-03-24	14.244
7-20	-149398.650	13.775	-38736.829	-8.780	-533599.819475	1311720.147000	266-47-45	89-59-43	7.998
7-19	-149399.097	21.490	-38744.814	-9.065	-832626.052860	1354302.814305	357-10-53	270-23-08	21.964
合計				倍面積 面積	-3511.859591 1755.92	3511.859591 1755.92			174.593

面積 (座標法) 計算書

地番 = 7-2
測点名

	[1] X(i)	[2] X(i+1)-X(i-1)	[3] Y(i)	[4] Y(i+1)-Y(i-1)	[2]*[3]	[1]*[4]	方向角	夾角	距離
7-21	-149373.548	28.491	-38695.560	25.997	-1102475.199960	-3883264.127356	86-49-32	270-00-34	27.539
7-13	-149372.023	-35.417	-38668.063	29.561	1369506.787271	-4415586.371903	176-48-08	269-58-36	37.000
7-16	-149408.965	-37.621	-38665.999	-9.790	1454653.548379	1462713.767350	266-43-18	269-55-10	11.873
7-106	-149409.644	-1.407	-38677.853	-25.087	54419.739171	3748239.739028	266-51-04	180-07-46	13.253
7-25	-149410.372	9.264	-38691.086	-13.790	-358434.220704	2060369.029880	356-48-34	269-57-30	10.008
7-27K	-149400.380	9.858	-38691.643	-2.974	-381422.216694	444316.730120	266-49-36	90-01-02	2.421
7-26K	-149400.514	26.832	-38694.060	-3.917	-1038239.017920	585201.813338	356-48-58	269-59-22	27.008
合計				倍面積 面積	-1990.580457 995.29	1990.580457 995.29			129.102

面積 (座標法) 計算書

地番 = 7-3
測点名

	[1] X(i)	[2] X(i+1)-X(i-1)	[3] Y(i)	[4] Y(i+1)-Y(i-1)	[2]*[3]	[1]*[4]	方向角	夾角	距離
7-13	-149372.023	38.281	-38668.063	21.993	-1480252.119703	-3285138.901839	86-48-51	270-00-43	24.094
7-11	-149370.684	0.563	-38644.006	24.918	-21756.575378	-3722018.703912	132-01-39	225-12-48	1.159
7-4	-149371.460	-4.961	-38643.145	1.082	191708.642345	-161619.919720	176-58-38	224-56-59	4.191
7-100	-149375.645	-33.304	-38642.924	1.865	1286963.940896	-278585.577925	176-46-07	179-47-29	29.165
7-5	-149404.764	-32.113	-38641.280	-1.013	1240887.424640	151347.025932	221-35-14	224-49-07	4.003
7-6	-149407.758	-4.201	-38643.937	-24.719	162343.179337	3693210.370002	266-52-07	225-16-53	22.095
7-16	-149408.965	35.735	-38665.999	-24.126	-1381729.474265	3604640.689590	356-48-08	269-56-01	37.000
合計				倍面積 面積	-1834.982128 917.49	1834.982128 917.49			121.707

面積 (座標法) 計算書

地番 = 7-5
測点名

	[1] X(i)	[2] X(i+1)-X(i-1)	[3] Y(i)	[4] Y(i+1)-Y(i-1)	[2]*[3]	[1]*[4]	方向角	夾角	距離
7-19	-149399.097	11.876	-38744.814	7.436	-460133.411064	-1110931.685292	86-47-45	269-32-45	7.998
7-20	-149398.650	-13.775	-38736.829	8.780	533599.819475	-1311720.147000	176-48-02	270-00-17	14.244
7-18	-149412.872	-14.511	-38736.034	-4.417	562098.589374	659956.655624	266-49-35	270-01-33	5.220
7-7	-149413.161	2.346	-38741.246	-8.231	-90886.963116	1229819.728191	311-06-53	224-17-18	4.007
7-8	-149410.526	14.064	-38744.265	-3.568	-544899.342960	533096.756768	357-15-00	226-08-07	11.442
合計				倍面積 面積	-221.308291 110.65	221.308291 110.65			42.911

面積 (座標法) 計算書

地番 = 7-6
測点名

	[1] X(i)	[2] X(i+1)-X(i-1)	[3] Y(i)	[4] Y(i+1)-Y(i-1)	[2]*[3]	[1]*[4]	方向角	夾角	距離
7-26K	-149400.514	10.122	-38694.060	1.861	-391661.275320	-278034.356554	86-49-36	270-00-46	2.421
7-27K	-149400.380	-9.858	-38691.643	2.974	381422.216694	-444316.730120	176-48-34	269-58-58	10.008
7-25	-149410.372	-10.122	-38691.086	-1.861	391631.172492	278052.702292	266-55-21	270-06-47	2.421
7-24	-149410.502	9.858	-38693.504	-2.974	-381440.562432	444346.832948	356-48-50	269-53-29	10.003
合計				倍面積 面積	-48.448566 24.22	48.448566 24.22			24.853