

画地原子一覽表用紙 (No. 7)

略 図

街区面積 =   
 換地面積 =

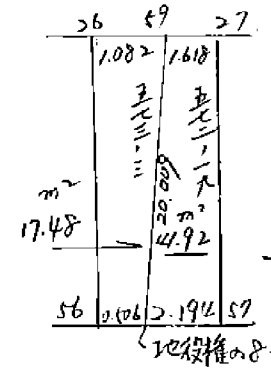

費用59.8.23

107,800.

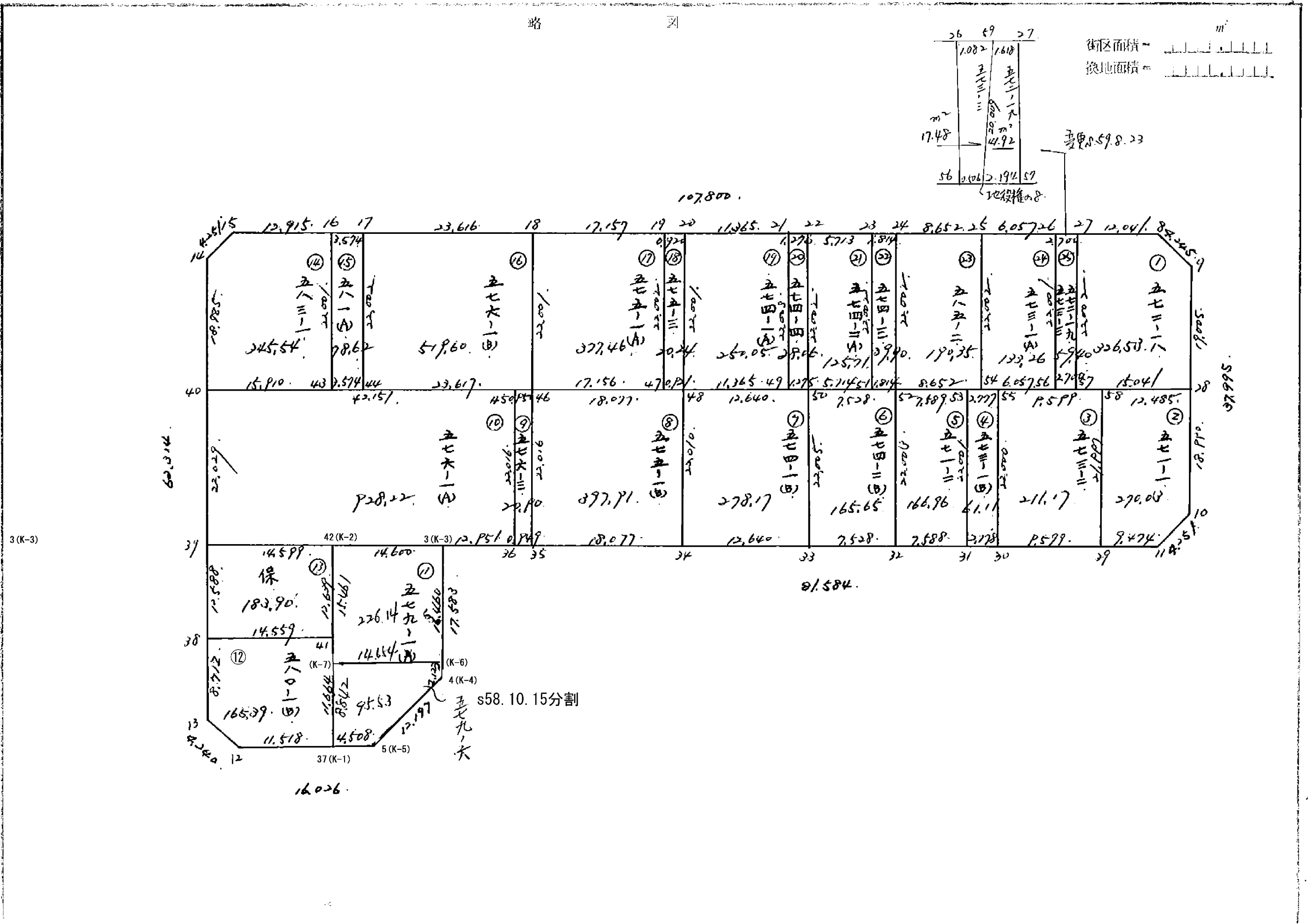

3(K-3)

16026.

計測者  
点検者

21974 130

2 BLOCK

5665.960524

1 LOT

326.537718

2 LOT

270.036117

3 LOT

211.171213

4 LOT

61.111840

5 LOT

166.967879

6 LOT

165.655007

7 LOT

278.170778

8 LOT

397.918019

9 LOT

20.901930

10 LOT

928.223972

11 LOT

321.669989

14 LOT

345.540659

15 LOT

78.625584

16 LOT

519.601605

17 LOT

377.464054

18 LOT

20.248661

19 LOT

250.054482

20 LOT

28.061188

21 LOT

125.715392

22 LOT

39.905057

23 LOT

190.354640

24 LOT

133.260274

25 LOT

59.402514

12 LOT

165.393152

13 LOT

183.907785

21974

5665.899509

0.000000

2 BLOCK

元/NO. X <sub>0</sub> , Y <sub>0</sub> =	X	Y	(X-X <sub>0</sub> ) (YN-1-Y <sub>0</sub> )	(XN-1-X <sub>0</sub> ) (Y-Y <sub>0</sub> )
8	-150400.000	-42700.000		
8	-150443.931	-42809.590		
9	-150445.509	-42805.649	4987.331310	4641.266219
10	-150480.472	-42790.777	8501.786328	4131.170493
11	-150484.416	-42792.364	7663.031232	7432.715808
3	-150516.398	-42867.418	10750.984872	14132.757888
4	-150532.574	-42860.525	22195.273932	18684.788950
5	-150542.748	-42867.252	22914.622700	22173.266648
12	-150549.020	-42882.000	24923.893040	28980.136000
13	-150547.442	-42885.935	26834.444000	27708.033700
14	-150490.110	-42910.349	16754.602850	31014.277258
15	-150486.161	-42908.774	18123.880189	18812.625140
8	-150443.931	-42809.590	9171.650594	9442.383990
			172821.501047	184153.422094
			分筆後座標なし	11331.921047
			分筆後座標なし	5665.960524

1 LOT

元/NO. X <sub>0</sub> , Y <sub>0</sub> =	X	Y	(X-X <sub>0</sub> ) (YN-1-Y <sub>0</sub> )	(XN-1-X <sub>0</sub> ) (Y-Y <sub>0</sub> )
8	-150400.000	-42700.000		
8	-150443.931	-42809.590		
9	-150445.509	-42805.649	4987.331310	4641.266219
28	-150462.998	-42798.210	6655.675702	4469.438890
58	-150467.890	-42809.697	6667.476900	6910.691606
57	-150468.891	-42812.050	7557.136027	7607.074500
27	-150448.648	-42820.669	5451.008400	8313.008079
8	-150443.931	-42809.590	5301.109339	5331.334320
			36619.738178	37272.813614
			分筆後座標なし	653.075436
			分筆後座標なし	326.537718

分筆後の座標なし

2 LOT

元/NO. X <sub>0</sub> , Y <sub>0</sub> =	X	Y	(X-X <sub>0</sub> ) (YN-1-Y <sub>0</sub> )	(XN-1-X <sub>0</sub> ) (Y-Y <sub>0</sub> )
28	-150462.998	-42798.210		
10	-150480.472	-42790.777	7903.155120	5718.769446
11	-150484.416	-42792.364	7663.031232	7432.715808
29	-150488.129	-42801.080	8139.946956	8532.769280
58	-150467.890	-42809.697	6862.321200	9667.486913
28	-150462.998	-42798.210	6910.691606	6667.476900
			37479.146114	38019.218347
			分筆後座標なし	540.072233
			分筆後座標なし	270.036117

分筆後の座標なし

3 LOT

元/NO. X <sub>0</sub> , Y <sub>0</sub> =	X	Y	(X-X <sub>0</sub> ) (YN-1-Y <sub>0</sub> )	(XN-1-X <sub>0</sub> ) (Y-Y <sub>0</sub> )
58	-150400.000	-42800.000		
29	-150467.890	-42809.697		
30	-150488.129	-42801.080	854.586913	73.321200
55	-150491.892	-42809.911	79.243360	873.446519
56	-150471.650	-42818.529	710.123150	1702.666868
57	-150469.949	-42814.534	1296.085021	1041.361100
58	-150468.891	-42812.050	1001.261794	842.885450
			818.074500	668.036027
			4779.374738	5201.717164
			点位座標 変換	422.342426
				211.171213

分筆後の座標なし

4 LOT

元/NO. X <sub>0</sub> , Y <sub>0</sub> =	X	Y	(X-X <sub>0</sub> ) (YN-1-Y <sub>0</sub> )	(XN-1-X <sub>0</sub> ) (Y-Y <sub>0</sub> )
55	-150400.000	-42800.000		
30	-150471.650	-42818.529		
31	-150491.892	-42809.911	1702.666868	710.123150
53	-150492.981	-42812.466	921.534691	1145.525672
54	-150472.738	-42821.085	906.751908	1960.504385
55	-150472.321	-42820.107	1524.888285	1462.542966
			1440.666550	1340.035809
			6496.508302	6618.731982
			点位座標 変換	122.223680
				61.111840

分筆後の座標なし

5 LOT

元/NO. X <sub>0</sub> , Y <sub>0</sub> =	X	Y	(X-X <sub>0</sub> ) (YN-1-Y <sub>0</sub> )	(XN-1-X <sub>0</sub> ) (Y-Y <sub>0</sub> )
53	-150400.000	-42800.000		
31	-150472.738	-42821.085		
32	-150492.981	-42812.466	1960.504385	906.751908
52	-150495.956	-42819.447	1196.187496	1808.201507
53	-150475.711	-42828.067	1472.351817	2693.197052
			2041.537446	1596.366433
			6670.581144	7004.516902
			点位座標 変換	333.935758
				166.967879

分筆後の座標なし

6 LOT

元/NO. X <sub>0</sub> , Y <sub>0</sub> =	X	Y	(X-X <sub>0</sub> ) (YN-1-Y <sub>0</sub> )	(XN-1-X <sub>0</sub> ) (Y-Y <sub>0</sub> )
	-150400.000	-42800.000		
52	-150475.711	-42828.067		
32	-150495.956	-42819.447	2693.197052	1472.351817
33	-150498.907	-42826.373	1923.444429	2530.647588
50	-150478.660	-42834.993	2074.500180	3461.052651
51	-150476.421	-42829.736	2674.200053	2339.033760
52	-150475.711	-42828.067	2251.342296	2144.908207
			11616.684010	11947.994023
			点ノイノセキ=	331.310013
			点ノセキ=	165.655007

分筆後の座標なし

7 LOT

元/NO. X <sub>0</sub> , Y <sub>0</sub> =	X	Y	(X-X <sub>0</sub> ) (YN-1-Y <sub>0</sub> )	(XN-1-X <sub>0</sub> ) (Y-Y <sub>0</sub> )
	-150400.000	-42800.000		
50	-150478.660	-42834.993		
33	-150498.907	-42826.373	3461.052651	2074.500180
34	-150503.862	-42838.001	2739.152526	3758.564907
48	-150483.612	-42846.623	3177.339612	4842.358026
49	-150479.160	-42836.166	3690.676680	3023.911592
50	-150478.660	-42834.993	2844.817560	2770.045880
			15913.039029	16469.380585
			点ノイノセキ=	556.341536
			点ノセキ=	278.170778

分筆後の座標なし

8 LOT

元/NO. X <sub>0</sub> , Y <sub>0</sub> =	X	Y	(X-X <sub>0</sub> ) (YN-1-Y <sub>0</sub> )	(XN-1-X <sub>0</sub> ) (Y-Y <sub>0</sub> )
	-150400.000	-42800.000		
48	-150483.612	-42846.623		
34	-150503.862	-42838.001	4842.358026	3177.339612
35	-150510.949	-42854.631	4216.172949	5674.084922
46	-150490.693	-42863.255	4954.649283	7018.078995
47	-150483.972	-42847.470	5311.648860	4305.196710
48	-150483.612	-42846.623	3969.061640	3915.026556
			23293.890758	24089.726795
			点ノイノセキ=	795.836037
			点ノセキ=	397.918019

9 LOT

元NO. X <sub>0</sub> , Y <sub>0</sub> =	X	Y	(X-X <sub>0</sub> ) (Y <sub>N-1</sub> -Y <sub>0</sub> )	(X <sub>N-1</sub> -X <sub>0</sub> ) (Y-Y <sub>0</sub> )
46	-150490.693	-42863.255		
35	-150510.949	-42854.631	7018.078995	4954.649283
36	-150511.321	-42855.504	6081.577551	6158.113296
45	-150491.065	-42864.129	5054.471760	7138.904409
46	-150490.693	-42863.255	5816.051397	5760.316575
			23970.179703	24011.983563
			平均値=	41.803860
			标准値=	20.901930

10 LOT

元NO. X <sub>0</sub> , Y <sub>0</sub> =	X	Y	(X-X <sub>0</sub> ) (Y <sub>N-1</sub> -Y <sub>0</sub> )	(X <sub>N-1</sub> -X <sub>0</sub> ) (Y-Y <sub>0</sub> )
45	-150491.065	-42864.129		
36	-150511.321	-42855.504	7138.904409	5054.471760
3	-150516.398	-42867.418	6460.554592	7505.039178
42	-150522.121	-42880.849	8233.153578	9410.661902
39	-150527.844	-42894.280	10336.059556	11513.567880
40	-150507.577	-42902.911	10142.359560	13156.553884
43	-150501.345	-42898.272	10429.515295	9496.036944
44	-150499.945	-42884.984	8822.345040	8612.703480
45	-150491.065	-42864.129	7739.067960	6409.372905
			69301.959990	71158.407933
			平均値=	1856.447943
			标准値=	928.228972

11 LOT

元NO. X <sub>0</sub> , Y <sub>0</sub> =	X	Y	(X-X <sub>0</sub> ) (Y <sub>N-1</sub> -Y <sub>0</sub> )	(X <sub>N-1</sub> -X <sub>0</sub> ) (Y-Y <sub>0</sub> )
3	-150516.398	-42867.418		
4	-150532.574	-42860.525	2196.073932	992.488950
5	-150542.748	-42867.232	2587.322700	2190.666648
37	-150544.512	-42871.400	2993.521024	3052.207200
41	-150533.850	-42875.899	2416.890000	3378.416288
42	-150522.121	-42880.849	1878.961779	2736.738650
3	-150516.398	-42867.418	1325.761793	1491.353578
			13198.531337	13841.871314
			平均値=	645.339977
			标准値=	321.669787

\*\* 座標法面積計算 \*\*

NO	ST	X	X'	S 1	Y	Y'	S 1
1	K-7	-150,536.366	-13.891	595574.374858	-42,874.838	-10.043	1511836.723730
2	K-6	-150,530.621	-3.792	162530.265744	-42,861.357	-14.313	2154544.778370
3	K-4	-150,532.574	12.127	-519769.586675	-42,860.525	5.895	-887389.523730
4	K-5	-150,542.748	11.938	-511749.254376	-42,867.252	10.875	-1637152.384500
5	K-1	-150,544.512	-6.382	273605.274800	-42,871.400	7.586	-1142030.668030
倍面積				191.074151			191.074160
						面積	95.5370755

\*\* 座標法面積計算 \*\*

NO	ST	X	X'	S 1	Y	Y'	S 1
1	K-2	-150,522.121	-19.968	856244.792832	-42,880.849	-7.420	1116874.137820
2	K-3	-150,516.398	8.500	-364373.053000	-42,867.418	-19.492	2933865.629810
3	K-6	-150,530.621	19.968	-855855.576576	-42,861.357	7.420	-1116937.207820
4	K-7	-150,536.366	-8.500	364436.123000	-42,874.838	19.492	-2934254.846070
倍面積				452.286256			452.286260
						面積	226.1431280

12 LOT

7/NO. X <sub>0</sub> , Y <sub>0</sub> =	X	Y	(X-X <sub>0</sub> ) (YN-1-Y <sub>0</sub> )	(XN-1-X <sub>0</sub> ) (Y-Y <sub>0</sub> )
12	-150500.000	-42800.000		
12	-150549.020	-42882.000		
13	-150547.442	-42885.935	3890.244000	4212.533700
138	-150539.427	-42889.349	3388.159245	4238.895258
141	-150533.766	-42875.935	3016.958334	2993.889245
37	-150544.512	-42871.400	3380.018720	2410.892400
12	-150549.020	-42882.000	3500.028000	3649.984000
			17175.408299	17506.194603
			n <sup>2</sup> 4/2セキ=	330.786304
			2セキ=	165.393152

13 LOT

7/NO. X <sub>0</sub> , Y <sub>0</sub> =	X	Y	(X-X <sub>0</sub> ) (YN-1-Y <sub>0</sub> )	(XN-1-X <sub>0</sub> ) (Y-Y <sub>0</sub> )
138	-150500.000	-42800.000		
39	-150539.427	-42889.349		
42	-150527.844	-42894.280	2487.833556	3717.177560
141	-150522.121	-42880.849	2085.567880	2251.159556
138	-150533.766	-42875.935	2729.947334	1679.758135
138	-150539.427	-42889.349	2993.889245	3016.958334
			10297.238015	10665.053585
			n <sup>2</sup> 4/2セキ=	367.815570
			2セキ=	183.907785



14 LOT

元NO. X <sub>0</sub> , Y <sub>0</sub> =	X	Y	(X-X <sub>0</sub> ) (Y <sub>N-1</sub> -Y <sub>0</sub> )	(X <sub>N-1</sub> -X <sub>0</sub> ) (Y-Y <sub>0</sub> )
14	-150490.110	-42910.349		
15	-150486.161	-42908.774	9507.780189	9801.625140
16	-150481.102	-42896.891	3821.788948	8348.225451
43	-150501.345	-42888.272	9819.418395	7159.035744
40	-150507.577	-42902.911	9496.036944	10429.515295
14	-150490.110	-42910.349	9273.310210	11871.014373
			46918.334686	47609.416003
			平均点=	691.081317
			点=	345.540659

15 LOT

元NO. X <sub>0</sub> , Y <sub>0</sub> =	X	Y	(X-X <sub>0</sub> ) (Y <sub>N-1</sub> -Y <sub>0</sub> )	(X <sub>N-1</sub> -X <sub>0</sub> ) (Y-Y <sub>0</sub> )
16	-150481.102	-42896.891		
17	-150479.702	-42893.603	7722.406482	7591.390506
44	-150499.945	-42884.984	9355.151835	6773.394768
43	-150501.345	-42888.272	8612.703480	8822.345040
16	-150481.102	-42896.891	7159.035744	9819.418395
			32849.297541	33006.548709
			平均点=	157.251168
			点=	78.625584

16 LOT

元NO. X <sub>0</sub> , Y <sub>0</sub> =	X	Y	(X-X <sub>0</sub> ) (Y <sub>N-1</sub> -Y <sub>0</sub> )	(X <sub>N-1</sub> -X <sub>0</sub> ) (Y-Y <sub>0</sub> )
17	-150479.702	-42893.603		
18	-150470.450	-42871.874	6594.331350	5728.501548
46	-150490.693	-42863.255	6518.468682	4456.314750
45	-150491.065	-42864.129	5760.316575	5816.051397
44	-150499.945	-42884.984	6409.372905	7739.067960
17	-150479.702	-42893.603	6773.394768	9355.151835
			32055.884280	33095.087490
			平均点=	1039.203210
			点=	519.601605

17 LOT

7/NO. X <sub>o</sub> , Y <sub>o</sub> =	X	Y	(X-X <sub>o</sub> ) (Y <sub>N-1</sub> -Y <sub>o</sub> )	(X <sub>N-1</sub> -X <sub>o</sub> ) (Y-Y <sub>o</sub> )
18	-150400.000	-42800.000		
19	-150470.450	-42871.874		
47	-150463.729	-42856.089	4580.458146	3951.470050
46	-150483.972	-42847.470	4709.905508	3025.215630
18	-150490.693	-42863.255	4305.196710	5311.648860
	-150470.450	-42871.874	4456.314750	6518.468682
			18051.875114	18806.803222
			n <sup>2</sup> 4/2 2 2 =	754.928108
			2/2 2 =	377.464054

18 LOT

7/NO. X <sub>o</sub> , Y <sub>o</sub> =	X	Y	(X-X <sub>o</sub> ) (Y <sub>N-1</sub> -Y <sub>o</sub> )	(X <sub>N-1</sub> -X <sub>o</sub> ) (Y-Y <sub>o</sub> )
19	-150400.000	-42800.000		
20	-150463.729	-42856.089		
48	-150463.369	-42855.242	3554.303841	3520.517418
47	-150483.612	-42846.623	4618.894104	2954.452887
19	-150483.972	-42847.470	3915.026356	3969.061640
	-150463.729	-42856.089	3025.215630	4709.905508
			15113.440131	15153.937453
			n <sup>2</sup> 4/2 2 2 =	40.497322
			2/2 2 =	20.248661

19 LOT

7/NO. X <sub>o</sub> , Y <sub>o</sub> =	X	Y	(X-X <sub>o</sub> ) (Y <sub>N-1</sub> -Y <sub>o</sub> )	(X <sub>N-1</sub> -X <sub>o</sub> ) (Y-Y <sub>o</sub> )
20	-150400.000	-42800.000		
21	-150463.369	-42855.242		
49	-150458.916	-42844.786	3254.637672	2838.044034
48	-150479.160	-42836.166	3545.259760	2130.756056
20	-150483.612	-42846.623	3023.911592	3690.676680
	-150463.369	-42855.242	2954.452887	4618.894104
			12778.261911	13278.370874
			n <sup>2</sup> 4/2 2 2 =	500.108963
			2/2 2 =	250.054482

20 LOT

元NO. X <sub>0</sub> , Y <sub>0</sub> =	X	Y	(X-X <sub>0</sub> ) (YN-1-Y <sub>0</sub> )	(XN-1-X <sub>0</sub> ) (Y-Y <sub>0</sub> )
21	-150400.000	-42800.000		
22	-150458.916	-42844.786		
50	-150478.660	-42834.993	2616.263762	2569.444592
49	-150479.160	-42834.166	3430.519920	2044.186081
21	-150458.916	-42844.786	2770.045880	2844.817560
			2130.756056	3545.259760
			10947.585618	11003.707993
			n <sup>2</sup> イ/σ <sup>2</sup> ε <sup>2</sup> =	56.122375
			σ <sup>2</sup> ε <sup>2</sup> =	28.061188

21 LOT

元NO. X <sub>0</sub> , Y <sub>0</sub> =	X	Y	(X-X <sub>0</sub> ) (YN-1-Y <sub>0</sub> )	(XN-1-X <sub>0</sub> ) (Y-Y <sub>0</sub> )
22	-150400.000	-42800.000		
23	-150458.417	-42843.612		
51	-150476.421	-42829.736	2450.034936	2240.584035
50	-150478.660	-42834.993	2931.127455	1670.509008
22	-150458.417	-42843.612	2339.033760	2674.200053
			2044.186081	3430.519920
			9764.382232	10015.813016
			n <sup>2</sup> イ/σ <sup>2</sup> ε <sup>2</sup> =	251.430784
			σ <sup>2</sup> ε <sup>2</sup> =	125.715392

22 LOT

元NO. X <sub>0</sub> , Y <sub>0</sub> =	X	Y	(X-X <sub>0</sub> ) (YN-1-Y <sub>0</sub> )	(XN-1-X <sub>0</sub> ) (Y-Y <sub>0</sub> )
23	-150400.000	-42800.000		
24	-150456.178	-42838.355		
52	-150475.711	-42828.067	2127.475140	2060.946108
51	-150476.421	-42829.736	2777.533746	1556.820356
23	-150456.178	-42838.355	2144.908207	2251.342296
			1670.509008	2931.127455
			8720.426101	8800.236215
			n <sup>2</sup> イ/σ <sup>2</sup> ε <sup>2</sup> =	79.810114
			σ <sup>2</sup> ε <sup>2</sup> =	39.905057

23 LOT

70/NO. X <sub>0</sub> , Y <sub>0</sub> =	X	Y	(X-X <sub>0</sub> ) (Y <sub>N-1</sub> -Y <sub>0</sub> )	(X <sub>N-1</sub> -X <sub>0</sub> ) (Y-Y <sub>0</sub> )
24	-150400.000	-42800.000		
24	-150455.468	-42836.686		
25	-150452.078	-42828.726	1910.533508	1593.373768
54	-150472.321	-42820.107	2077.493046	1047.132346
53	-150472.738	-42821.085	1462.542966	1524.888285
52	-150475.711	-42828.067	1596.366435	2041.537446
24	-150455.468	-42836.686	1556.820356	2777.533746
			8603.756311	8984.465591
			n <sup>2</sup> の平均 =	380.709280
			の平均 =	190.354640

24 LOT

70/NO. X <sub>0</sub> , Y <sub>0</sub> =	X	Y	(X-X <sub>0</sub> ) (Y <sub>N-1</sub> -Y <sub>0</sub> )	(X <sub>N-1</sub> -X <sub>0</sub> ) (Y-Y <sub>0</sub> )
25	-150400.000	-42800.000		
26	-150452.078	-42828.726		
26	-150449.706	-42823.153	1427.654556	1205.761934
56	-150469.949	-42814.534	1619.529197	722.427004
55	-150471.650	-42818.529	1041.361100	1296.085021
54	-150472.321	-42820.107	1340.035809	1440.666550
25	-150452.078	-42828.726	1047.132346	2077.493046
			6475.913008	6742.433555
			n <sup>2</sup> の平均 =	266.520547
			の平均 =	133.260274

25 LOT

70/NO. X <sub>0</sub> , Y <sub>0</sub> =	X	Y	(X-X <sub>0</sub> ) (Y <sub>N-1</sub> -Y <sub>0</sub> )	(X <sub>N-1</sub> -X <sub>0</sub> ) (Y-Y <sub>0</sub> )
26	-150400.000	-42800.000		
26	-150449.706	-42823.153		
27	-150448.648	-42820.449	1126.347144	1027.373314
57	-150468.891	-42812.050	1423.908079	586.208400
56	-150469.949	-42814.534	842.885450	1001.261794
26	-150449.706	-42823.153	722.427004	1619.529197
			4115.567677	4234.372705
			n <sup>2</sup> の平均 =	118.805028
			の平均 =	59.402514

25 LOT  $\overset{FAC}{m^2} 59.40 - \overset{m^2}{41.92} = \overset{m^2}{17.48}$

POINT.	X	Y	(X-X <sub>0</sub> )(Y <sub>N-1</sub> -Y <sub>0</sub> )	(X <sub>N-1</sub> -X <sub>0</sub> )(Y-Y <sub>0</sub> )
X <sub>0</sub> Y <sub>0</sub>	-150400.000	-42800.000		
26	-150449.706	-42823.153		
59	-150449.282	-42822.157	1141.026146	1101.335842
8(地役権)	-150469.751	-42814.068	1345.472907	693.299176
56	-150469.949	-42814.534	984.042532	1013.761034
26	-150449.706	-42823.153	722.427004	1619.529197
			4392.968589	4427.925249
			0 <sup>イ</sup> イの座標=	34.956660
			ズの座標=	17.478330

点梅

26 LOT

POINT.	X	Y	(X-X <sub>0</sub> )(Y <sub>N-1</sub> -Y <sub>0</sub> )	(X <sub>N-1</sub> -X <sub>0</sub> )(Y-Y <sub>0</sub> )
X <sub>0</sub> Y <sub>0</sub>	-150400.000	-42800.000		
59	-150449.282	-42822.157		
27	-150448.648	-42820.669	1077.893736	1018.609658
57	-150468.891	-42812.050	1423.908079	386.208400
8(地役権)	-150469.751	-42814.068	840.499350	969.158588
59	-150449.282	-42822.157	693.299176	1545.472907
			4035.600541	4119.449553
			0 <sup>イ</sup> イの座標=	83.849012
			ズの座標=	41.924506

分筆後の座標なし

\*\*\*\*\*  
 ガイ スの座標= 0.000000  
 カブリソウスの座標= 59.402336  
 スキリソウスの座標= 0.000000  
 \*\*\*\*\*