

2318 70-7-56

250-7-56

2270

176-27-318
 1.5631
 22.675
 66.48
 66.50
 25.751
 13.500
 保 76.78
 195-1
 36.78
 13.500
 13.502
 13.502
 19.921
 保 76.79
 195-2
 36.78
 13.502
 19.921
 保 76.79
 57.69
 21.804

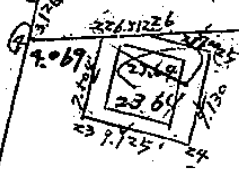

5
 元
 =
 1
 =
 2

保 (19)

1703.48
 1728.78

A. 7203.6759 - 4899 =
 B. 7203.6614 - 4899 =
 0.0145

7198.7989
 7198.7644
 0.0345

7.004

91.295

1.000

267 81-26-24

261-26-24

2270

14-22-24

14-22-24

71-21-046

面積計算書

工区 _____ フロック 141 計算者 _____ 精算者 _____ 備考 _____

点	①	②	③	④	⑤	⑥	③ × ⑤		② × ⑥	
	X	X - (定数)	X _{n-1} - X _{n+1}	Y	Y - (定数)	Y _{n-1} - Y _{n+1}	+	-	+	-
3	114 381 034	81 034 +	28 957	34 913 044	913 044 +	71 308 ³		3273.4151		5777.8382 ⁹¹⁰³
7	114 384 154	84 154 -	21 655	34 912 051	112 051 -	68 749	2443.7884			5705.5033
20	114 389 379	39 379 +	52 877	34 844 295	44 295 -	96 515		2346.6162		5730.9641
27	114 437 131	137 131 +	78 655	34 816 336	16 336 -	30 841		1284.9080		4229.2571
28	114 438 034	138 034 -	38 134	34 813 454	13 454 -	4 114	5.1259			567.8718
29	114 436 750	136 750 -	82 837	34 812 222	12 222 +	28 095 ⁴	1012.4338			3841.9912 ⁸¹⁶⁵
B	114 385 197	55 197 -	55 716	34 841 548	41 548 +	100 822	2314.7440 ⁸⁸⁸³			5565.0719
							5776.2364	6904.9393	6313.5963	1548.4891
							5776.2364	5776.2364	5776.2364	5776.2364
							1128.7029	56435/4		1128.7026
							1128.7029	56435/4		1128.7026
								170.7162		
IV	114 428 632	⁽²⁾ 30 632 +	1 284	34 811 545	545 +	1 232		0.6997		3.2426
28	114 438 034	⁽²⁾ 38 034 -	1 882	34 813 454	2 454 +	677	4.6184			1.3970
29	114 436 750	⁽⁰⁾ 36 750 +	598	34 812 222	1 222 -	1 909		0.7307	1.4317	
							4.6184	1.4314	1.4317	4.6196
							3.1880 1/3 =	1.5940		3.1879

0.4821

面積計算書

工
区

ブロック

141

計算者

精算者

備考

点	①	②	③	④	⑤	⑥	③ × ⑤		② × ⑥	
	X	X -- (定数)	X _{n-1} - X _{n+1}	Y	Y -- (定数)	Y _{n-1} - Y _{n+1}	+	-	+	-
		-154.430.000			-34.802.000					
ト	407 409	17.409+	14.757	34 908 937	108.937+	91.290-		1607.1425		1589.2626
ニ	448 411	18.411-	12.068	34 908 875	108.875-	86.888-	1313.9035		1599.6949	
三	435 341	5.341-	11.280	34 822 049	22.049-	92.539-	248.7127	448.7127	474.2507	
ニ	437 131	7.131-	1.273	34 816 036	16.036-	464	22.4904		21.8327	
シ	422 658	3.658+	10.278	34 817 585	17.585+	72.601		180.2386		338.2344
							1590.1096	1787.8861	2125.7283	1928.0020
							177.2565	1/2	98.8882 m²	197.7767
									29.9136	

面積計算書

区 3 ブロック 141 計算者 精算者 備考

点	① X	② X - (定数)	③ X _{n1} - X _{n1}	④ Y	⑤ Y - (定数)	⑥ Y _{n1} - Y _{n1}	③ +	X	⑤ -	② +	X	⑥ -
591-5 592-6		-154.300.000			-34.800.000							
14	-154 362 2064	- 4.246	- 2757	-34890.477	- 90.477	+ 24.390	68.4926					1518.1799
15	-154 369 953	- 69.953	+ 8.281	-34911.807	- 111.807	+ 21.912		126.1918				1518.8195
A	-154 370 537	- 70.537	+ 9.510	-34912.191	- 112.191	- 0.169		1014.9304		11.9207		
16	-154 379 463	- 79.463	+ 0.173	-34911.638	- 111.638	- 24.774		9.3134		1863.6164		
17	-154 370 710	- 70.710	- 17.217	-34887.417	- 87.417	- 21.159	1525.0585			1496.1529		
							1573.5511	2.013.2416		3.496.6900		3.036.1994
						分筆あり	439.6905	219.2463		66.5032		439.6906
水廻		+154.300.000			-34.800.000							
A	-154 370 537	- 70.537	- 6.834	-34912.191	- 12.191	+ 1.926	83.3133					135.8542
1	-154 372 629	- 72.629	+ 9.457	-34913.564	- 13.564	+ 0.917		128.2747				66.6008
2	-154 379 994	- 79.994	+ 6.834	-34913.108	- 13.108	- 1.926		89.5201		154.0694		
16	-154 379 463	- 79.463	- 9.457	-34911.638	- 11.638	- 0.917	110.0606			72.2676		
							193.3739	217.8548		226.9369		202.4550
							244.201	12.2404		3.9027		24.481

面積計算書

①	②	③	④	⑤	⑥	⑦	⑧	⑨	⑩
X	X - (1%)	X _{n-1} - X _{n-2}	Y	Y - (1%)	Y _{n-1} - Y _{n-2}				
30	-14.368.268	-68.268	14.486	-34.907.144	-107.144	13.602	1.552.0879		928.5813
14	-14.362.246	-62.246	2.442	-34.890.479	-90.479	19.727	220.9497		1.227.9268
17	-14.370.710	-70.710	14.486	-34.887.47	-87.47	13.602	1.266.2226		961.7974
31	74.376.732	-76.732	2.442	-34.904.081	-104.081	19.727	254.1658		1.13.6921
							1.806.2527	1.487.2723	2.156.4081
							318.7814	1/2 = 159.4907	2.425.4095

$$491-5) \quad 219.8253 - 159.4907 = 60.3346 \text{ m}^2$$

$$492-6) \quad 18.2572 \text{ m}^2$$

48.245939

面積計算書

工
区

ブ
ロ
ック

141

計
算
者

精
算
者

備
考

点

保

点	①	②	③	④	⑤	⑥	③ × ⑤		② × ⑥		
	X	X - (定数)	X _{n-1} - X _n	Y	Y - (定数)	Y _{n-1} - Y _n	+	-	+	-	
4	754 384 154 ✓	84 154 ✓ +	64.638 - 34 ✓	912 851 ✓	112 851 ✓ -	1.087		✓ 7299.9629		7.3213	
5	754 447 409 ✓	147 409 ✓ +	79.509 - 34 ✓	908 937 ✓	108 937 ✓ -	95.266		✓ 5392.8173		14943.0657	
21	754 433 658 ✓	133 658 ✓ -	88.030 - 34 ✓	817 855 ✓	17 855 ✓ -	69.642	✓ 1548.0075			8639.9204	
20	754 357 377 ✓	59 377 ✓ -	53.100 - 34 ✓	844 275 ✓	44 275 ✓ +	85.215	✓ 2342.0645			5063.9193	
26	754 380 558 ✓	80 558 ✓ +	20.902 - 34 ✓	902 900 ✓	102 900 ✓ +	55.817	✓ 2150.2158			9496.8058	
25	754 380 281 ✓	80 281 ✓ +	8.804 - 34 ✓	900 112 ✓	100 112 ✓ -	3.672	✓ 881.3860			299.7918	
24	754 389 362 ✓	89 362 ✓ +	9.956 - 34 ✓	899 228 ✓	99 228 ✓ +	8.243	✓ 907.9139			736.6109	
23	754 390 237 ✓	90 237 ✓ -	6.591 - 34 ✓	908 255 ✓	108 255 ✓ +	9.996	✓ 714.1678			883.9616	
22	754 382 771 ✓	82 771 ✓ -	6.083 - 34 ✓	909 024 ✓	109 024 ✓ +	4.496	✓ 663.1929			372.1384	
								5277.9327	16707.3958	22985.0992	11545.1360
								11429.9631			11429.9633
								1/2 = 7199816			
								17287819			

面積計算書

区 3
 ブロック 141
 計算者
 精算者
 備考

点	① X	② X _n - (定数) -154.300.000	③ X _{n+1} - X _n	④ Y	⑤ Y _n - (定数) -34.800.000	⑥ Y _{n+1} - Y _n	⑦ +	⑧ -	⑨ +	⑩ -	
592-2	22 -154 382 771	- 82.771	+ 9.679	-34 909 024	- 109.024	+ 5.466		1055.2432		451.5158	
	23 -154 390 237	- 90.237	+ 6.591	-34 908 355	- 108.355	- 7.796		714.1678	883.9616		
	24 -154 389 362	- 89.362	- 9.966	-34 899 228	- 99.228	- 8.243	987.9139		736.6109		
	25 -154 380 281	- 80.281	- 8.804	-34 900 112	- 100.112	+ 3.672	881.3860		294.7918		
	26 -154 380 558	- 80.558	+ 2.490	-34 902 900	- 102.900	+ 8.912		266.2210	717.9228		
								1869.2999	3025.3320	1620.5725	1464.2409
								156.3321	156.3321	78.1660	156.3321
4	-154 384 154	- 84.154	+ 64.639	-34 912 851	- 112.851	0.087		7294.5757	7.3213	23.6452	
5	-154 427 410	- 147.410	+ 49.503	-34 908 937	- 108.937	95.267		4446.0000	14.043.7084		
21	-154 433 657	- 133.657	+ 88.031	817.584	17.584	64.642		5409.567	2794.5779		
20	-154 359 379	- 67.379	+ 53.257	844.295	24.295	85.316		5392.7083	8.637.8557		
26	-154 380 558	- 80.558	+ 20.902	-34 902 900	- 102.900	85.817		2.150.8158	4476.5058		
25	-154 380 281	- 80.281	+ 8.804	-34 900 112	- 100.112	- 3.672		881.3860	294.7918		
24	-154 389 362	- 89.362	+ 9.966	-34 899 228	- 99.228	+ 8.243		987.9139	736.6109		
23	-154 390 237	- 90.237	- 6.591	-34 908 355	- 108.355	+ 7.796		714.1678	883.9616		
22	-154 382 771	- 82.771	- 6.083	-34 909 024	- 109.024	+ 4.496		663.1929	372.1384		
								5277.3180	16907.3997	22.986.2772	11.555.1954
								11.430.0817	11.430.0817	11.430.0817	11.430.0817

面積計算書

区

3

ブロック

141

計算者



精算者

備考

	①	②	③	④	⑤	⑥	③ × ⑤	② × ⑥	
	X	X - (定数)	X _{n1} - X _{n1}	Y	Y - (定数)	Y _{n1} - Y _{n1}	+	-	
590-11 590-8		-154 300 000	13 862 12 862		-300 000				
9'	-154 354 256	-54 256	13 862 12 862	-34 844 887	-41 887	-17.764	580.6375	963.8035	
10'	-154 347 669	-47 669	7.789	-34 844 255	-44 255	+ 4.926	344.7021	234.8194	
11'	-154 346 467	-46 467	5.379	-34 846 813	-46 813	+ 20.826	252.7433	967.2217	
12'	-154 353 068	-53 068	15.064	-34 865 081	-65 081	+ 15.261	980.3801	806.9529	
19'	-154 346 557 361 531	-46 557 61 531	1.188	-34 846 575 862 019	-44 575 62 019	- 23.194	73.6785	1422.1500	
							925.3396	1733.1254 2390.9525	2009.4911
							381.4623	1306.8019	381.4624
							$\frac{1}{2} = 190.7312$	57.6761	
水路 (通路)		-154 300 000	26 778	-34 841 548	-41 548	- 71.157	1112.5723	3927.6529	
8'	-154 355 197	-55 197	24 777 26 778	-34 841 548	-41 548	- 71.157	1112.5723		
9'	-154 354 256	-54 256	24 777 26 778	-34 841 887	-41 887	+ 71.589	1038.6719	3822.5593	
2'	-154 379 994	-79 994	26 778	-34 913 108	-113 108	+ 71.157	3028.8060	5692.1730	
3'	-154 381 034	-81 034	24.777	-34 913 044	-113 044	- 71.589	2803.1520	5798.7930	
							3915.7243	7877.8 9574.6923	
							4067.4779	7877.8 9574.6923	
							$\frac{1}{2} = 71.8768$	151.7536	
							151.7536	22.9529	151.7536

面積計算書

区 3 ブロック 141 計算者 精算者 備考

保195-1

①	②	③	④	⑤	⑥	③	×	⑤	②	×	⑥
X	X - (定数)	$X_{n-1} - X_n$	Y	Y - (定数)	$Y_{n-1} - Y_n$	+		-	+		-
✓ 13 -154 357 657	154 300 000 - 57 657	3.875 3.875	-34 277 781	34 800 000 - 77 781	+ 15.760	301.4013		81.0700			908.6743
✓ 14 -154 362 240	- 62 240	13.053	-34 290 479	- 90 479	+ 9.636	125.9989		1181.0223	399 2024 5631.9058		599.8024
✓ 17 -154 370 710	- 70 710	3.875	-34 287 417	- 87 417	- 15.760			338.7408	1114 3896 181 236		
✓ 18 -154 366 121	- 66 121	13.053	-34 274 719	- 74 719	- 9.636	973.3071			637.1419		627 1419
						1276.7084		1519.7631	1114 1930 1181 2418 1751.5315		1508.4767
						243.0547		$\frac{1}{2} = 121.5274$	76.76204		243.0548

保195-2

✓ 12 -154 353 068	154 300 000 - 53 068	3.874 3.874	-34 265 081	34 800 000 - 65 081	+ 15.762	252.1237					836.4578
✓ 13 -154 357 657	- 57 657	13.053	-34 277 781	- 77 781	+ 9.638			1015.2753	553 6981		553.6981
✓ 18 -154 366 121	- 66 121	3.274	-34 274 719	- 74 719	- 15.762			289.4614	1042.1992		
✓ 19 -154 361 531	- 61 531	13.053	-34 262 019	- 62 019	- 9.638	809.5340			110 781		593.0357
						148 6047 1061.6577		1304.7367	1635.2249		1392.1559
						243.0790		$\frac{1}{2} = 121.5395$	36.7657		243.079

面積計算書

正区

ブロック

141

計算者

精算者

備考

点	① X	② X - (定数)	③ X _{n-1} - X _n	④ Y	⑤ Y - (定数)	⑥ Y _{n-1} - Y _n	⑦ +	⑧ ×	⑨ -	⑩ +	⑪ ×	⑫ -
前切面積		-144.300.000			74.700.000							
I.	-154 370 633	- 70.633	+ 2.676	-34 913 600	- 113.600	+ 1.757			304.2291			124.1022
1.	-154 372 629	- 70.629	- 0.680	-34 913 560	- 113.560	- 1.881	77.2235			136.6151		
15.	-154 369 953	- 69.953	- 1.991	-34 911 807	- 111.807	+ 0.124	223.1668					8.6742
							300.3903					132.7764
							3.8388		$\frac{1}{2} = 1.9194$			3.3387
									0.58061			
II.	-154 450 415	- 150.415	+ 1.688	-34 908 751	- 108.751	- 2.102			184.6592			316.1723
7.	-154 450 117	- 150.117	- 1.996	-34 906 997	- 108.777	- 0.124	275.7198					18.6145
6.	-154 448 419	- 148.419	+ 0.598	-34 908 875	- 108.875	+ 1.978			32.6447			292.5728
									217.1060			312.1873
							3.9851		$\frac{1}{2} = \frac{m^2}{271}$			3.5950
V.	-154 345 787	- 45.787	- 1.202	-34 844 932	- 44.932	2.558	46.0083					117.1231
11.	-154 346 467	- 46.467	+ 1.992	-34 846 813	- 46.813	- 0.677			88.1021			21.4581
10.	-154 347 669	- 47.669	- 0.680	-34 844 255	- 44.255	- 1.581	30.0934					89.6654
							54.1017					121.1235
							4.0004		$\frac{1}{2} = 2.0002$			4.0004

0.6050