

画地略图

街区番号

27

備考

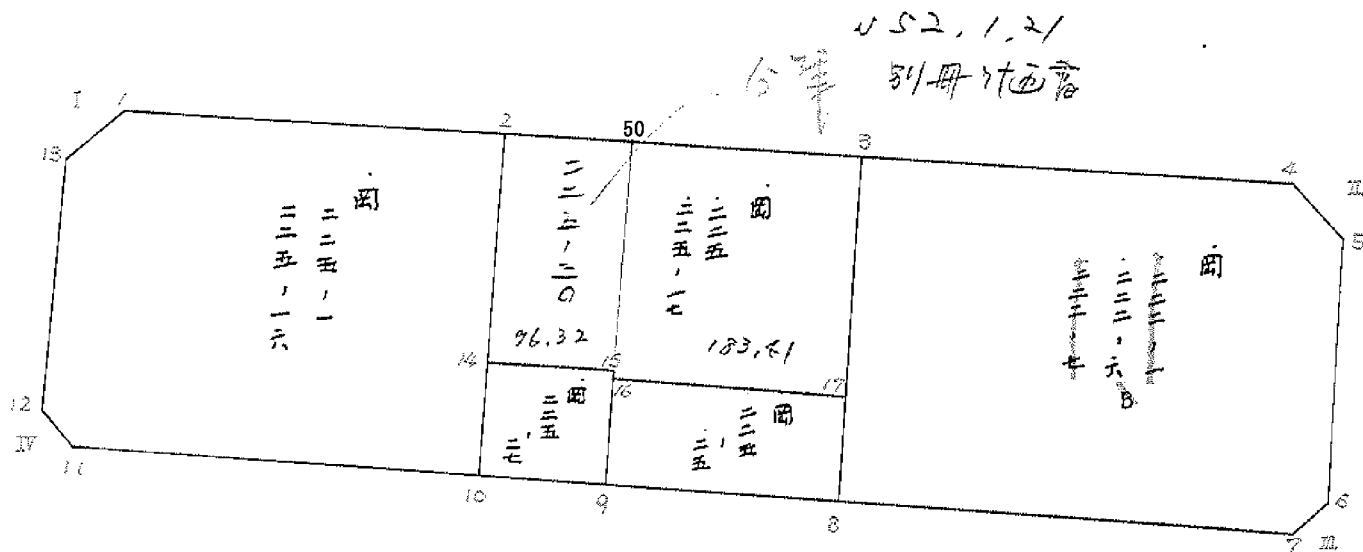

記入者

点検者



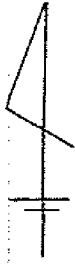

	2	50	3
		二二五 一三〇 <hr/> 96.32	二二五 一三七 二二五 一三七 二二五 一三七 <hr/> 183.41 <hr/> 279.73
14		15	
		16	17

二二五
一三七
二二五
一三七
二二五
一三七

座標法面積計算 (DESCRIPTION OF APPLICATION)

(6-27 BLOCK) 1

測点 STA.NO	X (1)	Δx (2)	Y (3)	Δy (4)	(2) × (3)	(1) × (4)
交, I	-149680.397✓	13.272	-37637.005✓	74.903	-499518.330360	-11211510.776491
交, II	-149686.576✓	-26.243	-37564.263✓	71.233	985798.953909	-10662623.868208
交, III	-149706.640✓	-13.272	-37565.772✓	-74.903	498572.925984	11213476.455920
交, IV	-149699.848✓	26.243	-37639.166✓	-71.233	-987764.633338	10663569.272584
					-2911.083805	2911.083805
					-1455.541902	1455.541902

岡山調査測量株式会社



座標法面積計算 (DESCRIPTION OF APPLICATION)

隅切

(6-27 BLOCK) 2

測点 STA.NO	X (1)	Δx (2)	Y (3)	Δy (4)	(2) × (3)	(1) × (4)
交, 1	-149680.397 ✓	2.727	-37637.005 ✓	3.320	-102636.112635	-496938.918040
1	-149680.651 ✓	-2.981	-37634.016 ✓	-.331	112187.001696	49544.295481
13	-149683.378 ✓	.254	-37637.336 ✓	-2.989	-9559.883344	447403.616842
					-8.994283	8.994283
					-4.497141	4.497141

岡山調査測量株式会社

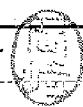

座標法面積計算 (DESCRIPTION OF APPLICATION)

隅切

(6-27 BLOCK)

3

測点 STA.NO	X (1)	Δx (2)	Y (3)	Δy (4)	(2) × (3)	(1) × (4)
4	-149686.322 ✓	2.992	-37567.252 ✓	.225	-112401.217984	-33679.422450
交Ⅱ	-149686.576 ✓	-3.246	-37564.263 ✓	2.764	121933.597698	-413733.696064
5	-149689.568 ✓	.254	-37564.488 ✓	-2.989	-9541.379952	447422.118752
					-9.000238	9.000238
					-4.500119	4.500119

岡山調査測量株式会社



座標法面積計算 (DESCRIPTION OF APPLICATION)

隅切

(6-27 BLOCK)

4

測点 STA.NO	X (1)	Δx (2)	Y (3)	Δy (4)	(2) × (3)	(1) × (4)
6	-149704.646 ✓	-.184	-37565.622 ✓	1.991	6912.074448	-298061.950186
交, Ⅱ	-149706.640 ✓	-1.810	-37565.772 ✓	-2.141	67994.047320	320521.916240
7	-149706.456 ✓	1.994	-37567.763 ✓	.150	-74910.119422	-22455.968400
					-3.997654	3.997654
					-1.998827	1.998827

岡山調査測量株式会社

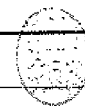

座標法面積計算 (DESCRIPTION OF APPLICATION)

隅切 (6-27 BLOCK) 5

測点 STA.NO	X (1)	Δx (2)	Y (3)	Δy (4)	(2) \times (3)	(1) \times (4)
11	-149700.032 ✓	-1.988	-37637.175 ✓	-.221	74822.703900	33083.707072
交, IV	-149699.848 ✓	2.172	-37639.166 ✓	-1.770	-81752.268552	264968.730960
12	-149697.860 ✓	-.184	-37638.945 ✓	1.991	6925.565880	-298048.439260
					-3.998772	3.998772
					-1.999386	1.999386

岡山調査測量株式会社

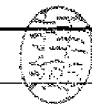

座標法面積計算 (DESCRIPTION OF APPLICATION) 岡 225-1 (6-27 BLOCK) 6

測点 STA.NO	X (1)	Δx (2)	Y (3)	Δy (4)	(2) \times (3)	(1) \times (4)
1	-149680.651 ✓	.884	-37634.016 ✓	25.019	-33268.470144	-3744860.207369
2	-149682.494 ✓	-21.524	-37612.317 ✓	19.995	809567.511108	-2992901.467530
10	-149702.175 ✓	-17.538	-37614.021 ✓	-24.858	659674.700298	3721296.666150
11	-149700.032 ✓	4.315	-37637.175 ✓	-24.924	-162404.410125	3731123.597568
12	-149697.860 ✓	16.654	-37638.945 ✓	-.161	-626838.990030	24101.355460
13	-149683.378 ✓	17.209	-37637.336 ✓	4.929	-647700.915224	-737789.370162
					-970.574117	970.574117
					-485.287058	485.287058

岡山調査測量株式会社

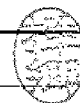

座標法面積計算 (DESCRIPTION OF APPLICATION) 岡 225-27 (6-27 BLOCK) 8

測点 STA.NO	X (1)	Δx (2)	Y (3)	Δy (4)	(2) × (3)	(1) × (4)
14	-149695.681 ✓	5.903	-37613.459 ✓	7.835	-222032.248477	-1172865.660635
15	-149696.272 ✓	-7.164	-37606.186 ✓	6.678	269410.716504	-999671.704416
9	-149702.845 ✓	-5.903	-37606.781 ✓	-7.835	221992.828243	1172921.790575
10	-149702.175 ✓	7.164	-37614.021 ✓	-6.678	-269466.846444	999711.124650
					-95.550174	95.550174
					-47.775087	47.775087

岡山調査測量株式会社



座標法面積計算 (DESCRIPTION OF APPLICATION) 岡 225-25 (6-27 BLOCK) 9

測点 STA.NO	X (1)	Δx (2)	Y (3)	Δy (4)	(2) × (3)	(1) × (4)
17	-149698.033 ✓	-7.293	-37592.989 ✓	12.724	274165.668777	-1904757.771892
8	-149704.073 ✓	-4.812	-37593.508 ✓	-13.792	180899.960496	2064718.574816
9	-149702.845 ✓	7.293	-37606.781 ✓	-12.724	-274266.253833	1904818.999780
16	-149696.780 ✓	4.812	-37606.232 ✓	13.792	-180961.188384	-2064617.989760
					-161.812944	161.812944
					-80.906472	80.906472 ✓

岡山調査測量株式会社



座標法面積計算 (DESCRIPTION OF APPLICATION) 図 ~~222-7~~ (~~222-6~~ 6-27 BLOCK) 10

測点 STA.NO	X (1)	Δx (2)	Y (3)	Δy (4)	(2) × (3)	(1) × (4)
3	-149684.237 ✓	17.751	-37591.804 ✓	26.256	-667292.112804	-3930109.326672
4	-149686.322 ✓	-5.331	-37567.252 ✓	27.316	200271.020412	-4088831.571752
5	-149689.568 ✓	-18.324	-37564.488 ✓	1.630	688331.678112	-243993.995840
6	-149704.646 ✓	-16.888	-37565.622 ✓	-3.275	634408.224336	490282.715650
7	-149706.456 ✓	.573	-37567.763 ✓	-27.886	-21526.328199	4174714.232016
8	-149704.073 ✓	22.219	-37593.508 ✓	-24.041	-835290.154252	3599035.618993
					-1097.672395	1097.672395
					-548.836197	548.836197

岡山調査測量株式会社

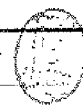

座標法面積計算 (DESCRIPTION OF APPLICATION) 圖 225- (6-27 BLOCK) 225-17-

測点 STA.NO	X (1)	Δx (2)	Y (3)	Δy (4)	(2) × (3)	(1) × (4)
2	-149682.494 ✓	11.444	-37612.317 ✓	21.655	-430435.355748	-3241374.407570
3	-149684.237 ✓	-15.539	-37591.804 ✓	19.328	584139.042356	-2893096.932736
17	-149698.033 ✓	-12.543	-37592.989 ✓	-14.428	471528.861027	2159843.220124
16	-149696.780 ✓	1.761	-37606.232 ✓	-13.197	-66224.574552	1975548.405660
15	-149696.272 ✓	1.099	-37606.186 ✓	-7.227	-41329.198414	1081854.957744
14	-149695.681 ✓	13.778	-37613.459 ✓	-6.131	-518238.238102	917784.220211
					-559.463433	559.463433
					-279.731716	279.731716 ✓

合算
50.02
別紙計算

岡山調査測量株式会社

面積計算書

工区

6

ブロック

27

計算者

精算者

備考

225-30
225-17
225

点	①	②	③	④	⑤	⑥	③ × ⑤		② × ⑥	
	X	X-(定数)	X _{n-1} -X _{n+1}	Y	Y-(定数)	Y _{n-1} -Y _{n+1}	+	-	+	-
2	-149 682.494	-149.680 2.494	-12.572	-37 612.317	-37.600 12.317	-8.388	154.849324			20.919672
50	683.109	3.109	+13.778	605.071	5.071	-6.131		69.868238		19.061279
15	696.272	16.272	+12.572	606.186	6.186	+8.388		77.770392		136.429536
14	695.681	15.681	-13.778	613.459	13.459	+6.131	185.438102			96140211
							340.227426	167.638630	39.980951	232.629747
							192.648796			192.648796
										1/2 = 96.324398
50	-149 683.109	-149.680 3.109	-12.035	-37 605.071	-37.590 15.071	-14.382	181.379485			44.713638
3	684.237	4.237	+14.924	591.804	1.804	-12.082		26.922896		51.191434
17	698.033	18.033	+12.543	592.989	2.989	+14.428		37.491027		260.180124
16	696.780	16.780	-1.761	606.232	16.232	+13.197	28.584552			221.445660
15	696.272	16.272	-13.671	606.186	16.186	-1161	221.278806			18.891792
							431.242843	64.413923	114.796864	481.625784
							366.828920			366.828920
										1/2 = 183.414460
										279.73 - 183.41 = 96.32