

画地計算

画地略図

工区

ブロック

21

記入者

点検者

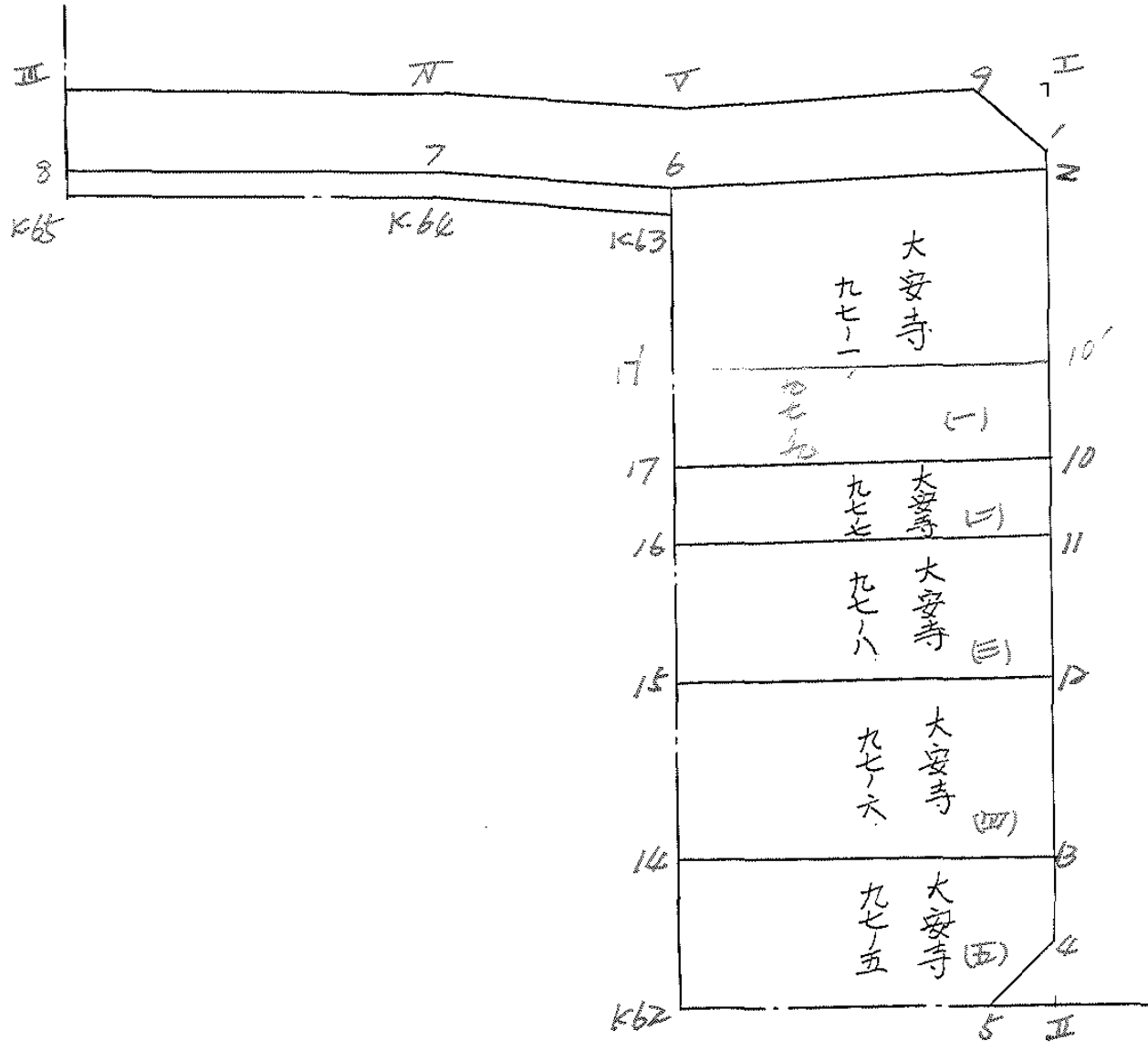

BND. ZI 分割計算

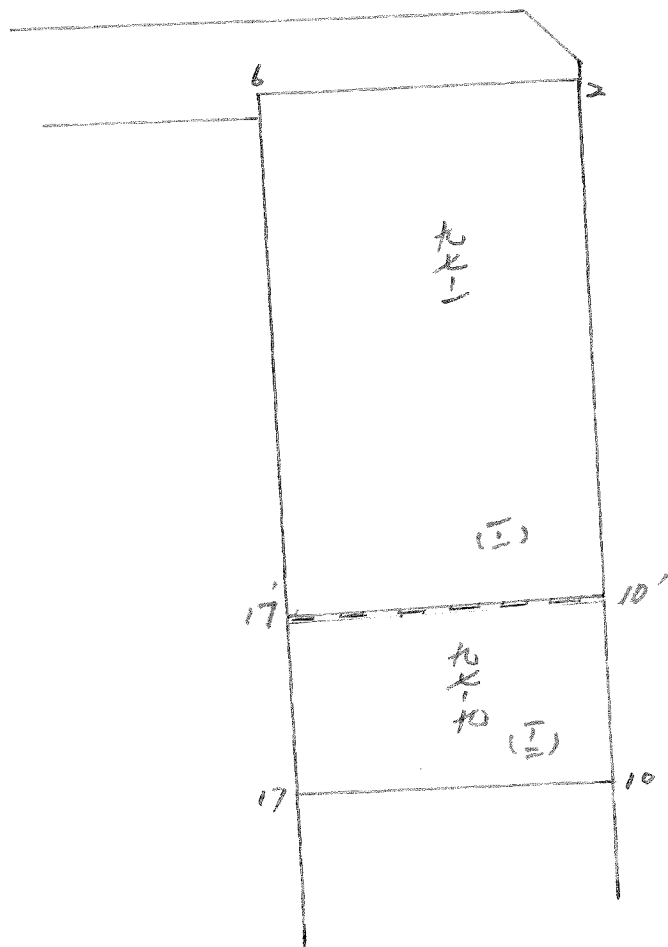

面積計算書

工区

ブロック

2/

計算者

精算者

備考

(イ) 大建97-1
(ロ) " 97-7

点	①	②	③	④	⑤	⑥	③ × ⑤		② × ⑥		
	X	X-(定数)	X _{n-1} -X _{n+1}	Y	Y-(定数)	Y _{n-1} -Y _{n+1}	+	-	+	-	
2	602.210	-148.640	2.210 + 50.640	171.558	11.558	-16.601			585.297120	36.688210	
10	694.1144	54.444 + 53.005	167.904	7.904	+ 9.326			418.951520		507.744744	
17	695.215	55.215 - 50.640	180.984	20.884	+ 16.601			1057.565760		916.624215	
6	643.804	3.804 - 53.005	184.505	24.505	- 9.326			1298.887525		35.476104	
								2356.453285	1004.248640	72.164314	1424.368959
								1352.204645			1352.204645
								X _{1/2} = 676.1023225			
10	694.444	-148.690	4.444 + 4.367	167.904	7.904	- 13.340			34.516768	59.282960	
11	699.582	9.582 + 5.909	167.544	7.544	+ 12.618			44.577496		120.905676	
16	700.353	10.353 - 4.367	180.522	20.522	+ 13.340			89.619574		138.109020	
17	695.215	5.215 - 5.909	180.984	20.884	- 12.618			123.403556		65.802870	
								213.023130	79.094264	125.085830	259.014696
								133.928866			133.928866
								X _{1/2} = 66.984433			

面積計算書

工
区

ブ
ロ
ック

2/

計
算
者

精
算
者

備
考

(1-1) 97-1
(1-2) 97-9

点	①	②	③	④	⑤	⑥	③ × ⑤		② × ⑥		
	X	X-(定数)	X _{n-1} -X _{n+1}	Y	Y-(定数)	Y _{n-1} -Y _{n+1}	+	-	+	-	
2	-168. 662.210	-168.660- 2.210	+ 40.465	-40. 171.558	-40.160- 11.558	- 15.889			467.694470	35.114690	
10'	684.269	44.269	+ 42.930	168.616	8.616	+ 10.043			369.023280		444.593567
17'	685.040	45.040	- 40.465	181.601	21.601	+ 15.889	874.084465				715.640560
6	663.804	3.804	- 42.930	184.505	26.505	- 10.043	1049.549150			38.203572	
							1923.633615	836.717750	73.318262	1160.234127	
							1086.915865				1086.915865
							1086.915865	$\times \frac{1}{2} = 543.457932$			
10'	-168. 684.269	-168.684- 0.269	+ 9.604	-40. 168.616	-40.160- 8.616	- 13.697			81.024864	3.684493	
10	694.644	10.644	+ 10.946	167.904	7.904	+ 12.268			86.517184		128.126992
17	695.215	11.215	- 9.604	180.884	20.884	+ 13.697	196.393136				153.611855
17'	685.040	1.040	- 10.946	181.601	21.601	- 12.268	236.444546			12.758720	
							432.837682	167.542048	16.443213	281.738847	
							265.295634				265.295634
							265.295634	$\times \frac{1}{2} = 132.647817$			

676.10 - 543.465 = 132.635 97-9

面積計算書

工区

ブロック

21

計算者

精算者

備考

E1 大橋 97-8
④ " 97-6

点	①	②	③	④	⑤	⑥	③ × ⑤		② × ⑥	
	X	X-(定数)	X _{n-1} -X _{n+1}	Y	Y-(定数)	Y _{n-1} -Y _{n+1}	+	-	+	-
(E1) 11	^{-108,} 699.592	^{-148,690} 9.582	+ 9.404	^{-40,} 167.544	^{-40,160} 7.544	- 13.690			70.943776	131.177580
12	709.757	19.757	+ 10.945	166.832	6.832	+ 12.261			74.77624	242.240577
15	710.527	20.527	- 9.404	179.905	19.805	+ 13.690	186.246220			281.014630
16	700.353	10.353	- 10.945	180.522	20.522	- 12.261	224.613290		126.938133	
							440.859510	145.720016	258.115713	523.255207
							265.139494			265.139494
									X/2 = 132.569747	
(E1) 12	^{-108,} 789.757	^{-148,700} 9.757	+ 19.629	^{-40,} 166.832	^{-40,160} 6.832	- 14.400			134.105328	140.500800
13	730.156	30.156	+ 21.171	165.405	5.405	+ 11.536			114.429255	347.879616
14	730.928	30.928	- 19.629	178.368	18.368	+ 14.400	360.545472			445.363200
15	710.527	10.527	- 21.171	179.905	19.805	- 11.536	419.291655		121.439472	
							779.837127	248.534583	261.940272	793.242816
							531.302544			531.302544
									X/2 = 265.651272	

面積計算書

工区

ブロック

計算者

計算者

備考

E) 大塚 97-5

点	①	②	③	④	⑤	⑥	③ × ⑤		② × ⑥			
	X	X-(定数)	X _{n-1} -X _{n+1}	Y	Y-(定数)	Y _{n-1} -Y _{n+1}	+	-	+	-		
(五) 13	-103. 730.156	-148,730 0.156	+ 10.101	-100. 165.405	-40,160 5.405	- 13.724			54.575905	2.140944		
4	741.029	11.029	+ 12.928	164.644	4.644	+ 1.076			60.316272		12.087784	
5	743.144	13.144	+ 2.768	166.501	6.501	+ 12.818			17.994768		168.479792	
K-62	743.797	13.797	- 12.216	177.462	17.462	+ 11.867			213.315792		163.728999	
14	730.928	0.928	- 13.641	178.368	18.368	- 12.057			250.557888		11.188896	
									463.873680	122.906945	12.329840	344.296575
									330.966735			220.966735
												72 = 165.4833675

面積計算書

工
区

フ
ロ
ック

Z1

計
算
者



精
算
者

(M)

備
考

陽切 I.
" II.

点	①	②	③	④	⑤	⑥	③ × ⑤		② × ⑥		
	X	X-(定数)	X _{n-1} -X _{n+1}	Y	Y-(定数)	Y _{n-1} -Y _{n+1}	+	-	+	-	
I	-148. 639.720	-148.630.0 9.720	+ 1.751	-40. 171.732	-40.170.0 1.732	- 2.125			3.032.732	20.655.000	
1	641.715	11.715	+ 0.244	171.592	1.592	+ 1.985			0.388.448		23.254.275
9	639.964	9.964	- 1.895	173.717	3.717	+ 0.140	7.415.415				1.394.960
							7.415.415	3.421.180	20.655.000	24.649.235	
							3.994.235				3.994.235
											1/2 = 1.997.1175
4	-148. 741.029	-148.740.0 1.029	- 0.119	-40. 164.644	-40.160.0 4.644	- 1.996	0.552.636			2.053.884	
II	743.025	3.025	+ 2.115	164.505	4.505	+ 1.857			9.528.075		5.617.425
5	743.144	3.144	- 1.996	166.501	6.501	+ 0.139	12.975.996				0.437.016
							13.528.632	9.528.075	2.053.884	6.054.441	
							4.000.557				4.000.557
											1/2 = 2.000.2785

面積計算書

工区

ブロック

4

計算者

計算者

備考

水路2号線 2.5M~3M

点	①	②	③	④	⑤	⑥	③ × ⑤		② × ⑥	
	X	X-(定数)	X _{n-1} -X _{n+1}	Y	Y-(定数)	Y _{n-1} -Y _{n+1}	+	-	+	-
9	^{-148,} 639.964	^{-148,130} 8.964	+ 0.401	^{-40,} 173.717	^{-40,170} 3.717	- 13.088		1.490517	130.408832	
1	641.715	11.715	+ 2.246	171.592	1.592	- 2.159		3.575632	25.292685	
2	642.210	12.210	+ 3.089	171.558	1.558	+ 12.913		3.254662		157.667730
6	643.904	13.804	+ 2.119	184.505	14.605	+ 12.910		30.726095		192.209620
K63	644.329	14.329	- 0.072	184.458	14.468	+ 11.837	1.041696			189.612373
K64	643.732	13.732	- 0.117	196.342	28.342	+ 38.241	3.082016			525.125412
K65	644.212	14.212	- 2.518	222.709	52.709	+ 26.483	132.721262			376.376396
II	641.214	11.214	- 3.477	222.925	52.925	- 26.210	182.672525			293.918940
IV	640.735	10.735	+ 0.100	196.499	26.499	- 38.145		2.629900		409.486575
V	641.314	11.314	- 0.771	184.680	14.680	- 22.782	11.318280			257.765548
							331.835777	44.706806	1116.862586	1426.991551
							290.178971			290.178971
										72 = 145.0644855
										≒ 145.06

計年 月 算日	計 算 者		檢 查 者
---------------	-------------	---	-------------

B. NO. 21

各筆面積計算書

地番	算式	間切	地積	摘要
1	大安寺 97-1		676 10	97-1 543.45 97-9 132.65
2	" 97-7		66 96	
3	" 97-8		132 56	
4	" 97-6		265 65	
5	" 97-5		165 48	
		合計	1,306 75	宅地 5筆
		全体	1,306 77	
		差	-002	
	水路2号線 2.5M~3M		145 ^{m²} 06	