

1 BL

H 4, 11.30

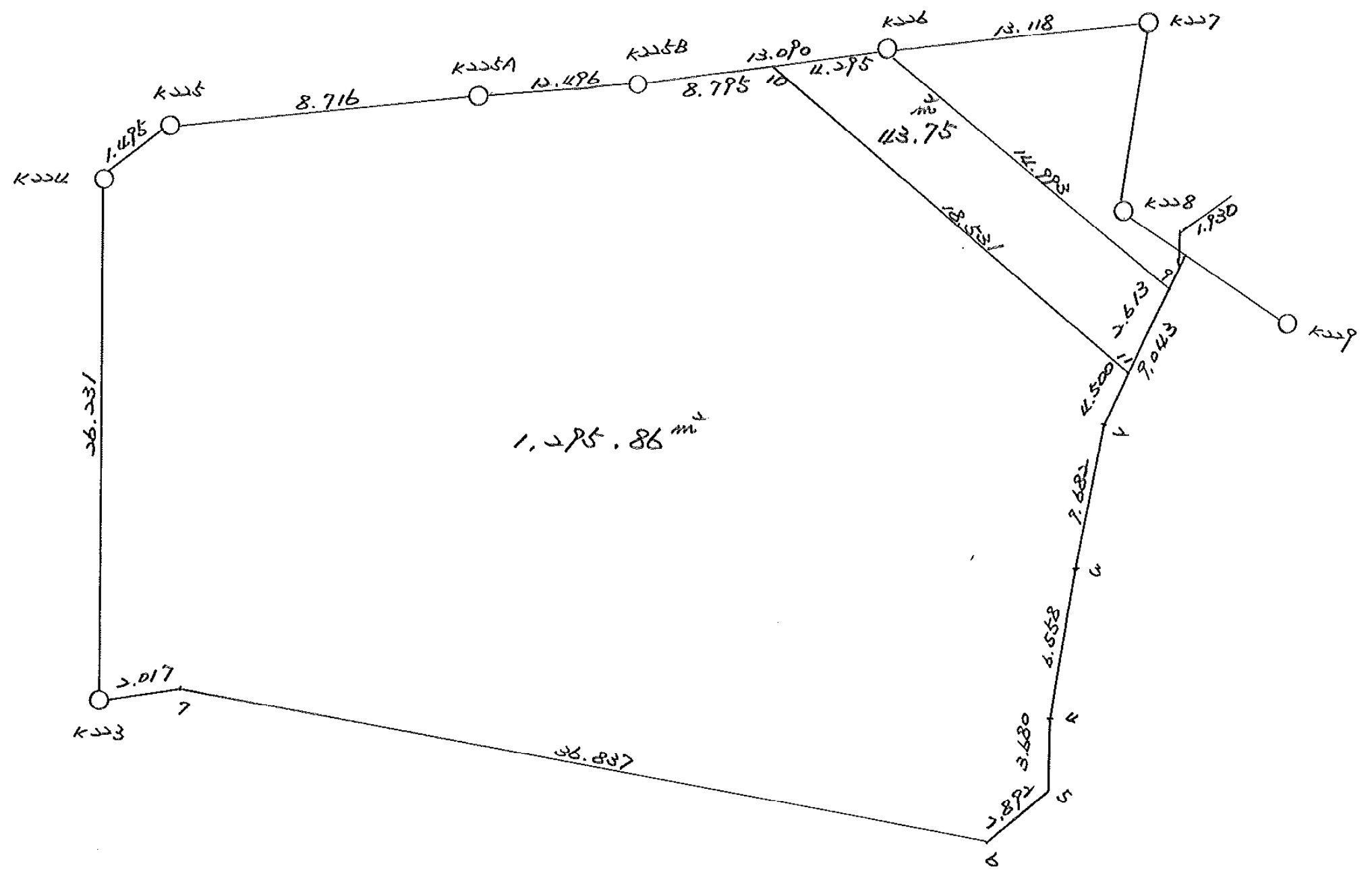

\* \* \* \* 2-1 LOT

面積計算書

\* \* \* \* NO 1

点名	X	DX	DMD.1	Y	DY	DMD.2	DX * DMD.2	DY * DMD.1
1-11	- 149253.263			- 39376.411				
1-2	- 149257.274	+ 4.011	+ 4.011	- 39378.451	+ 2.040	+ 2.040	+ 8.182440	+ 8.182440
1-3	- 149266.627	+ 9.353	+ 17.375	- 39380.952	+ 2.501	+ 6.581	+ 61.552093	+ 43.454875
1-4	- 149273.004	+ 6.377	+ 33.105	- 39382.484	+ 1.532	+ 10.614	+ 67.685478	+ 50.716860
1-5	- 149276.620	+ 3.616	+ 43.098	- 39383.167	+ 0.683	+ 12.829	+ 46.389664	+ 29.435934
1-6	- 149278.362	+ 1.742	+ 48.456	- 39385.475	+ 2.308	+ 15.820	+ 27.558440	+ 111.836448
1-7	- 149274.471	- 3.891	+ 46.307	- 39422.106	+ 36.631	+ 54.759	- 213.067269	+ 1696.271717
K223	- 149275.178	+ 0.707	+ 43.123	- 39423.995	+ 1.889	+ 93.279	+ 65.948253	+ 81.459347
K224	- 149248.957	- 26.221	+ 17.609	- 39423.262	- 0.733	+ 94.435	- 2476.180135	- 12.907397
K225	- 149247.858	- 1.099	- 9.711	- 39422.249	- 1.013	+ 92.689	- 101.865211	+ 9.837243
K225A	- 149247.124	- 0.734	- 11.544	- 39413.564	- 8.685	+ 82.991	- 60.915394	+ 100.259640
K225B	- 149245.234	- 1.890	- 14.168	- 39401.212	- 12.352	+ 61.954	- 117.093060	+ 175.003136
1-10	- 149244.062	- 1.172	- 17.230	- 39392.496	- 8.716	+ 40.886	- 47.918392	+ 150.176680
1-11	- 149253.263	+ 9.201	- 9.201	- 39376.411	- 16.085	+ 16.085	+ 147.998085	+ 147.998085
		+ 35.007			+ 47.584		+ 425.314453	+ 2604.632405
		- 35.007			- 47.584		- 3017.039461	- 12.907397
							- 2591.725008	+ 2591.725008
						面積 =	1295.862504	

\* \* \* \* 2-2 LOT

面積計算書

\* \* \* \* NO 1

点名	X	DX	DMD.1	Y	DY	DMD.2	DX * DMD.2	DY * DMD.1
1-9	- 149250.934			- 39375.225				
1-11	- 149253.263	+ 2.329	+ 2.329	- 39376.411	+ 1.186	+ 1.186	+ 2.762194	+ 2.762194
1-10	- 149244.062	- 9.201	- 4.543	- 39392.496	+ 16.085	+ 18.457	- 169.822857	- 73.074155
K226	- 149243.490	- 0.572	- 14.316	- 39388.239	- 4.257	+ 30.285	+ 17.323020	+ 60.943212
1-9	- 149250.934	+ 7.444	- 7.444	- 39375.225	- 13.014	+ 13.014	+ 96.876216	+ 96.876216
		+ 9.773			+ 17.271		+ 99.638410	+ 160.581622
		- 9.773			- 17.271		- 187.145877	- 73.074155
							- 87.507467	+ 87.507467
						面積 =	43.753733	

\* \* \* 各筆面積 集計表 \* \* \*

街区名・筆名	各筆面積	隅切面積
1 BLOCK	1394.21	
1 LOT	54.60	
2 LOT	1339.61	
合計 =	1394.21	0.00

\* \* \* \* \* 各 筆 面 積 計 算 書 \* \* \* \* \*

1 BLOCK

点 名	X	Y	(X-X0)*(YN-1-Y0)	(XN-1-X0)*(Y-Y0)
X0·Y0	- 149200.000	- 39300.000		
K223	- 149275.178	- 39423.995		
K224	- 149248.957	- 39423.262	+ 6070.423215	+ 9266.590636
K225	- 149247.858	- 39422.249	+ 5899.072796	+ 5984.944293
K225A	- 149247.124	- 39413.564	+ 5760.861876	+ 5434.945912
K225B	- 149245.234	- 39401.212	+ 5136.953976	+ 4769.514288
K226	- 149243.490	- 39388.239	+ 4401.709880	+ 3991.402926
K227	- 149242.301	- 39375.175	+ 3732.597939	+ 3269.360750
K228	- 149247.812	- 39376.107	+ 3594.267100	+ 3219.402207
1-1	- 149249.214	- 39374.350	+ 3745.529898	+ 3554.822200
1-2	- 149257.274	- 39378.451	+ 4258.321900	+ 3860.887514
1-3	- 149266.627	- 39380.952	+ 5226.954777	+ 4636.444848
1-4	- 149273.004	- 39382.484	+ 5909.819808	+ 5495.661468
1-5	- 149276.620	- 39383.167	+ 6319.924080	+ 6071.523668
1-6	- 149278.362	- 39385.475	+ 6517.132454	+ 6549.094500
1-7	- 149274.471	- 39422.106	+ 6365.408725	+ 9568.470372
K223	- 149275.178	- 39423.995	+ 9179.684868	+ 9234.031645
			+ 82118.663292	+ 84907.097227
		倍面積	= 2788.433935	
		面積	= 1394.216967	

1 LOT

点 名	X	Y	(X-X0)*(YN-1-Y0)	(XN-1-X0)*(Y-Y0)
X0·Y0	- 149200.000	- 39300.000		
K226	- 149243.490	- 39388.239		
K227	- 149242.301	- 39375.175	+ 3732.597939	+ 3269.360750
K228	- 149247.812	- 39376.107	+ 3594.267100	+ 3219.402207
1-1	- 149249.214	- 39374.350	+ 3745.529898	+ 3554.822200
1-9	- 149250.934	- 39375.225	+ 3786.942900	+ 3702.123150
K226	- 149243.490	- 39388.239	+ 3271.535250	+ 4494.365226
			+ 18130.873087	+ 18240.073533
		倍面積	= 109.200446	
		面積	= 54.600223	

2 LOT

点 名	X	Y	(X-X0)*(YN-1-Y0)	(XN-1-X0)*(Y-Y0)
X0·Y0	- 149200.000	- 39300.000		
1-9	- 149250.934	- 39375.225		
1-2	- 149257.274	- 39378.451	+ 4308.436650	+ 3995.823234
1-3	- 149266.627	- 39380.952	+ 5226.954777	+ 4636.444848
1-4	- 149273.004	- 39382.484	+ 5909.819808	+ 5495.661468
1-5	- 149276.620	- 39383.167	+ 6319.924080	+ 6071.523668

\* \* \* \* \* 各 筆 面 積 計 算 書 \* \* \* \* \*

点 名	X	Y	(X-X0)*(YN-1-Y0)	(XN-1-X0)*(Y-Y0)
1-6	- 149278.362	- 39385.475	+ 6517.132454	+ 6549.094500
1-7	- 149274.471	- 39422.106	+ 6365.408725	+ 9568.470372
K223	- 149275.178	- 39423.995	+ 9179.684868	+ 9234.031645
K224	- 149248.957	- 39423.262	+ 6070.423215	+ 9266.590636
K225	- 149247.858	- 39422.249	+ 5899.072796	+ 5984.944293
K225A	- 149247.124	- 39413.564	+ 5760.861876	+ 5434.945912
K225B	- 149245.234	- 39401.212	+ 5136.953976	+ 4769.514288
K226	- 149243.490	- 39388.239	+ 4401.709880	+ 3991.402926
1-9	- 149250.934	- 39375.225	+ 4494.365226	+ 3271.535250
			+ 75590.748331	+ 78269.983040
		倍面積	= 2679.234709	
		面積	= 1339.617354	