

西部第4地区土地区画整理事業 出来形確認測量（原子図）

38街区

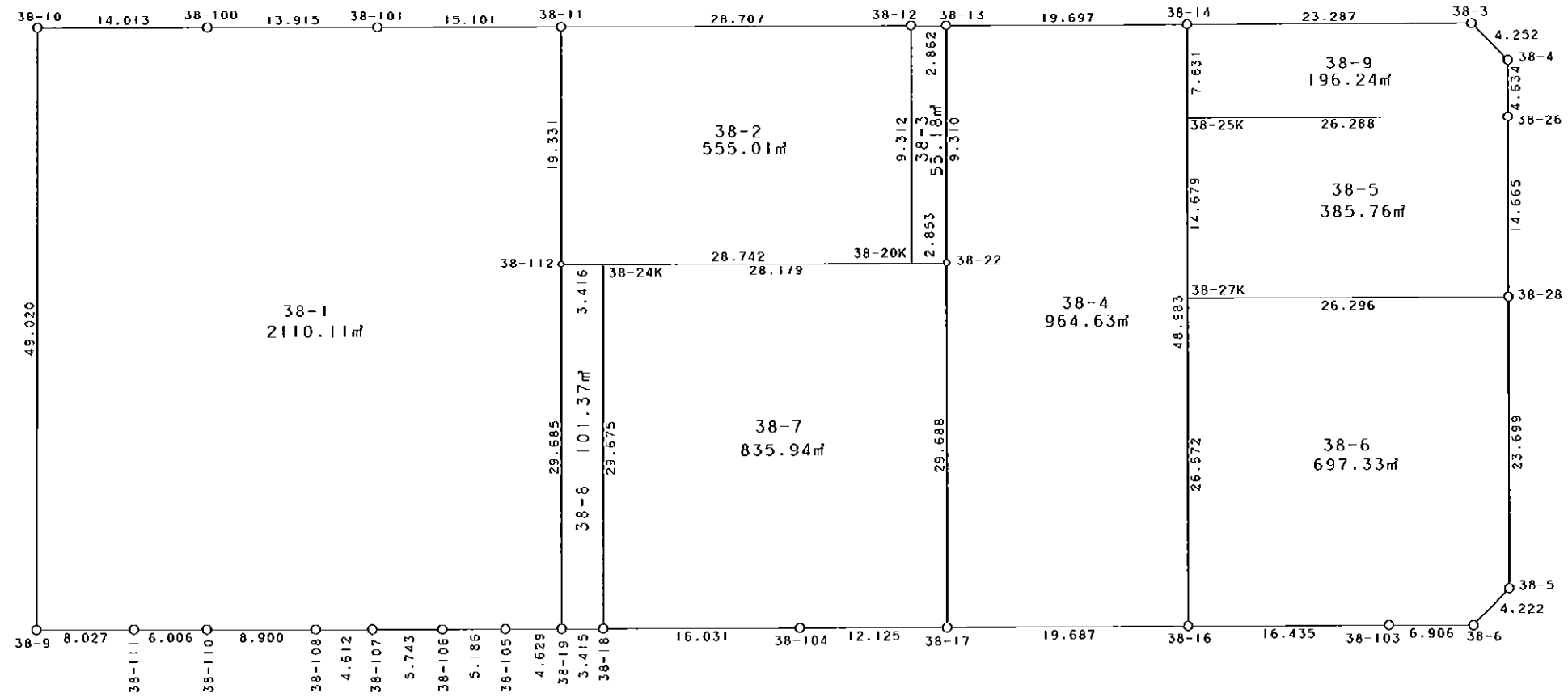

S = 1 / 500



凡 例

記号	名称
⊙	地区界点
○	街区点
○	画地点(折れ点)
┆	画地点(直線中)

面積 (座標法) 計算書

地番 = 38街区

測点名	[1] X (i)	[2] X (i+1)-X (i-1)	[3] Y (i)	[4] Y (i+1)-Y (i-1)	[2] * [3]	[1] * [4]	方向角	夾角	距離
38-10	-149445.646	-49.099	-40595.239	-13.828	1993185.639661	2066534.392888	179-47-02	90-06-25	49.020
38-9	-149494.666	-48.957	-40595.054	8.212	1987412.058678	-1227650.197192	89-33-01	89-45-59	8.027
38-111	-149494.603	0.088	-40587.027	14.033	-3571.658376	-2097857.763899	89-45-41	180-12-40	6.006
38-110	-149494.578	0.070	-40581.021	14.906	-2840.671470	-2228366.179668	89-42-37	179-56-56	8.900
38-108	-149494.533	0.064	-40572.121	13.512	-2596.615744	-2019970.129896	89-45-50	180-03-13	4.612
38-107	-149494.514	0.036	-40567.509	10.355	-1460.430324	-1548015.692470	89-49-49	180-03-59	5.743
38-106	-149494.497	0.058	-40561.766	10.929	-2352.582428	-1633825.357713	89-32-49	179-43-00	5.186
38-105	-149494.456	0.057	-40556.580	9.815	-2311.725060	-1467288.085640	89-48-07	180-15-18	4.629
38-19	-149494.440	0.045	-40551.951	8.044	-1824.837795	-1202533.275360	89-30-48	179-42-41	3.415
38-18	-149494.411	0.119	-40548.536	19.446	-4825.275784	-2907068.316306	89-40-42	180-09-54	16.031
38-104	-149494.321	0.143	-40532.505	28.156	-5796.148215	-4209162.102076	89-44-58	180-04-16	12.125
38-17	-149494.268	0.175	-40520.380	31.812	-7091.066500	-4755711.653616	89-38-42	179-53-44	19.687
38-16	-149494.146	0.217	-40500.693	36.122	-8788.650381	-5400027.541812	89-40-08	180-01-26	16.435
38-103	-149494.051	0.113	-40484.258	23.341	-4574.721154	-3489340.644391	89-51-02	180-10-54	6.906
38-6	-149494.033	3.035	-40477.352	9.859	-122848.763320	-1473861.671347	44-23-09	134-32-07	4.222
38-5	-149491.016	26.716	-40474.399	2.818	-1081314.043684	-421265.683088	359-40-25	135-17-16	23.699
38-28	-149467.317	38.364	-40474.534	-0.218	-1552765.022376	32583.875106	359-40-33	180-00-08	14.665
38-26	-149452.652	19.299	-40474.617	-0.098	-781119.633483	14646.359896	359-48-52	180-08-19	4.634
38-4	-149448.018	7.622	-40474.632	-3.040	-308497.645104	454321.974720	314-38-51	134-49-59	4.252
38-3	-149445.030	2.854	-40477.657	-26.312	-115523.233078	3932197.629360	269-40-13	135-01-22	23.287
38-14	-149445.164	-0.240	-40500.944	-42.984	9720.226560	6423750.929376	269-41-30	180-01-17	19.697
38-13	-149445.270	-0.120	-40520.641	-22.559	4862.476920	3371335.845930	269-43-11	180-01-41	2.862
38-12	-149445.284	-0.155	-40523.503	-31.569	6281.142965	4717838.170596	269-43-07	179-59-56	28.707
38-11	-149445.425	-0.226	-40552.210	-43.808	9164.799460	6546905.178400	269-40-39	179-57-32	15.101
38-101	-149445.510	-0.142	-40567.311	-29.016	5760.558162	4336310.918160	269-45-55	180-05-16	13.915
38-100	-149445.567	-0.136	-40581.226	-27.928	5519.046736	4173715.795176	269-40-37	179-54-42	14.013
合計				倍面積 面積	11803.224866 5901.61	-11803.224866 5901.61			335.776

地番	筆種別	面積	坪数
38-1	筆界	2110.11	638.31
38-2	筆界	555.01	167.89
38-3	筆界	55.18	16.69
38-4	筆界	964.63	291.80
38-5	筆界	385.76	116.69
38-6	筆界	697.33	210.94
38-7	筆界	835.94	252.87
38-8	筆界	101.37	30.66
38-9	筆界	196.24	59.36
	筆合計	5901.57	1785.21

面積 (座標法) 計算書

地番 = 38-1  
測点名

	[1] X (i)	[2] X (i+1)-X (i-1)	[3] Y (i)	[4] Y (i+1)-Y (i-1)	[2] * [3]	[1] * [4]	方向角	夾角	距離
38-10	-149445.646	-49.099	-40595.239	-13.828	1993185.639661	2066534.392888	179-47-02	90-06-25	49.020
38-9	-149494.666	-48.957	-40595.054	8.212	1987412.058678	-1227650.197192	89-33-01	89-45-59	8.027
38-111	-149494.603	0.088	-40587.027	14.033	-3571.658376	-2097857.763899	89-45-41	180-12-40	6.006
38-110	-149494.578	0.070	-40581.021	14.906	-2840.671470	-2228366.179668	89-42-37	179-56-56	8.900
38-108	-149494.533	0.064	-40572.121	13.512	-2596.615744	-2019970.129896	89-45-50	180-03-13	4.612
38-107	-149494.514	0.036	-40567.509	10.355	-1460.430324	-1548015.692470	89-49-49	180-03-59	5.743
38-106	-149494.497	0.058	-40561.766	10.929	-2352.582428	-1633825.357713	89-32-49	179-43-00	5.186
38-105	-149494.456	0.057	-40556.580	9.815	-2311.725060	-1467288.085640	89-48-07	180-15-18	4.629
38-19	-149494.440	29.700	-40551.951	4.451	-1204392.944700	-665399.752440	359-39-23	89-51-16	29.685
38-112	-149464.756	49.015	-40552.129	-0.259	-1987662.602935	38711.371804	359-45-36	180-06-13	19.331
38-11	-149445.425	19.246	-40552.210	-15.182	-780467.833660	2268880.442350	269-40-39	89-55-03	15.101
38-101	-149445.510	-0.142	-40567.311	-29.016	5760.558162	4336310.918160	269-45-55	180-05-16	13.915
38-100	-149445.567	-0.136	-40581.226	-27.928	5519.046736	4173715.795176	269-40-37	179-54-42	14.013
合計				倍面積 面積	4220.238540 2110.11	-4220.238540 2110.11			184.168

面積 (座標法) 計算書

地番 = 38-2  
測点名

	[1] X (i)	[2] X (i+1)-X (i-1)	[3] Y (i)	[4] Y (i+1)-Y (i-1)	[2] * [3]	[1] * [4]	方向角	夾角	距離
38-12	-149445.284	19.171	-40523.503	-28.823	-776876.076013	4307461.420732	269-43-07	90-03-46	28.707
38-11	-149445.425	-19.472	-40552.210	-28.626	789632.633120	4278024.736050	179-45-36	90-02-29	19.331
38-112	-149464.756	-19.171	-40552.129	28.823	777424.865059	-4308022.662188	89-40-52	89-55-16	28.742
38-20K	-149464.596	19.472	-40523.387	28.626	-789071.391664	-4278573.525096	359-39-21	89-58-29	19.312
合計				倍面積 面積	1110.030502 555.01	-1110.030502 555.01			96.092

面積 (座標法) 計算書

地番 = 38-3  
測点名

	[1] X (i)	[2] X (i+1)-X (i-1)	[3] Y (i)	[4] Y (i+1)-Y (i-1)	[2] * [3]	[1] * [4]	方向角	夾角	距離
38-12	-149445.284	-19.326	-40523.503	-2.746	783157.218978	410376.749864	179-39-21	89-56-10	19.312
38-20K	-149464.596	-19.296	-40523.387	2.969	781939.275552	-443760.385524	89-40-43	90-01-22	2.853
38-22	-149464.580	19.326	-40520.534	2.746	-783099.840084	-410429.736680	359-40-57	90-00-14	19.310
38-13	-149445.270	19.296	-40520.641	-2.969	-781886.288736	443703.006630	269-43-11	90-02-14	2.862
合計				倍面積 面積	110.365710 55.18	-110.365710 55.18			44.337

面積 (座標法) 計算書

地番 = 38-4  
測点名

	[1] X (i)	[2] X (i+1)-X (i-1)	[3] Y (i)	[4] Y (i+1)-Y (i-1)	[2]*[3]	[1]*[4]	方向角	夾角	距離
38-13	-149445.270	-19.416	-40520.641	-19.590	786748.765656	2927632.839300	179-40-57	89-59-27	19.310
38-22	-149464.580	-48.998	-40520.534	0.261	1985425.124932	-39010.255380	179-42-10	180-01-13	29.688
38-17	-149494.268	-29.566	-40520.380	19.841	1198025.555080	-2966115.771388	89-38-42	89-56-32	19.687
38-16	-149494.146	49.104	-40500.693	19.436	-1988746.029072	-2905568.221656	359-42-23	90-03-41	48.983
38-14	-149445.164	48.876	-40500.944	-19.948	-1979524.138944	2981132.131472	269-41-30	89-59-07	19.697
合計				倍面積 面積	1929.277652 964.63	-1929.277652 964.63			137.365

面積 (座標法) 計算書

地番 = 38-5  
測点名

	[1] X (i)	[2] X (i+1)-X (i-1)	[3] Y (i)	[4] Y (i+1)-Y (i-1)	[2]*[3]	[1]*[4]	方向角	夾角	距離
38-26	-149452.652	14.522	-40474.617	-26.371	-587772.388074	3941215.885892	269-41-18	90-00-45	26.288
38-25K	-149452.795	-14.822	-40500.905	-26.213	600304.413910	3917606.115335	179-42-26	90-01-08	14.679
38-27K	-149467.474	-14.522	-40500.830	26.371	588153.053260	-3941606.756854	89-39-29	89-57-03	26.296
38-28	-149467.317	14.822	-40474.534	26.213	-599913.542948	-3917986.780521	359-40-33	90-01-04	14.665
合計				倍面積 面積	771.536148 385.76	-771.536148 385.76			81.928

面積 (座標法) 計算書

地番 = 38-6  
測点名

	[1] X (i)	[2] X (i+1)-X (i-1)	[3] Y (i)	[4] Y (i+1)-Y (i-1)	[2]*[3]	[1]*[4]	方向角	夾角	距離
38-28	-149467.317	23.542	-40474.534	-26.431	-952851.479428	3950570.655627	269-39-29	89-59-04	26.296
38-27K	-149467.474	-26.829	-40500.830	-26.159	1086596.768070	3909919.652366	179-42-21	90-02-52	26.672
38-16	-149494.146	-26.577	-40500.693	16.572	1076386.917861	-2477416.987512	89-40-08	89-57-47	16.435
38-103	-149494.051	0.113	-40484.258	23.341	-4574.721154	-3489340.644391	89-51-02	180-10-54	6.906
38-6	-149494.033	3.035	-40477.352	9.859	-122848.763320	-1473861.671347	44-23-09	134-32-07	4.222
38-5	-149491.016	26.716	-40474.399	2.818	-1081314.043684	-421265.683088	359-40-25	135-17-16	23.699
合計				倍面積 面積	1394.678345 697.33	-1394.678345 697.33			104.230

面積 (座標法) 計算書

地番 = 38-7  
測点名

	[1] X (i)	[2] X (i+1)-X (i-1)	[3] Y (i)	[4] Y (i+1)-Y (i-1)	[2]*[3]	[1]*[4]	方向角	夾角	距離
38-18	-149494.411	-29.584	-40548.536	16.208	1199587.889024	-2423005.413488	89-40-42	90-01-12	16.031
38-104	-149494.321	0.143	-40532.505	28.156	-5796.148215	-4209162.102076	89-44-58	180-04-16	12.125
38-17	-149494.268	29.741	-40520.380	11.971	-1205116.621580	-1789595.882228	359-42-10	89-57-12	29.688
38-22	-149464.580	29.531	-40520.534	-28.333	-1196611.889554	4234779.945140	269-40-51	89-58-41	28.179
38-24K	-149464.737	-29.831	-40548.713	-28.002	1209608.657503	4185311.565474	179-39-30	89-58-39	29.675
合計				倍面積 面積	1671.887178 835.94	-1671.887178 835.94			115.698

面積 (座標法) 計算書

地番 = 38-8  
測点名

	[1] X (i)	[2] X (i+1)-X (i-1)	[3] Y (i)	[4] Y (i+1)-Y (i-1)	[2] * [3]	[1] * [4]	方向角	夾 角	距 離
38-18	-149494.411	29.703	-40548.536	3.238	-1204413.164808	-484062.902818	359-39-30	90-08-42	29.675
38-24K	-149464.737	29.655	-40548.713	-3.593	-1202472.084015	537026.800041	269-40-53	90-01-23	3.416
38-112	-149464.756	-29.703	-40552.129	-3.238	1204519.887687	483966.879928	179-39-23	89-58-30	29.685
38-19	-149494.440	-29.655	-40551.951	3.593	1202568.106905	-537133.522920	89-30-48	89-51-25	3.415
合計				倍面積 面積	202.745769 101.37	-202.745769 101.37			66.191

面積 (座標法) 計算書

地番 = 38-9  
測点名

	[1] X (i)	[2] X (i+1)-X (i-1)	[3] Y (i)	[4] Y (i+1)-Y (i-1)	[2] * [3]	[1] * [4]	方向角	夾 角	距 離
38-26	-149452.652	4.777	-40474.617	26.273	-193347.245409	-3926569.525996	359-48-52	90-07-34	4.634
38-4	-149448.018	7.622	-40474.632	-3.040	-308497.645104	454321.974720	314-38-51	134-49-59	4.252
38-3	-149445.030	2.854	-40477.657	-26.312	-115523.233078	3932197.629360	269-40-13	135-01-22	23.287
38-14	-149445.164	-7.765	-40500.944	-23.248	314489.830160	3474301.172672	179-42-26	90-02-13	7.631
38-25K	-149452.795	-7.488	-40500.905	26.327	303270.776640	-3934643.733965	89-41-18	89-58-52	26.288
合計				倍面積 面積	392.483209 196.24	-392.483209 196.24			66.092