

63街区

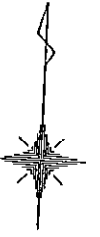

S = 1 / 500

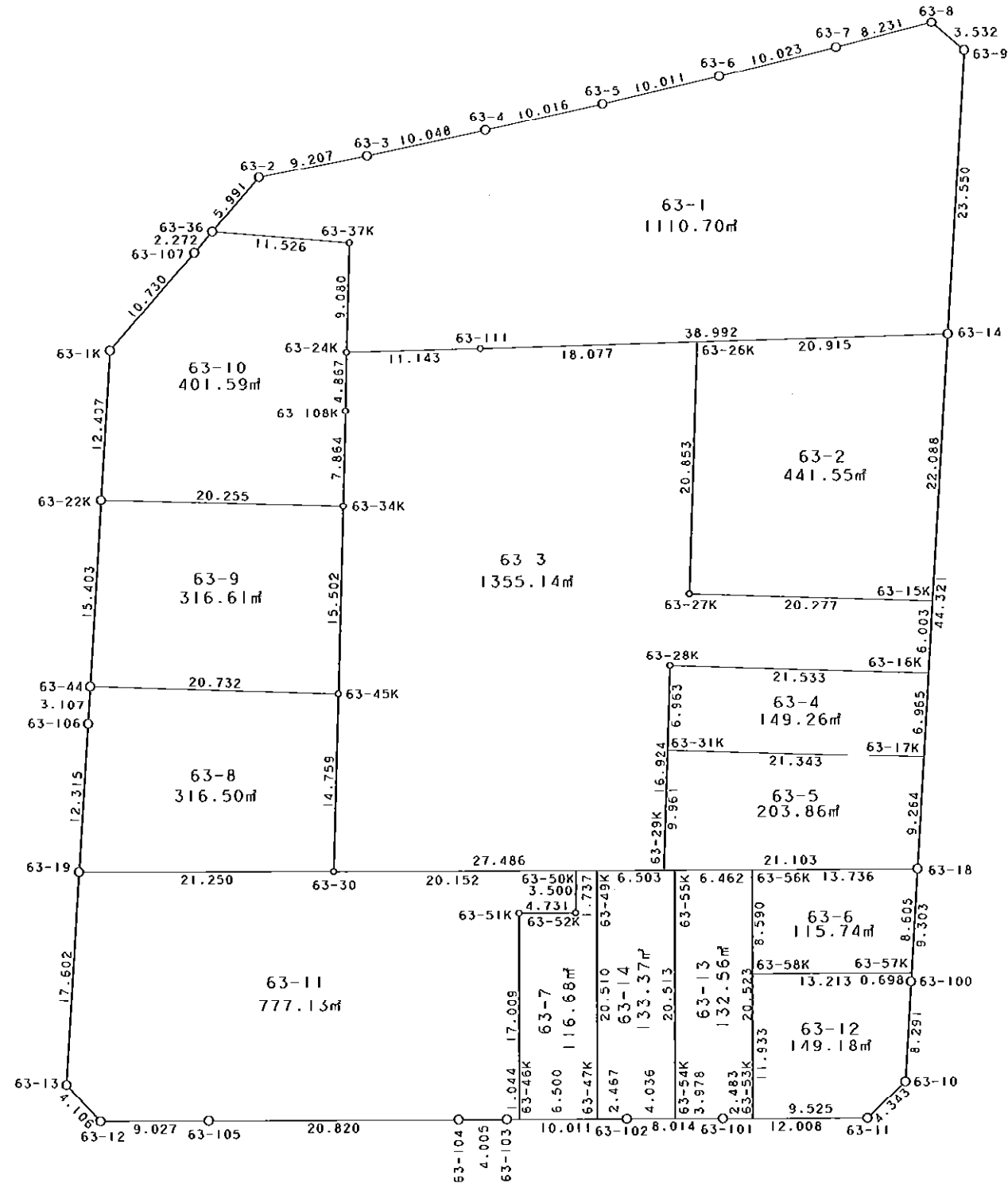

凡 例

記号	名称
⊙	地区界点
○	街区点
○	画地点(折れ点)
┆	画地点(直線中)

面積 (座標法) 計算書

地番 = 63街区

測点名	[1] X (i)	[2] X (i+1)-X (i-1)	[3] Y (i)	[4] Y (i+1)-Y (i-1)	[2] * [3]	[1] * [4]	方向角	夾角	距離
63-2	-149795.703	-6.935	-40928.594	-12.635	283839.799390	1892668.707405	218-08-24	142-06-41	5.991
63-36	-149800.415	-6.504	-40932.294	-5.097	266223.640176	763532.715255	217-56-21	179-47-57	2.272
63-107	-149802.207	-10.233	-40933.691	-8.022	418874.460003	1201713.304554	218-07-37	180-11-16	10.730
63-1K	-149810.648	-20.847	-40940.316	-6.761	853482.767652	1012869.791128	180-37-41	142-30-04	12.407
63-22K	-149823.054	-27.809	-40940.452	-0.251	1138513.029668	37605.586554	180-25-40	179-47-59	15.403
63-44	-149838.457	-18.510	-40940.567	-0.140	757809.895170	20977.383980	180-27-40	180-02-00	3.107
63-106	-149841.564	-15.421	-40940.592	-0.153	631344.869232	22925.759292	180-35-44	180-08-04	12.315
63-19	-149853.878	-29.915	-40940.720	-0.291	1224741.638800	43607.478498	180-31-50	179-56-06	17.602
63-13	-149871.479	-20.447	-40940.883	2.796	837118.234701	-419040.655284	133-53-05	133-21-15	4.106
63-12	-149874.325	-2.368	-40937.924	11.973	96941.004032	-1794445.293225	86-57-52	133-04-47	9.027
63-105	-149873.847	1.545	-40928.910	29.807	-63235.165950	-4467289.757529	87-03-45	180-05-53	20.820
63-104	-149872.780	1.281	-40908.117	24.792	-52403.297877	-3715645.961760	86-56-13	179-52-28	4.005
63-103	-149872.566	0.728	-40904.118	13.997	-29778.197904	-2097766.306302	87-03-25	180-07-12	10.011
63-102	-149872.052	0.917	-40894.120	18.002	-37499.908040	-2697996.680104	87-07-03	180-03-38	8.014
63-101	-149871.649	0.994	-40886.116	19.997	-40640.799304	-2996983.365053	87-10-44	180-03-41	12.008
63-11	-149871.058	3.728	-40874.123	14.997	-152378.730544	-2247616.256826	43-45-33	136-34-49	4.343
63-10	-149867.921	11.428	-40871.119	3.064	-467075.147932	-459195.309944	0-24-53	136-39-20	8.291
63-100	-149859.630	17.594	-40871.059	0.148	-719085.412046	-22179.225240	0-32-31	180-07-38	9.303
63-18	-149850.327	53.622	-40870.971	0.491	-2191583.206962	-73576.510557	0-31-16	179-58-45	44.321
63-14	-149806.008	67.868	-40870.568	0.625	-2773803.709024	-93628.755000	0-32-24	180-01-08	23.550
63-9	-149782.459	25.683	-40870.346	-2.592	-1049673.096318	388236.133728	307-10-30	126-38-06	3.532
63-8	-149780.325	-0.263	-40873.160	-10.688	10749.641080	1600852.113600	253-04-07	125-53-37	8.231
63-7	-149782.722	-5.236	-40881.034	-17.487	214053.094024	2619250.459614	253-32-48	180-28-41	10.023
63-6	-149785.561	-5.580	-40890.647	-19.241	228169.810260	2882023.979201	254-06-32	180-33-44	10.011
63-5	-149788.302	-5.373	-40900.275	-19.292	219757.177575	2889715.922184	254-45-54	180-39-22	10.016
63-4	-149790.934	-5.178	-40909.939	-19.384	211831.664142	2903547.464656	255-19-19	180-33-25	10.048
63-3	-149793.480	-4.769	-40919.659	-18.655	195145.853771	2794397.369400	256-01-43	180-42-24	9.207
合計				倍面積 面積	11439.907775 5719.95	-11439.907775 5719.95			298.694

地番	筆種別	面積	坪数
63-1	筆界	1110.70	335.98
63-2	筆界	441.55	133.57
63-3	筆界	1355.14	409.93
63-4	筆界	149.26	45.15
63-5	筆界	203.86	61.66
63-6	筆界	115.74	35.01
63-7	筆界	116.68	35.29
63-8	筆界	316.50	95.74
63-9	筆界	316.61	95.77
63-10	筆界	401.59	121.48
63-11	筆界	777.13	235.08
63-12	筆界	149.18	45.12
63-13	筆界	132.56	40.10
63-14	筆界	133.37	40.34
	筆合	5719.87	1730.22

面積 (座標法) 計算書

地番 = 63-1

測点名	[1] X (i)	[2] X (i+1)-X (i-1)	[3] Y (i)	[4] Y (i+1)-Y (i-1)	[2] * [3]	[1] * [4]	方向角	夾角	距離
63-2	-149795.703	-6.935	-40928.594	-12.635	283839.799390	1892668.707405	218-08-24	142-06-41	5.991
63-36	-149800.415	-5.060	-40932.294	7.821	207117.407640	-1171589.045715	91-43-48	53-35-24	11.526
63-37K	-149800.763	-9.425	-40920.773	11.738	385678.285525	-1758361.356094	178-37-50	266-54-02	9.080
63-24K	-149809.840	-8.235	-40920.556	11.328	336980.778660	-1697045.867520	85-39-59	87-02-09	11.143
63-111	-149808.998	3.832	-40909.445	49.988	-156764.993240	-7488652.192024	85-36-08	179-56-09	38.992
63-14	-149806.008	26.539	-40870.568	39.099	-1084664.004152	-5857265.106792	0-32-24	94-56-16	23.550
63-9	-149782.459	25.683	-40870.346	-2.592	-1049673.096318	388236.133728	307-10-30	126-38-06	3.532
63-8	-149780.325	-0.263	-40873.160	-10.688	10749.641080	1600852.113600	253-04-07	125-53-37	8.231
63-7	-149782.722	-5.236	-40881.034	-17.487	214053.094024	2619250.459614	253-32-48	180-28-41	10.023
63-6	-149785.561	-5.580	-40890.647	-19.241	228169.810260	2882023.979201	254-06-32	180-33-44	10.011
63-5	-149788.302	-5.373	-40900.275	-19.292	219757.177575	2889715.922184	254-45-54	180-39-22	10.016
63-4	-149790.934	-5.178	-40909.939	-19.384	211831.664142	2903547.464656	255-19-19	180-33-25	10.048
63-3	-149793.480	-4.769	-40919.659	-18.655	195145.853771	2794397.369400	256-01-43	180-42-24	9.207
合計				倍面積 面積	2221.418357 1110.70	-2221.418357 1110.70			161.350

面積 (座標法) 計算書

地番 = 63-2

測点名	[1] X (i)	[2] X (i+1)-X (i-1)	[3] Y (i)	[4] Y (i+1)-Y (i-1)	[2] * [3]	[1] * [4]	方向角	夾角	距離
63-27K	-149828.462	-20.483	-40891.043	20.652	837571.233769	-3094257.397224	88-57-47	90-00-06	20.277
63-15K	-149828.095	22.454	-40870.769	20.475	-917712.247126	-3067730.245125	0-31-17	91-33-30	22.088
63-14	-149806.008	20.483	-40870.568	-20.652	-837151.844344	3093793.677216	265-36-05	85-04-48	20.915
63-26K	-149807.612	-22.454	-40891.421	-20.475	918175.967134	3067310.855700	178-57-41	93-21-36	20.853
合計				倍面積 面積	883.109433 441.55	-883.109433 441.55			84.133

面積 (座標法) 計算書

地番 = 63-3

測点名	[1] X (i)	[2] X (i+1)-X (i-1)	[3] Y (i)	[4] Y (i+1)-Y (i-1)	[2] * [3]	[1] * [4]	方向角	夾角	距離
63-24K	-149809.840	-5.707	-40920.556	-10.964	233533.613092	1642515.085760	178-16-09	92-36-10	4.867
63-108K	-149814.705	-12.726	-40920.409	0.353	520753.124934	-52884.590865	178-29-56	180-13-47	7.864
63-34K	-149822.566	-23.359	-40920.203	0.570	955855.021877	-85398.862620	178-39-16	180-09-20	15.502
63-45K	-149838.064	-30.253	-40919.839	0.707	1237947.889267	-105935.511248	178-40-06	180-00-50	14.759
63-30	-149852.819	-13.345	-40919.496	27.793	546070.674120	-4164859.398467	87-03-34	88-23-28	27.486
63-29K	-149851.409	18.331	-40892.046	27.144	-749592.095226	-4067566.645896	358-57-50	91-54-16	16.924
63-28K	-149834.488	17.311	-40892.352	21.223	-707887.505472	-3179937.338824	88-57-44	269-59-54	21.533
63-16K	-149834.098	6.393	-40870.823	21.583	-261287.171439	-3233869.337134	0-30-55	91-33-11	6.003
63-15K	-149828.095	5.636	-40870.769	-20.220	-230347.654084	3029524.080900	268-57-47	88-26-52	20.277
63-27K	-149828.462	20.483	-40891.043	-20.652	-837571.233769	3094257.397224	358-57-41	269-59-54	20.853
63-26K	-149807.612	19.464	-40891.421	-18.402	-795910.618344	2756759.676024	265-36-10	86-38-29	18.077
63-111	-149808.998	-2.228	-40909.445	-29.135	91146.243460	4364685.156730	265-39-59	180-03-49	11.143
合計				倍面積 面積	2710.288416 1355.14	-2710.288416 1355.14			185.288

面積 (座標法) 計算書

地番 = 63-4
測点名

	[1] X (i)	[2] X (i+1)-X (i-1)	[3] Y (i)	[4] Y (i+1)-Y (i-1)	[2] * [3]	[1] * [4]	方向角	夾角	距離
63-17K	-149841.063	7.352	-40870.887	21.403	-300482.761224	-3207048.271389	0-31-35	91-33-55	6.965
63-16K	-149834.098	6.575	-40870.823	-21.465	-268725.661225	3216188.913570	268-57-44	88-26-09	21.533
63-28K	-149834.488	-7.352	-40892.352	-21.403	300640.571904	3206907.546664	178-57-47	90-00-03	6.963
63-31K	-149841.450	-6.575	-40892.226	21.465	268866.385950	-3216346.724250	88-57-40	89-59-53	21.343
合計				倍面積 面積	298.535405 149.26	-298.535405 149.26			56.804

面積 (座標法) 計算書

地番 = 63-5
測点名

	[1] X (i)	[2] X (i+1)-X (i-1)	[3] Y (i)	[4] Y (i+1)-Y (i-1)	[2] * [3]	[1] * [4]	方向角	夾角	距離
63-31K	-149841.450	-10.346	-40892.226	-21.159	423070.970196	3170495.240550	178-57-52	90-00-12	9.961
63-29K	-149851.409	-8.877	-40892.046	21.255	362998.692342	-3185091.698295	87-03-40	88-05-48	21.103
63-18	-149850.327	10.346	-40870.971	21.159	-422851.065966	-3170683.068993	0-31-10	93-27-30	9.264
63-17K	-149841.063	8.877	-40870.887	-21.255	-362810.863899	3184871.794065	268-57-40	88-26-30	21.343
合計				倍面積 面積	407.732673 203.86	-407.732673 203.86			61.671

面積 (座標法) 計算書

地番 = 63-6
測点名

	[1] X (i)	[2] X (i+1)-X (i-1)	[3] Y (i)	[4] Y (i+1)-Y (i-1)	[2] * [3]	[1] * [4]	方向角	夾角	距離
63-57K	-149858.932	9.283	-40871.052	13.277	-379405.975716	-1989677.040164	0-32-22	93-28-50	8.605
63-18	-149850.327	7.901	-40870.971	-13.637	-322921.541871	2043508.909299	267-03-44	86-31-22	13.736
63-56K	-149851.031	-9.283	-40884.689	-13.277	379532.567987	1989572.138587	177-03-26	89-59-42	8.590
63-58K	-149859.610	-7.901	-40884.248	13.637	323026.443448	-2043635.501570	87-03-32	90-00-06	13.213
合計				倍面積 面積	231.493848 115.74	-231.493848 115.74			44.144

面積 (座標法) 計算書

地番 = 63-7
測点名

	[1] X (i)	[2] X (i+1)-X (i-1)	[3] Y (i)	[4] Y (i+1)-Y (i-1)	[2] * [3]	[1] * [4]	方向角	夾角	距離
63-50K	-149851.785	-3.586	-40899.371	-1.586	146665.144406	237664.931010	177-33-37	90-29-48	3.500
63-52K	-149855.282	-3.740	-40899.222	-4.576	152963.090280	685737.770432	267-03-21	269-29-44	4.731
63-51K	-149855.525	-17.230	-40903.947	-3.853	704775.006810	577393.337825	177-03-41	90-00-20	17.009
63-46K	-149872.512	-16.654	-40903.075	7.363	681199.811050	-1103511.305856	87-03-48	90-00-07	6.500
63-47K	-149872.179	20.816	-40896.584	5.439	-851303.292544	-815154.781581	357-03-36	89-59-48	20.510
63-49K	-149851.696	20.394	-40897.636	-2.787	-834066.388584	417636.676752	267-03-49	90-00-13	1.737
合計				倍面積 面積	233.371418 116.68	-233.371418 116.68			53.987

面積 (座標法) 計算書

地番 = 63-8
測点名

	[1] X (i)	[2] X (i+1)-X (i-1)	[3] Y (i)	[4] Y (i+1)-Y (i-1)	[2] * [3]	[1] * [4]	方向角	夾角	距離
63-44	-149838.457	-3.500	-40940.567	-20.753	143291.984500	3109597.498121	180-27-40	91-32-50	3.107
63-106	-149841.564	-15.421	-40940.592	-0.153	631344.869232	22925.759292	180-35-44	180-08-04	12.315
63-19	-149853.878	-11.255	-40940.720	21.096	460787.803600	-3161317.410288	87-08-37	86-32-53	21.250
63-30	-149852.819	15.814	-40919.496	20.881	-647100.909744	-3129076.713539	358-40-06	91-31-29	14.759
63-45K	-149838.064	14.362	-40919.839	-21.071	-587690.727718	3157237.846544	268-54-50	90-14-44	20.732
合計				倍面積 面積	633.019870 316.50	-633.019870 316.50			72.163

面積 (座標法) 計算書

地番 = 63-9
測点名

	[1] X (i)	[2] X (i+1)-X (i-1)	[3] Y (i)	[4] Y (i+1)-Y (i-1)	[2] * [3]	[1] * [4]	方向角	夾角	距離
63-22K	-149823.054	-15.891	-40940.452	-20.364	650584.722732	3050996.671656	180-25-40	91-48-30	15.403
63-44	-149838.457	-15.010	-40940.567	20.613	614517.910670	-3088620.114141	88-54-50	88-29-10	20.732
63-45K	-149838.064	15.891	-40919.839	20.364	-650257.161549	-3051302.335296	358-39-16	89-44-26	15.502
63-34K	-149822.566	15.010	-40920.203	-20.613	-614212.247030	3088292.552958	268-37-10	89-57-54	20.255
合計				倍面積 面積	633.224823 316.61	-633.224823 316.61			71.892

面積 (座標法) 計算書

地番 = 63-10
測点名

	[1] X (i)	[2] X (i+1)-X (i-1)	[3] Y (i)	[4] Y (i+1)-Y (i-1)	[2] * [3]	[1] * [4]	方向角	夾角	距離
63-36	-149800.415	-1.444	-40932.294	-12.918	59106.232536	1935121.760970	217-56-21	126-12-33	2.272
63-107	-149802.207	-10.233	-40933.691	-8.022	418874.460003	1201713.304554	218-07-37	180-11-16	10.730
63-1K	-149810.648	-20.847	-40940.316	-6.761	853482.767652	1012869.791128	180-37-41	142-30-04	12.407
63-22K	-149823.054	-11.918	-40940.452	20.113	487928.306936	-3013391.085102	88-37-10	87-59-29	20.255
63-34K	-149822.566	8.349	-40920.203	20.043	-341642.774847	-3002893.690338	358-29-56	89-52-46	7.864
63-108K	-149814.705	12.726	-40920.409	-0.353	-520753.124934	52884.590865	358-16-09	179-46-13	4.867
63-24K	-149809.840	13.942	-40920.556	-0.364	-570514.391752	54530.781760	358-37-50	180-21-41	9.080
63-37K	-149800.763	9.425	-40920.773	-11.738	-385678.285525	1758361.356094	271-43-48	93-05-58	11.526
合計				倍面積 面積	803.190069 401.59	-803.190069 401.59			79.001

面積 (座標法) 計算書

地番 = 63-11

測点名	[1] X (i)	[2] X (i+1)-X (i-1)	[3] Y (i)	[4] Y (i+1)-Y (i-1)	[2] * [3]	[1] * [4]	方向角	夾角	距離
63-30	-149852.819	-2.093	-40919.496	-41.349	85644.505128	6196264.212831	267-08-37	180-05-05	21.250
63-19	-149853.878	-18.660	-40940.720	-21.387	763953.835200	3204924.888786	180-31-50	93-23-13	17.602
63-13	-149871.479	-20.447	-40940.883	2.796	837118.234701	-419040.655284	133-53-05	133-21-15	4.106
63-12	-149874.325	-2.368	-40937.924	11.973	96941.004032	-1794445.293225	86-57-52	133-04-47	9.027
63-105	-149873.847	1.545	-40928.910	29.807	-63235.165950	-4467289.757529	87-03-45	180-05-53	20.820
63-104	-149872.780	1.281	-40908.117	24.792	-52403.297877	-3715645.961760	86-56-13	179-52-28	4.005
63-103	-149872.566	0.268	-40904.118	5.042	-10962.303624	-755657.477772	87-02-10	180-05-57	1.044
63-46K	-149872.512	17.041	-40903.075	0.171	-697029.301075	-25628.199552	357-03-41	90-01-31	17.009
63-51K	-149855.525	17.230	-40903.947	3.853	-704775.006810	-577393.337825	87-03-21	269-59-40	4.731
63-52K	-149855.282	3.740	-40899.222	4.576	-152963.090280	-685737.770432	357-33-37	90-30-16	3.500
63-50K	-149851.785	2.463	-40899.371	-20.274	-100735.150773	3038095.089090	267-03-32	89-29-55	20.152
合計				倍面積 面積	1554.262672 777.13	-1554.262672 777.13			123.246

面積 (座標法) 計算書

地番 = 63-12

測点名	[1] X (i)	[2] X (i+1)-X (i-1)	[3] Y (i)	[4] Y (i+1)-Y (i-1)	[2] * [3]	[1] * [4]	方向角	夾角	距離
63-58K	-149859.610	-12.595	-40884.248	-12.584	514937.103560	1885833.332240	177-03-37	90-00-05	11.933
63-53K	-149871.527	-11.448	-40883.636	10.125	468035.864928	-1517449.210875	87-10-39	90-07-02	9.525
63-11	-149871.058	3.606	-40874.123	12.517	-147392.087538	-1875936.032986	43-45-33	136-34-54	4.343
63-10	-149867.921	11.428	-40871.119	3.064	-467075.147932	-459195.309944	0-24-53	136-39-20	8.291
63-100	-149859.630	8.989	-40871.059	0.067	-367389.949351	-10040.595210	0-34-28	180-09-35	0.698
63-57K	-149858.932	0.020	-40871.052	-13.189	-817.421040	1976489.454148	267-03-32	86-29-04	13.213
合計				倍面積 面積	298.362627 149.18	-298.362627 149.18			48.003

面積 (座標法) 計算書

地番 = 63-13

測点名	[1] X (i)	[2] X (i+1)-X (i-1)	[3] Y (i)	[4] Y (i+1)-Y (i-1)	[2] * [3]	[1] * [4]	方向角	夾角	距離
63-56K	-149851.031	20.164	-40884.689	-7.506	-824398.868996	1124781.838686	267-03-17	89-59-45	6.462
63-55K	-149851.363	-20.818	-40891.142	-5.400	851271.794156	809197.360200	177-03-27	90-00-10	20.513
63-54K	-149871.849	-20.286	-40890.089	5.026	829496.345454	-753255.913074	87-07-05	90-03-38	3.978
63-101	-149871.649	0.322	-40886.116	6.453	-13165.329352	-967121.750997	87-11-01	180-03-56	2.483
63-53K	-149871.527	20.618	-40883.636	1.427	-842938.807048	-213866.669029	357-03-32	89-52-31	20.523
合計				倍面積 面積	265.134214 132.56	-265.134214 132.56			53.959

面積 (座標法) 計算書

地番 = 63-14
測点名

	[1] X (i)	[2] X (i+1) - X (i-1)	[3] Y (i)	[4] Y (i+1) - Y (i-1)	[2] * [3]	[1] * [4]	方向角	夾 角	距 離
63-55K	-149851.363	20.153	-40891.142	-7.547	-824079.184726	1130928.236561	267-03-52	90-00-25	6.503
63-49K	-149851.696	-20.816	-40897.636	-5.442	851325.190976	815492.929632	177-03-36	89-59-44	20.510
63-47K	-149872.179	-20.356	-40896.584	3.516	832490.863904	-526950.581364	87-02-58	89-59-22	2.467
63-102	-149872.052	0.330	-40894.120	6.495	-13495.059600	-973418.977740	87-07-01	180-04-03	4.036
63-54K	-149871.849	20.689	-40890.089	2.978	-845975.051321	-446318.366322	357-03-27	89-56-26	20.513
合計				2.978	266.759233	-266.759233			54.029
				倍面積 面積	133.37	133.37			