

西部第4地区土地区画整理事業 出来形確認測量 (原子図)

58街区

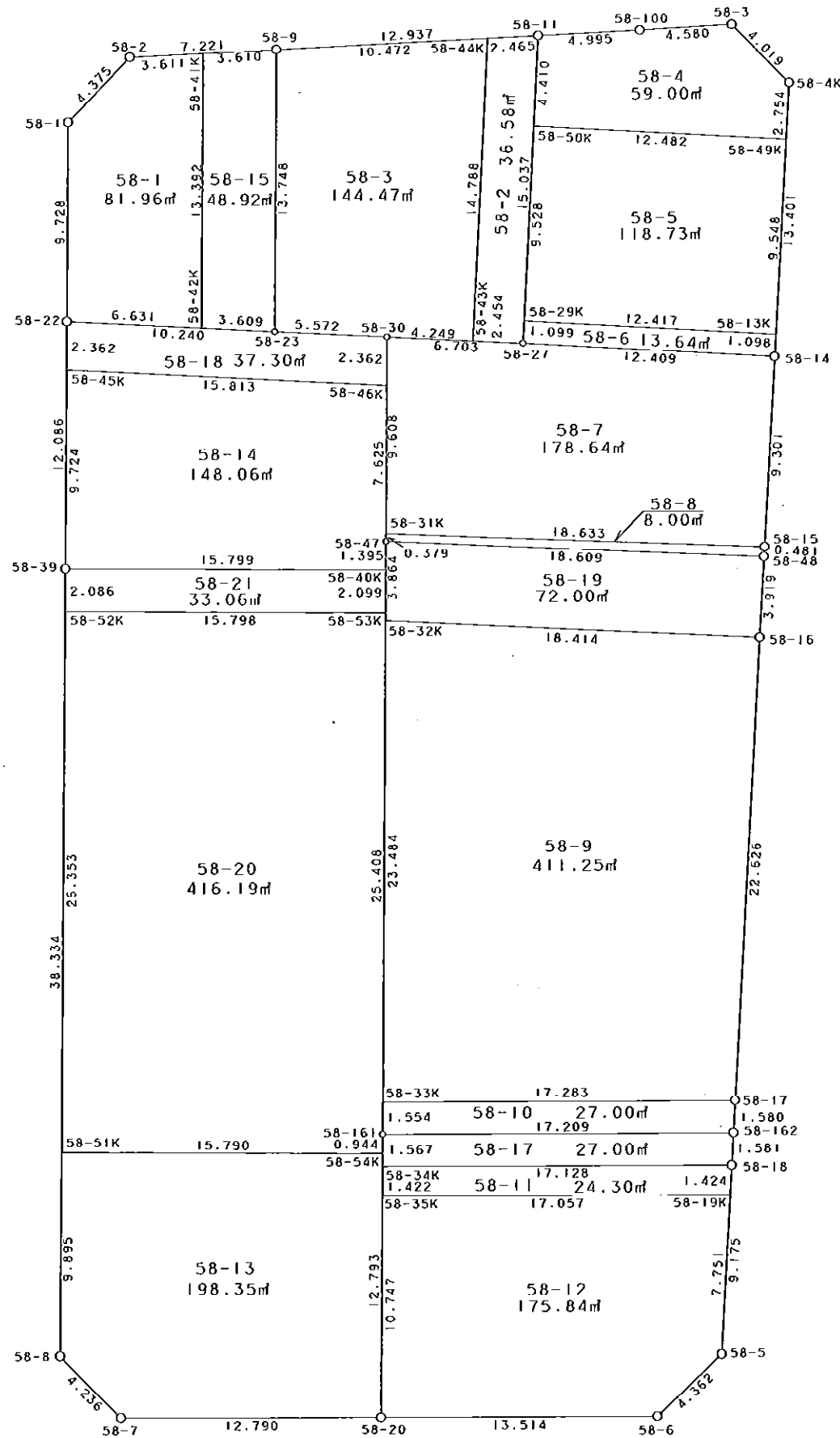

S = 1 / 300



凡 例

記号	名称
⊙	地区界点
○	街区点
○	画地点(折れ点)
└	画地点(直線中)

面積 (座標法) 計算書

地番 = 58街区

測点名	[1] X (i)	[2] X (i+1)-X (i-1)	[3] Y (i)	[4] Y (i+1)-Y (i-1)	[2] * [3]	[1] * [4]	方向角	夾角	距離
58-2	-149926.064	-3.771	-41067.966	-10.149	154867.299786	1521599.623536	222-21-36	136-37-58	4.375
58-1	-149929.297	-12.959	-41070.914	-2.753	532237.974526	412755.354641	178-51-05	136-29-29	9.728
58-22	-149939.023	-21.810	-41070.719	0.432	895752.381390	-64773.657936	178-52-35	180-01-30	12.086
58-39	-149951.107	-50.411	-41070.482	0.991	2070404.068102	-148601.547037	178-52-23	179-59-48	38.334
58-8	-149989.434	-41.246	-41069.728	3.824	1693962.001088	-573559.595616	133-33-21	134-40-58	4.236
58-7	-149992.353	-2.586	-41066.658	15.856	106198.377588	-2378278.749168	88-30-29	134-57-08	12.790
58-20	-149992.020	0.677	-41053.872	26.296	-27793.471344	-3944190.157920	88-32-29	180-02-00	13.514
58-6	-149991.676	3.422	-41040.362	16.601	-140440.118764	-2490011.813276	45-07-15	136-34-46	4.362
58-5	-149988.598	12.249	-41037.271	3.361	-502665.532479	-504111.677878	1-41-11	136-33-56	9.175
58-18	-149979.427	10.751	-41037.001	0.318	-441188.797751	-47693.457786	1-44-24	180-03-13	1.581
58-162	-149977.847	3.159	-41036.953	0.092	-129635.734527	-13797.961924	1-35-46	179-51-22	1.580
58-17	-149976.268	24.195	-41036.909	0.724	-992888.013255	-108582.818032	1-43-20	180-07-34	22.626
58-16	-149953.652	26.533	-41036.229	0.802	-1088814.264057	-120262.828904	1-47-02	180-03-42	3.919
58-48	-149949.735	4.398	-41036.107	0.139	-180476.798586	-20843.013165	2-01-27	180-14-25	0.481
58-15	-149949.254	9.778	-41036.090	0.299	-401250.888020	-44834.826946	1-44-15	179-42-48	9.301
58-14	-149939.957	22.692	-41035.808	0.681	-931184.555136	-102109.110717	1-42-22	179-58-07	13.401
58-4K	-149926.562	16.166	-41035.409	-2.512	-663378.421894	376615.523744	313-35-19	131-52-57	4.019
58-3	-149923.791	2.404	-41038.320	-7.476	-98656.121280	1120830.261516	265-24-13	131-48-54	4.580
58-100	-149924.158	-0.743	-41042.885	-9.546	30494.863555	1431176.012268	265-40-59	180-16-46	4.995
58-11	-149924.534	-1.368	-41047.866	-17.880	56153.480688	2680650.667920	265-36-08	179-55-09	12.937
58-9	-149925.526	-1.530	-41060.765	-20.100	62822.970450	3013503.072600	265-43-38	180-07-30	7.221
合計				倍面積 面積	4520.700080 2260.35	-4520.700080 2260.35			195.241

地番	種別	面積	坪数
58-1	筆界	81.96	24.79
58-2	筆界	36.58	11.06
58-3	筆界	144.47	43.70
58-4	筆界	59.00	17.84
58-5	筆界	118.73	35.91
58-6	筆界	13.64	4.12
58-7	筆界	178.64	54.03
58-8	筆界	8.00	2.42
58-9	筆界	411.25	124.40
58-10	筆界	27.00	8.16
58-11	筆界	24.30	7.35
58-12	筆界	175.84	53.19
58-13	筆界	198.35	60.00
58-14	筆界	148.06	44.78
58-15	筆界	48.92	14.79
58-17	筆界	27.00	8.16
58-18	筆界	37.30	11.28
58-19	筆界	72.00	21.78
58-20	筆界	416.19	125.89
58-21	筆合	33.06	10.00
	計	2260.29	683.65

面積 (座標法) 計算書

地番 = 58-1
測点名

	[1] X (i)	[2] X (i+1)-X (i-1)	[3] Y (i)	[4] Y (i+1)-Y (i-1)	[2] * [3]	[1] * [4]	方向角	夾角	距離
58-41K	-149925.795	13.120	-41064.365	-3.876	-538764.468800	581112.381420	265-43-40	86-54-16	3.611
58-2	-149926.064	-3.502	-41067.966	-6.549	143820.016932	981865.793136	222-21-36	136-37-56	4.375
58-1	-149929.297	-12.959	-41070.914	-2.753	532237.974526	412755.354641	178-51-05	136-29-29	9.728
58-22	-149939.023	-9.887	-41070.719	6.824	406066.198753	-1023183.892952	91-23-29	92-32-24	6.631
58-42K	-149939.184	13.228	-41064.090	6.354	-543195.782520	-952713.575136	358-49-24	87-25-55	13.392
合計				倍面積 面積	163.938891 81.96	-163.938891 81.96			37.737

面積 (座標法) 計算書

地番 = 58-2
測点名

	[1] X (i)	[2] X (i+1)-X (i-1)	[3] Y (i)	[4] Y (i+1)-Y (i-1)	[2] * [3]	[1] * [4]	方向角	夾角	距離
58-43K	-149939.507	-14.844	-41050.664	2.113	609356.056416	-316822.178291	91-24-04	90-05-01	2.454
58-27	-149939.567	14.973	-41048.211	2.798	-614614.863303	-419530.908466	1-18-53	89-54-49	15.037
58-11	-149924.534	14.844	-41047.866	-2.113	-609314.522904	316790.540342	265-36-11	84-17-18	2.465
58-44K	-149924.723	-14.973	-41050.324	-2.798	614646.501252	419489.374954	181-19-03	95-42-52	14.788
合計				倍面積 面積	73.171461 36.58	-73.171461 36.58			34.744

面積 (座標法) 計算書

地番 = 58-3
測点名

	[1] X (i)	[2] X (i+1)-X (i-1)	[3] Y (i)	[4] Y (i+1)-Y (i-1)	[2] * [3]	[1] * [4]	方向角	夾角	距離
58-44K	-149924.723	13.981	-41050.324	-10.101	-573924.579844	1514389.627023	265-36-08	84-17-05	10.472
58-9	-149925.526	-14.548	-41060.765	-10.158	597352.009220	1522943.493108	178-49-14	93-13-06	13.748
58-23	-149939.271	-13.878	-41060.482	5.853	569837.369196	-877594.553163	91-22-04	92-32-50	5.572
58-30	-149939.404	-0.236	-41054.912	9.818	9688.959232	-1472105.068472	91-23-20	180-01-16	4.249
58-43K	-149939.507	14.681	-41050.664	4.588	-602664.798184	-687922.458116	1-19-03	89-55-43	14.788
合計				倍面積 面積	288.959620 144.47	-288.959620 144.47			48.829

面積 (座標法) 計算書

地番 = 58-4
測点名

	[1] X (i)	[2] X (i+1)-X (i-1)	[3] Y (i)	[4] Y (i+1)-Y (i-1)	[2] * [3]	[1] * [4]	方向角	夾角	距離
58-49K	-149929.315	2.381	-41035.491	12.558	-97705.504071	-1882812.337770	1-42-22	89-59-54	2.754
58-4K	-149926.562	5.524	-41035.409	-2.829	-226679.599316	424142.243898	313-35-19	131-52-57	4.019
58-3	-149923.791	2.404	-41038.320	-7.476	-98656.121280	1120830.261516	265-24-13	131-48-54	4.580
58-100	-149924.158	-0.743	-41042.885	-9.546	30494.863555	1431176.012268	265-40-59	180-16-46	4.995
58-11	-149924.534	-4.785	-41047.866	-5.082	196414.038810	761916.481788	181-18-44	95-37-45	4.410
58-50K	-149928.943	-4.781	-41047.967	12.375	196250.330227	-1855370.669625	91-42-28	90-23-44	12.482
合計				倍面積 面積	118.007925 59.00	-118.007925 59.00			33.240

面積 (座標法) 計算書

地番 = 58-5
測点名

	[1] X (i)	[2] X (i+1)-X (i-1)	[3] Y (i)	[4] Y (i+1)-Y (i-1)	[2] * [3]	[1] * [4]	方向角	夾角	距離
58-50K	-149928.943	-9.153	-41047.967	-12.695	375712.041951	1903347.931385	181-19-02	89-36-34	9.528
58-29K	-149938.468	-9.916	-41048.186	12.192	407033.812376	-1828049.801856	91-48-16	90-29-14	12.417
58-13K	-149938.859	9.153	-41035.775	12.695	-375600.448575	-1903473.815005	1-42-16	89-54-00	9.548
58-49K	-149929.315	9.916	-41035.491	-12.192	-406907.928756	1827938.208480	271-42-28	90-00-12	12.482
合計				倍面積 面積	237.476996 118.73	-237.476996 118.73			43.975

面積 (座標法) 計算書

地番 = 58-6
測点名

	[1] X (i)	[2] X (i+1)-X (i-1)	[3] Y (i)	[4] Y (i+1)-Y (i-1)	[2] * [3]	[1] * [4]	方向角	夾角	距離
58-29K	-149938.468	-0.708	-41048.186	-12.436	29062.115688	1864634.788048	181-18-11	89-29-55	1.099
58-27	-149939.567	-1.489	-41048.211	12.378	61120.786179	-1855951.960326	91-48-04	90-29-53	12.409
58-14	-149939.957	0.708	-41035.808	12.436	-29053.352064	-1864653.305252	1-43-17	89-55-13	1.098
58-13K	-149938.859	1.489	-41035.775	-12.378	-61102.268975	1855943.196702	271-48-16	90-04-59	12.417
合計				倍面積 面積	27.280828 13.64	-27.280828 13.64			27.023

面積 (座標法) 計算書

地番 = 58-7
測点名

	[1] X (i)	[2] X (i+1)-X (i-1)	[3] Y (i)	[4] Y (i+1)-Y (i-1)	[2] * [3]	[1] * [4]	方向角	夾角	距離
58-15	-149949.254	9.053	-41036.090	18.913	-371499.722770	-2835990.240902	1-44-15	90-59-14	9.301
58-14	-149939.957	9.687	-41035.808	-12.121	-397513.872096	1817422.218797	271-48-04	90-03-49	12.409
58-27	-149939.567	0.553	-41048.211	-19.104	-22699.660683	2864445.487968	271-23-36	179-35-32	6.703
58-30	-149939.404	-9.443	-41054.912	-6.510	387681.534016	976105.520040	178-51-39	87-28-03	9.608
58-31K	-149949.010	-9.850	-41054.721	18.822	404389.001850	-2822340.266220	90-45-01	91-53-22	18.633
合計				倍面積 面積	357.280317 178.64	-357.280317 178.64			56.654

面積 (座標法) 計算書

地番 = 58-8
測点名

	[1] X (i)	[2] X (i+1)-X (i-1)	[3] Y (i)	[4] Y (i+1)-Y (i-1)	[2] * [3]	[1] * [4]	方向角	夾角	距離
58-15	-149949.254	0.725	-41036.090	-18.614	-29751.165250	2791155.413956	270-45-01	88-43-34	18.633
58-31K	-149949.010	-0.135	-41054.721	-18.623	5542.387335	2792500.413230	178-47-27	88-02-26	0.379
58-47	-149949.389	-0.725	-41054.713	18.614	29764.666925	-2791157.926846	91-03-55	92-16-28	18.609
58-48	-149949.735	0.135	-41036.107	18.623	-5539.874445	-2792513.914905	2-01-27	90-57-32	0.481
合計				倍面積 面積	16.014565 8.00	-16.014565 8.00			38.102

面積 (座標法) 計算書

地番 = 58-9
測点名

	[1] X (i)	[2] X (i+1)-X (i-1)	[3] Y (i)	[4] Y (i+1)-Y (i-1)	[2] * [3]	[1] * [4]	方向角	夾角	距離
58-17	-149976.268	23.080	-41036.909	17.957	-947131.859720	-2693123.844476	1-43-20	93-15-38	22.626
58-16	-149953.652	23.016	-41036.229	-17.730	-944489.846664	2658678.249960	271-14-41	89-31-21	18.414
58-32K	-149953.252	-23.080	-41054.639	-17.957	947541.068120	2692710.546164	178-53-41	87-39-00	23.484
58-33K	-149976.732	-23.016	-41054.186	17.730	944903.144976	-2659087.458360	88-27-42	89-34-01	17.283
合計				倍面積 面積	822.506712 411.25	-822.506712 411.25			81.807

面積 (座標法) 計算書

地番 = 58-10
測点名

	[1] X (i)	[2] X (i+1)-X (i-1)	[3] Y (i)	[4] Y (i+1)-Y (i-1)	[2] * [3]	[1] * [4]	方向角	夾角	距離
58-17	-149976.268	1.115	-41036.909	-17.233	-45756.153535	2584541.026444	268-27-42	86-51-56	17.283
58-33K	-149976.732	-2.018	-41054.186	-17.247	82847.347348	2586648.696804	178-53-39	90-25-57	1.554
58-161	-149978.286	-1.115	-41054.156	17.233	45775.383940	-2584575.802638	88-32-18	89-38-39	17.209
58-162	-149977.847	2.018	-41036.953	17.247	-82812.571154	-2586667.927209	1-35-46	93-03-28	1.580
合計				倍面積 面積	54.006599 27.00	-54.006599 27.00			37.626

面積 (座標法) 計算書

地番 = 58-11
測点名

	[1] X (i)	[2] X (i+1)-X (i-1)	[3] Y (i)	[4] Y (i+1)-Y (i-1)	[2] * [3]	[1] * [4]	方向角	夾角	距離
58-19K	-149980.850	1.848	-41037.043	17.094	-75836.455464	-2563772.649900	1-41-26	93-07-06	1.424
58-18	-149979.427	0.997	-41037.001	-17.081	-40913.889997	2561798.592587	268-34-29	86-53-03	17.128
58-34K	-149979.853	-1.848	-41054.124	-17.094	75868.021152	2563755.607182	178-49-54	90-15-25	1.422
58-35K	-149981.275	-0.997	-41054.095	17.081	40930.932715	-2561830.158275	88-34-20	89-44-26	17.057
合計				倍面積 面積	48.608406 24.30	-48.608406 24.30			37.031

面積 (座標法) 計算書

地番 = 58-12
測点名

	[1] X (i)	[2] X (i+1)-X (i-1)	[3] Y (i)	[4] Y (i+1)-Y (i-1)	[2] * [3]	[1] * [4]	方向角	夾角	距離
58-35K	-149981.275	-11.170	-41054.095	-16.829	458574.241150	2524034.876975	178-48-40	90-14-20	10.747
58-20	-149992.020	-10.401	-41053.872	13.733	427001.322672	-2059840.410660	88-32-29	89-43-49	13.514
58-6	-149991.676	3.422	-41040.362	16.601	-140440.118764	-2490011.813276	45-07-15	136-34-46	4.362
58-5	-149988.598	10.826	-41037.271	3.319	-444269.495846	-497812.156762	1-41-08	136-33-53	7.751
58-19K	-149980.850	7.323	-41037.043	-16.824	-300514.265889	2523277.820400	268-34-20	86-53-12	17.057
合計				倍面積 面積	351.683323 175.84	-351.683323 175.84			53.431

面積 (座標法) 計算書

地番 = 58-13
測点名

	[1] X (i)	[2] X (i+1)-X (i-1)	[3] Y (i)	[4] Y (i+1)-Y (i-1)	[2]*[3]	[1]*[4]	方向角	夾角	距離
58-51K	-149979.541	-10.204	-41069.923	-15.592	419077.494292	2338481.003272	178-52-15	89-59-58	9.895
58-8	-149989.434	-12.812	-41069.728	3.265	526185.355136	-489715.502010	133-33-21	134-41-06	4.236
58-7	-149992.353	-2.586	-41066.658	15.856	106198.377588	-2378278.749168	88-30-29	134-57-08	12.790
58-20	-149992.020	13.123	-41053.872	12.522	-538749.962256	-1878200.074440	358-49-03	90-18-34	12.793
58-54K	-149979.230	12.479	-41054.136	-16.051	-512314.563144	2407316.620730	268-52-17	90-03-14	15.790
合計				倍面積 面積	396.701616 198.35	-396.701616 198.35			55.504

面積 (座標法) 計算書

地番 = 58-14
測点名

	[1] X (i)	[2] X (i+1)-X (i-1)	[3] Y (i)	[4] Y (i+1)-Y (i-1)	[2]*[3]	[1]*[4]	方向角	夾角	距離
58-39	-149951.107	-9.399	-41070.482	15.987	386021.460318	-2397268.347609	88-49-43	89-57-15	15.799
58-40K	-149950.784	1.718	-41054.686	15.769	-70531.950548	-2364573.912896	358-53-28	90-03-45	1.395
58-47	-149949.389	9.018	-41054.713	-0.179	-370231.401834	26840.940631	358-51-28	179-58-00	7.625
58-46K	-149941.766	8.004	-41054.865	-15.960	-328603.139460	2393070.585360	271-22-50	92-31-22	15.813
58-45K	-149941.385	-9.341	-41070.673	-15.617	383641.156493	2341634.609545	178-52-28	87-29-38	9.724
合計				倍面積 面積	296.124969 148.06	-296.124969 148.06			50.356

面積 (座標法) 計算書

地番 = 58-15
測点名

	[1] X (i)	[2] X (i+1)-X (i-1)	[3] Y (i)	[4] Y (i+1)-Y (i-1)	[2]*[3]	[1]*[4]	方向角	夾角	距離
58-42K	-149939.184	-13.476	-41064.090	3.883	553379.676840	-582213.851472	91-22-53	92-33-29	3.609
58-23	-149939.271	13.658	-41060.482	3.325	-560804.063156	-498548.076075	358-49-14	87-26-21	13.748
58-9	-149925.526	13.476	-41060.765	-3.883	-553334.869140	582160.817458	265-43-36	86-54-22	3.610
58-41K	-149925.795	-13.658	-41064.365	-3.325	560857.097170	498503.268375	178-49-24	93-05-48	13.392
合計				倍面積 面積	97.841714 48.92	-97.841714 48.92			34.359

面積 (座標法) 計算書

地番 = 58-17
測点名

	[1] X (i)	[2] X (i+1)-X (i-1)	[3] Y (i)	[4] Y (i+1)-Y (i-1)	[2]*[3]	[1]*[4]	方向角	夾角	距離
58-18	-149979.427	2.006	-41037.001	17.171	-82320.224006	-2575296.741017	1-44-24	93-09-55	1.581
58-162	-149977.847	1.141	-41036.953	-17.155	-46823.163373	2572869.965285	268-32-18	86-47-54	17.209
58-161	-149978.286	-2.006	-41054.156	-17.171	82354.636936	2575277.148906	178-49-48	90-17-30	1.567
58-34K	-149979.853	-1.141	-41054.124	17.155	46842.755484	-2572904.378215	88-34-29	89-44-41	17.128
合計				倍面積 面積	54.005041 27.00	-54.005041 27.00			37.485

面積 (座標法) 計算書

地番 = 58-18
測点名

	[1] X (i)	[2] X (i+1)-X (i-1)	[3] Y (i)	[4] Y (i+1)-Y (i-1)	[2] * [3]	[1] * [4]	方向角	夾角	距離
58-46K	-149941.766	1.981	-41054.865	15.761	-81329.687565	-2363232.173926	358-51-36	87-28-46	2.362
58-30	-149939.404	2.495	-41054.912	-5.617	-102432.005440	842209.632268	271-22-04	92-30-28	5.572
58-23	-149939.271	0.381	-41060.482	-15.807	-15644.043642	2370090.056697	271-23-16	180-01-12	10.240
58-22	-149939.023	-2.114	-41070.719	-10.191	86823.499966	1528028.583393	178-53-03	87-29-47	2.362
58-45K	-149941.385	-2.743	-41070.673	15.854	112656.856039	-2377170.717790	91-22-50	92-29-47	15.813
合計				倍面積 面積	74.619358 37.30	-74.619358 37.30			36.349

面積 (座標法) 計算書

地番 = 58-19
測点名

	[1] X (i)	[2] X (i+1)-X (i-1)	[3] Y (i)	[4] Y (i+1)-Y (i-1)	[2] * [3]	[1] * [4]	方向角	夾角	距離
58-16	-149953.652	3.517	-41036.229	18.532	-144324.417393	-2778941.078864	1-47-02	90-32-21	3.919
58-48	-149949.735	4.263	-41036.107	-18.484	-174936.924141	2771670.901740	271-03-55	89-16-53	18.609
58-47	-149949.389	-3.517	-41054.713	-18.532	144389.425621	2778862.076948	178-54-09	87-50-14	3.864
58-32K	-149953.252	-4.263	-41054.639	18.484	175015.926057	-2771735.909968	91-14-41	92-20-32	18.414
合計				倍面積 面積	144.010144 72.00	-144.010144 72.00			44.806

面積 (座標法) 計算書

地番 = 58-20
測点名

	[1] X (i)	[2] X (i+1)-X (i-1)	[3] Y (i)	[4] Y (i+1)-Y (i-1)	[2] * [3]	[1] * [4]	方向角	夾角	距離
58-52K	-149953.193	-26.658	-41070.441	-15.277	1094855.816178	2290834.929461	178-52-25	89-59-53	26.353
58-51K	-149979.541	-26.037	-41069.923	16.305	1069337.585151	-2445416.416005	88-52-17	89-59-52	15.790
58-54K	-149979.230	1.255	-41054.136	15.767	-51522.940680	-2364722.519410	358-47-11	89-54-54	0.944
58-161	-149978.286	26.347	-41054.156	-0.510	-1081653.848132	76488.925860	358-53-42	180-06-31	25.408
58-53K	-149952.883	25.093	-41054.646	-16.285	-1030184.232078	2441982.699655	268-52-32	89-58-50	15.798
合計				倍面積 面積	832.380439 416.19	-832.380439 416.19			84.293

面積 (座標法) 計算書

地番 = 58-21
測点名

	[1] X (i)	[2] X (i+1)-X (i-1)	[3] Y (i)	[4] Y (i+1)-Y (i-1)	[2] * [3]	[1] * [4]	方向角	夾角	距離
58-53K	-149952.883	2.409	-41054.646	15.755	-98900.642214	-2362507.671665	358-54-30	90-01-58	2.099
58-40K	-149950.784	1.776	-41054.686	-15.836	-72913.122336	2374620.615424	268-49-43	89-55-13	15.799
58-39	-149951.107	-2.409	-41070.482	-15.755	98938.791138	2362479.690785	178-52-26	90-02-43	2.086
58-52K	-149953.193	-1.776	-41070.441	15.836	72941.103216	-2374658.764348	88-52-32	90-00-06	15.798
合計				倍面積 面積	66.129804 33.06	-66.129804 33.06			35.782