

60街区

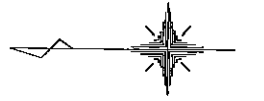

S = 1 / 250

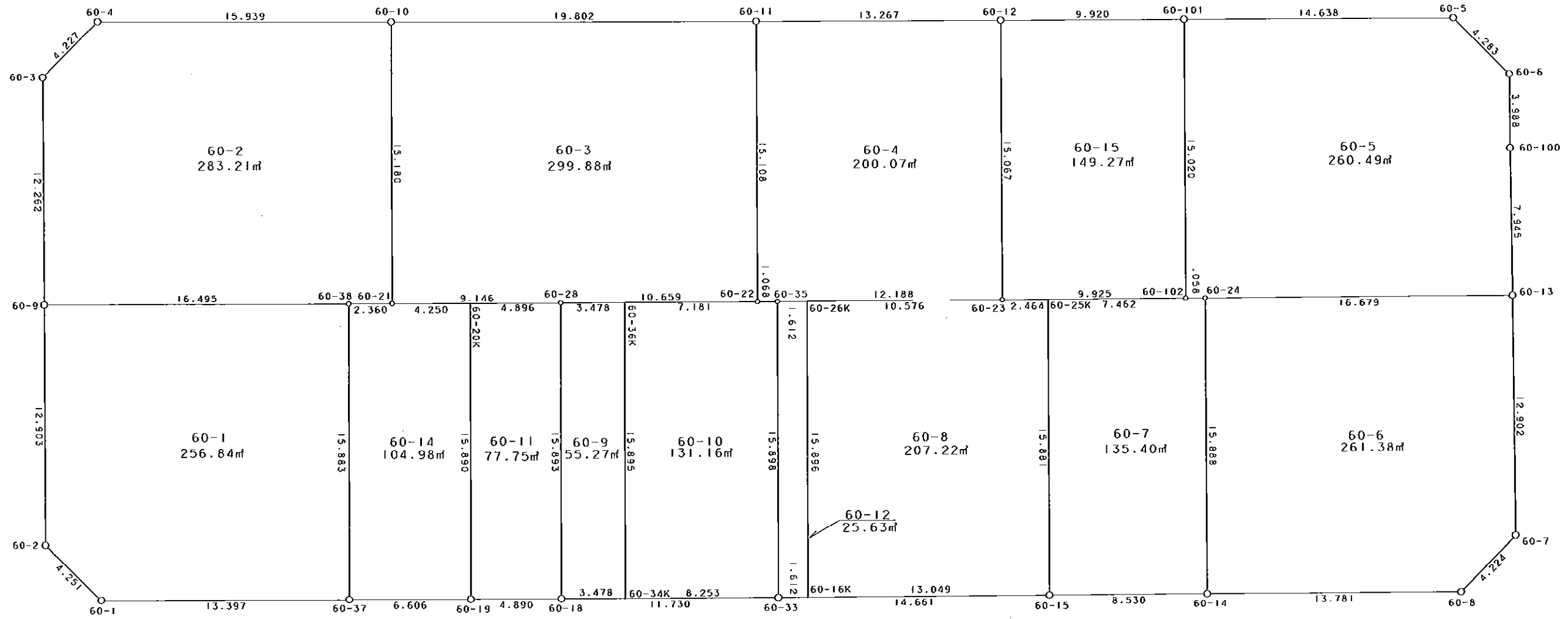

凡 例

記号	名称
⊙	地区界点
○	街区点
○	画地点 (折れ点)
┆	画地点 (直線中)

面積 (座標法) 計算書

地番 = 60街区

測点名	[1] X (i)	[2] X (i+1)-X (i-1)	[3] Y (i)	[4] Y (i+1)-Y (i-1)	[2] * [3]	[1] * [4]	方向角	夾角	距離
60-2	-149998.328	-3.403	-41066.555	-15.817	139749.486665	2372523.553976	223-21-03	134-44-11	4.251
60-1	-150001.419	-16.485	-41069.473	-2.659	677030.262405	398853.773121	178-53-32	135-32-29	13.397
60-37	-150014.813	-19.999	-41069.214	0.384	821343.210786	-57605.688192	178-54-57	180-01-25	6.606
60-19	-150021.418	-11.494	-41069.089	0.219	472048.108966	-32854.690542	178-53-55	179-58-58	4.890
60-18	-150026.307	-16.617	-41068.995	0.318	682443.489915	-47708.365626	178-54-21	180-00-26	11.730
60-33	-150038.035	-26.386	-41068.771	0.519	1083640.591606	-77869.740165	178-50-49	179-56-28	14.661
60-15	-150052.693	-23.186	-41068.476	0.464	952213.684536	-69624.449552	178-51-53	180-01-04	8.530
60-14	-150061.221	-22.306	-41068.307	0.432	916069.655942	-64826.447472	178-54-23	180-02-30	13.781
60-8	-150074.999	-16.692	-41068.044	3.321	685507.790448	-498399.071679	133-37-07	134-42-44	4.224
60-7	-150077.913	-2.581	-41064.986	15.956	105988.728866	-2394643.179828	88-31-16	134-54-09	12.902
60-13	-150077.580	0.563	-41052.088	20.840	-23112.325544	-3127616.767200	88-20-28	179-49-12	7.945
60-100	-150077.350	0.322	-41044.146	11.929	-13216.215012	-1790272.708150	88-40-41	180-20-13	3.988
60-6	-150077.258	3.169	-41040.159	6.967	-130056.263871	-1045588.256486	44-04-57	135-24-16	4.283
60-5	-150074.181	17.713	-41037.179	2.730	-726891.551627	-409702.514130	359-01-17	134-56-20	14.638
60-101	-150059.545	24.555	-41037.429	-0.405	-1007674.069095	60774.115725	359-06-17	180-05-00	9.920
60-12	-150049.626	23.184	-41037.584	-0.363	-951415.347456	54468.014238	359-06-06	179-59-49	13.267
60-11	-150036.361	33.064	-41037.792	-0.525	-1356873.554688	78769.089525	359-04-58	179-58-52	19.802
60-10	-150016.562	35.736	-41038.109	-0.557	-1466537.863224	83559.225034	359-08-14	180-03-16	15.939
60-4	-150000.625	18.864	-41038.349	-3.289	-774147.415536	493352.055625	313-49-50	134-41-36	4.227
60-3	-149997.698	2.609	-41041.398	-15.307	-107077.007382	2296014.763286	268-30-50	134-41-00	12.262
60-9	-149998.016	-0.630	-41053.656	-25.157	25863.803280	3773500.088512	268-36-52	180-06-02	12.903
合計					4897.199980	-4897.199980			214.146
				倍面積	2448.59	2448.59			
				面積					

地番	筆種別	面積	坪数
60-1	筆界	256.84	77.69
60-2	筆界	283.21	85.67
60-3	筆界	299.88	90.71
60-4	筆界	200.07	60.52
60-5	筆界	260.49	78.79
60-6	筆界	261.38	79.06
60-7	筆界	135.40	40.95
60-8	筆界	207.22	62.68
60-9	筆界	55.27	16.72
60-10	筆界	131.16	39.67
60-11	筆界	77.75	23.52
60-12	筆界	25.63	7.75
60-14	筆界	104.98	31.75
60-15	筆界	149.27	45.15
	筆合	2448.55	740.63

面積 (座標法) 計算書

地番 = 60-1
測点名

	[1] X (i)	[2] X (i+1)-X (i-1)	[3] Y (i)	[4] Y (i+1)-Y (i-1)	[2] * [3]	[1] * [4]	方向角	夾角	距離
60-2	-149998.328	-3.403	-41066.555	-15.817	139749.486665	2372523.553976	223-21-03	134-44-11	4.251
60-1	-150001.419	-16.485	-41069.473	-2.659	677030.262405	398853.773121	178-53-32	135-32-29	13.397
60-37	-150014.813	-13.089	-41069.214	16.139	537554.942046	-2421089.067007	88-53-59	90-00-27	15.883
60-38	-150014.508	16.797	-41053.334	15.558	-689572.851198	-2333925.715464	358-52-53	89-58-54	16.495
60-9	-149998.016	16.180	-41053.656	-13.221	-664248.154080	1983123.769536	268-36-52	89-43-59	12.903
合計				倍面積 面積	513.685838 256.84	-513.685838 256.84			62.929

面積 (座標法) 計算書

地番 = 60-2
測点名

	[1] X (i)	[2] X (i+1)-X (i-1)	[3] Y (i)	[4] Y (i+1)-Y (i-1)	[2] * [3]	[1] * [4]	方向角	夾角	距離
60-9	-149998.016	-16.810	-41053.656	-11.936	690111.957360	1790376.318976	178-52-53	90-22-03	16.495
60-38	-150014.508	-18.852	-41053.334	0.370	773937.452568	-55505.367960	178-50-05	179-57-12	2.360
60-21	-150016.868	-2.054	-41053.286	15.225	84323.449444	-2284006.815300	88-50-42	90-00-37	15.180
60-10	-150016.562	16.243	-41038.109	14.937	-666582.004487	-2240797.386594	359-08-14	90-17-32	15.939
60-4	-150000.625	18.864	-41038.349	-3.289	-774147.415536	493352.055625	313-49-50	134-41-36	4.227
60-3	-149997.698	2.609	-41041.398	-15.307	-107077.007382	2296014.763286	268-30-50	134-41-00	12.262
合計				倍面積 面積	566.431967 283.21	-566.431967 283.21			66.463

面積 (座標法) 計算書

地番 = 60-3
測点名

	[1] X (i)	[2] X (i+1)-X (i-1)	[3] Y (i)	[4] Y (i+1)-Y (i-1)	[2] * [3]	[1] * [4]	方向角	夾角	距離
60-21	-150016.868	-9.450	-41053.286	-14.996	387953.552700	2249652.952528	178-51-58	90-01-16	9.146
60-28	-150026.012	-19.801	-41053.105	0.389	812892.532105	-58360.118668	178-52-55	180-00-57	10.659
60-22	-150036.669	-10.349	-41052.897	15.313	424856.431053	-2297511.512397	88-49-55	89-57-00	15.108
60-11	-150036.361	20.107	-41037.792	14.788	-825146.883744	-2218737.706468	359-04-58	90-15-03	19.802
60-10	-150016.562	19.493	-41038.109	-15.494	-799955.858737	2324356.611628	268-50-42	89-45-44	15.180
合計				倍面積 面積	599.773377 299.88	-599.773377 299.88			69.895

面積 (座標法) 計算書

地番 = 60-4
測点名

	[1] X (i)	[2] X (i+1)-X (i-1)	[3] Y (i)	[4] Y (i+1)-Y (i-1)	[2] * [3]	[1] * [4]	方向角	夾角	距離
60-22	-150036.669	-1.376	-41052.897	-15.084	56488.786272	2263153.115196	178-52-25	90-02-30	1.068
60-35	-150037.737	-13.254	-41052.876	0.249	544114.818504	-37359.396513	178-55-41	180-03-16	12.188
60-23	-150049.923	-11.889	-41052.648	15.292	488074.932072	-2294563.422516	88-52-14	89-56-33	15.067
60-12	-150049.626	13.562	-41037.584	14.856	-556551.714208	-2229137.243856	359-06-06	90-13-52	13.267
60-11	-150036.361	12.957	-41037.792	-15.313	-531726.670944	2297506.795993	268-49-55	89-43-49	15.108
合計				倍面積 面積	400.151696 200.07	-400.151696 200.07			56.698

面積 (座標法) 計算書

地番 = 60-5
測点名

	[1] X (i)	[2] X (i+1)-X (i-1)	[3] Y (i)	[4] Y (i+1)-Y (i-1)	[2] * [3]	[1] * [4]	方向角	夾角	距離
60-102	-150059.846	-1.359	-41052.446	-14.993	55790.274114	2249847.271078	178-42-02	89-50-56	1.058
60-24	-150060.904	-17.734	-41052.422	0.358	728023.651748	-53721.803632	178-51-09	180-09-07	16.679
60-13	-150077.580	-16.446	-41052.088	8.276	675142.639248	-1242042.052080	88-20-28	89-29-19	7.945
60-100	-150077.350	0.322	-41044.146	11.929	-13216.215012	-1790272.708150	88-40-41	180-20-13	3.988
60-6	-150077.258	3.169	-41040.159	6.967	-130056.263871	-1045588.256486	44-04-57	135-24-16	4.283
60-5	-150074.181	17.713	-41037.179	2.730	-726891.551627	-409702.514130	359-01-17	134-56-20	14.638
60-101	-150059.545	14.335	-41037.429	-15.267	-588271.544715	2290959.073515	268-51-06	89-49-49	15.020
合計					520.989885	-520.989885			63.611
				倍面積 面積	260.49	260.49			

面積 (座標法) 計算書

地番 = 60-6
測点名

	[1] X (i)	[2] X (i+1)-X (i-1)	[3] Y (i)	[4] Y (i+1)-Y (i-1)	[2] * [3]	[1] * [4]	方向角	夾角	距離
60-14	-150061.221	-14.095	-41068.307	-15.622	578857.787165	2344256.394462	178-54-23	90-02-59	13.781
60-8	-150074.999	-16.692	-41068.044	3.321	685507.790448	-498399.071679	133-37-07	134-42-44	4.224
60-7	-150077.913	-2.581	-41064.986	15.956	105988.728866	-2394643.179828	88-31-16	134-54-09	12.902
60-13	-150077.580	17.009	-41052.088	12.564	-698254.964792	-1885574.715120	358-51-09	90-19-53	16.679
60-24	-150060.904	16.359	-41052.422	-16.219	-671576.571498	2433837.801976	268-51-24	90-00-15	15.888
合計					522.770189	-522.770189			63.474
				倍面積 面積	261.38	261.38			

面積 (座標法) 計算書

地番 = 60-7
測点名

	[1] X (i)	[2] X (i+1)-X (i-1)	[3] Y (i)	[4] Y (i+1)-Y (i-1)	[2] * [3]	[1] * [4]	方向角	夾角	距離
60-15	-150052.693	-8.835	-41068.476	-15.709	362839.985460	2357177.754337	178-51-53	89-58-21	8.530
60-14	-150061.221	-8.211	-41068.307	16.054	337211.868777	-2409082.841934	88-51-24	89-59-31	15.888
60-24	-150060.904	1.375	-41052.422	15.861	-56447.080250	-2380115.998344	358-42-02	89-50-38	1.058
60-102	-150059.846	8.518	-41052.446	-0.176	-349684.735028	26410.532896	358-49-58	180-07-56	7.462
60-25K	-150052.386	7.153	-41052.598	-16.030	-293649.233494	2405339.747580	268-53-32	90-03-34	15.881
合計					270.805465	-270.805465			48.819
				倍面積 面積	135.40	135.40			

面積 (座標法) 計算書

地番 = 60-8
測点名

	[1] X (i)	[2] X (i+1)-X (i-1)	[3] Y (i)	[4] Y (i+1)-Y (i-1)	[2] * [3]	[1] * [4]	方向角	夾角	距離
60-15	-150052.693	-12.739	-41068.476	16.141	523171.315764	-2422000.517713	88-53-32	90-02-50	15.881
60-25K	-150052.386	2.770	-41052.598	15.828	-113715.696460	-2375029.165608	358-50-13	89-56-41	2.464
60-23	-150049.923	13.037	-41052.648	-0.248	-535203.371976	37212.380904	358-55-38	180-05-25	10.576
60-26K	-150039.349	10.276	-41052.846	-16.091	-421859.045496	2414283.164759	268-55-33	89-59-55	15.896
60-16K	-150039.647	-13.344	-41068.739	-15.630	548021.253216	2345119.682610	178-50-42	89-55-09	13.049
合計					414.455048	-414.455048			57.866
				倍面積 面積	207.22	207.22			

面積 (座標法) 計算書

地番 = 60-9
測点名

	[1] X (i)	[2] X (i+1)-X (i-1)	[3] Y (i)	[4] Y (i+1)-Y (i-1)	[2] * [3]	[1] * [4]	方向角	夾角	距離
60-36K	-150029.489	3.772	-41053.037	15.824	-154852.055564	-2374066.633936	358-52-47	89-56-35	3.478
60-28	-150026.012	3.182	-41053.105	-15.958	-130630.980110	2394115.099496	268-56-11	90-03-24	15.893
60-18	-150026.307	-3.772	-41068.995	-15.824	154912.249140	2374016.281968	178-54-45	89-58-34	3.478
60-34K	-150029.784	-3.182	-41068.929	15.958	130681.332078	-2394175.293072	88-56-12	90-01-27	15.895
合計				倍面積 面積	110.545544 55.27	-110.545544 55.27			38.744

面積 (座標法) 計算書

地番 = 60-10
測点名

	[1] X (i)	[2] X (i+1)-X (i-1)	[3] Y (i)	[4] Y (i+1)-Y (i-1)	[2] * [3]	[1] * [4]	方向角	夾角	距離
60-34K	-150029.784	-8.546	-41068.929	-15.734	350975.067234	2360568.621456	178-54-11	89-57-59	8.253
60-33	-150038.035	-7.953	-41068.771	16.053	326619.935763	-2408560.575855	88-55-33	90-01-22	15.898
60-35	-150037.737	1.366	-41052.876	15.874	-56078.228616	-2381699.037138	358-52-25	89-56-52	1.068
60-22	-150036.669	8.248	-41052.897	-0.161	-338604.294456	24155.903709	358-52-59	180-00-34	7.181
60-36K	-150029.489	6.885	-41053.037	-16.032	-282650.159745	2405272.767648	268-56-12	90-03-13	15.895
合計				倍面積 面積	262.320180 131.16	-262.320180 131.16			48.295

面積 (座標法) 計算書

地番 = 60-11
測点名

	[1] X (i)	[2] X (i+1)-X (i-1)	[3] Y (i)	[4] Y (i+1)-Y (i-1)	[2] * [3]	[1] * [4]	方向角	夾角	距離
60-19	-150021.418	-5.190	-41069.089	-15.793	213148.571910	2369288.254474	178-53-55	89-59-02	4.890
60-18	-150026.307	-4.594	-41068.995	15.984	188670.963030	-2398020.491088	88-56-11	90-02-16	15.893
60-28	-150026.012	5.190	-41053.105	15.793	-213065.614950	-2369360.807516	358-51-53	89-55-42	4.896
60-20K	-150021.117	4.594	-41053.202	-15.984	-188598.409988	2397937.534128	268-54-53	90-03-00	15.890
合計				倍面積 面積	155.510002 77.75	-155.510002 77.75			41.569

面積 (座標法) 計算書

地番 = 60-12
測点名

	[1] X (i)	[2] X (i+1)-X (i-1)	[3] Y (i)	[4] Y (i+1)-Y (i-1)	[2] * [3]	[1] * [4]	方向角	夾角	距離
60-26K	-150039.349	1.910	-41052.846	15.863	-78410.935860	-2380074.193187	358-56-02	90-00-29	1.612
60-35	-150037.737	1.314	-41052.876	-15.925	-53943.479064	2389350.961725	268-55-33	89-59-31	15.898
60-33	-150038.035	-1.910	-41068.771	-15.863	78441.352610	2380053.349205	178-51-46	89-56-13	1.612
60-16K	-150039.647	-1.314	-41068.739	15.925	53964.323046	-2389381.378475	88-55-33	90-03-47	15.896
合計				倍面積 面積	51.260732 25.63	-51.260732 25.63			35.018

面積 (座標法) 計算書

地番 = 60-14

測点名	[1] X (i)	[2] X (i+1)-X (i-1)	[3] Y (i)	[4] Y (i+1)-Y (i-1)	[2] * [3]	[1] * [4]	方向角	夾 角	距 離
60-19	-150021.418	-6.304	-41069.089	16.012	258899.537056	-2402142.945016	88-54-53	89-59-56	15.890
60-20K	-150021.117	4.550	-41053.202	15.803	-186792.069100	-2370783.711951	358-52-03	89-57-10	4.250
60-21	-150016.868	6.609	-41053.286	-0.132	-271321.167174	19802.226576	358-50-05	179-58-02	2.360
60-38	-150014.508	2.055	-41053.334	-15.928	-84364.601370	2389431.083424	268-53-59	90-03-54	15.883
60-37	-150014.813	-6.910	-41069.214	-15.755	283788.268740	2363483.378815	178-54-57	90-00-58	6.606
合計				倍面積 面積	209.968152 104.98	-209.968152 104.98			44.989

面積 (座標法) 計算書

地番 = 60-15

測点名	[1] X (i)	[2] X (i+1)-X (i-1)	[3] Y (i)	[4] Y (i+1)-Y (i-1)	[2] * [3]	[1] * [4]	方向角	夾 角	距 離
60-101	-150059.545	10.220	-41037.429	14.862	-419402.524380	-2230184.957790	359-06-17	90-15-11	9.920
60-12	-150049.626	9.622	-41037.584	-15.219	-394863.633248	2283605.258094	268-52-14	89-45-57	15.067
60-23	-150049.923	-10.220	-41052.648	-14.862	419558.062560	2230041.955626	178-50-02	89-57-48	9.925
60-102	-150059.846	-9.622	-41052.446	15.219	395006.635412	-2283760.796274	88-51-06	90-01-04	15.020
合計				倍面積 面積	298.540344 149.27	-298.540344 149.27			49.932