

西部第4地区十地区画整理事業 出来形確認測量 (原子図)

45-2街区

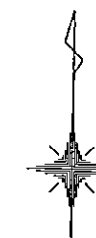

S = 1 / 250

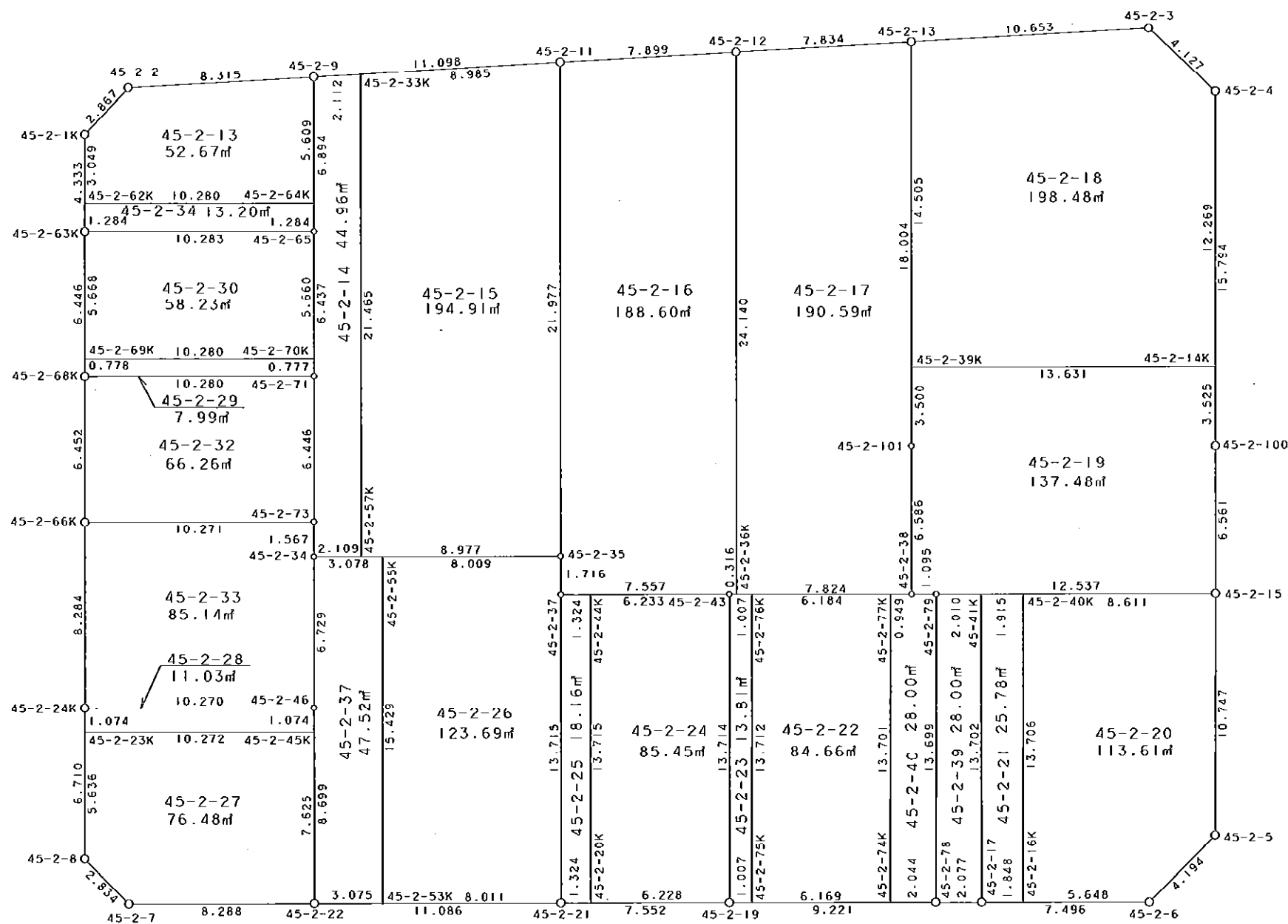

凡 例

記号	名称
⊙	地区界点
○	街区点
○	画地点 (折れ点)
└	画地点 (直線中)

面積 (座標法) 計算書

地番 = 45-2街区

測点名	[1] X (i)	[2] X (i+1)-X (i-1)	[3] Y (i)	[4] Y (i+1)-Y (i-1)	[2]*[3]	[1]*[4]	方向角	夾角	距離
45-2-2	-149901.411	-2.754	-41218.228	-10.216	113514.999912	1531392.814776	222-11-11	136-31-54	2.867
45-2-1K	-149903.535	-6.456	-41220.153	-1.844	266117.307768	276422.118540	178-55-44	136-44-33	4.333
45-2-63K	-149907.867	-10.777	-41220.072	0.206	444228.715944	-30881.020602	178-53-20	179-57-36	6.446
45-2-68K	-149914.312	-12.896	-41219.947	0.248	531572.436512	-37178.749376	178-54-28	180-01-08	6.452
45-2-66K	-149920.763	-14.734	-41219.824	0.278	607332.886816	-41677.972114	178-55-41	180-01-13	8.284
45-2-24K	-149929.046	-14.992	-41219.669	0.278	617965.277648	-41680.274788	178-56-59	180-01-18	6.710
45-2-8	-149935.755	-8.676	-41219.546	2.163	357620.781096	-324311.038065	133-57-23	135-00-24	2.834
45-2-7	-149937.722	-1.791	-41217.506	10.326	73820.553246	-1548256.917372	88-46-59	134-49-36	8.288
45-2-22	-149937.546	0.389	-41209.220	19.370	-16030.386580	-2904290.266020	88-53-57	180-06-58	11.086
45-2-21	-149937.333	0.358	-41198.136	18.635	-14748.932688	-2794082.200455	88-54-00	180-00-03	7.552
45-2-19	-149937.188	0.324	-41190.585	16.770	-13345.749540	-2514446.642760	88-53-16	179-59-16	9.221
45-2-78	-149937.009	0.218	-41181.366	11.296	-8977.537788	-1693688.453664	88-55-27	180-02-11	2.077
45-2-17	-149936.970	0.177	-41179.289	9.572	-7288.734153	-1435196.676840	88-56-43	180-01-16	7.496
45-2-6	-149936.832	3.166	-41171.794	10.397	-130349.899804	-1558893.242304	43-46-58	134-50-15	4.194
45-2-5	-149933.804	13.773	-41168.892	2.722	-567019.149516	-408119.814488	359-02-25	135-15-27	10.747
45-2-15	-149923.059	17.305	-41169.072	-0.313	-712430.790960	46925.917467	358-50-19	179-47-54	6.561
45-2-100	-149916.499	22.351	-41169.205	-0.433	-920172.900955	64913.844067	358-54-42	180-04-23	15.794
45-2-4	-149900.708	18.563	-41169.505	-3.357	-764229.521315	503216.676756	312-12-03	133-17-21	4.127
45-2-3	-149897.936	1.961	-41172.562	-13.679	-80739.394082	2050453.866544	265-38-02	133-25-59	10.653
45-2-13	-149898.747	-1.399	-41183.184	-18.434	57615.274416	2763233.502198	265-41-44	180-03-42	7.834
45-2-12	-149899.335	-1.185	-41190.996	-15.688	48811.330260	2351620.767480	265-39-55	179-58-11	7.899
45-2-11	-149899.932	-1.446	-41198.872	-18.941	59573.568912	2839254.612012	265-36-45	179-56-50	11.098
45-2-9	-149900.781	-1.479	-41209.937	-19.356	60949.496823	2901479.517036	265-39-17	180-02-32	8.315
合計				倍面積 面積	3789.631972 1894.81	-3789.631972 1894.81			170.868

地番	筆種別	面積	坪数
45-2-13	筆界	52.67	15.93
45-2-14	筆界	44.96	13.60
45-2-15	筆界	194.91	58.96
45-2-16	筆界	188.60	57.05
45-2-17	筆界	190.59	57.65
45-2-18	筆界	198.48	60.04
45-2-19	筆界	137.48	41.58
45-2-20	筆界	113.61	34.36
45-2-21	筆界	25.78	7.80
45-2-22	筆界	84.66	25.60
45-2-23	筆界	13.81	4.17
45-2-24	筆界	85.45	25.84
45-2-25	筆界	18.16	5.49
45-2-26	筆界	123.69	37.41
45-2-27	筆界	76.48	23.13
45-2-28	筆界	11.03	3.33
45-2-29	筆界	7.99	2.41
45-2-30	筆界	58.23	17.61
45-2-32	筆界	66.26	20.04
45-2-33	筆界	85.14	25.75
45-2-34	筆界	13.20	3.99
45-2-37	筆界	47.52	14.37
45-2-39	筆界	28.00	8.47
45-2-40	筆界	28.00	8.47
	合	1894.70	573.05

面積 (座標法) 計算書

地番 = 45-2-13

測点名	[1] X (i)	[2] X (i+1)-X (i-1)	[3] Y (i)	[4] Y (i+1)-Y (i-1)	[2] * [3]	[1] * [4]	方向角	夾角	距離
45-2-64K	-149906.389	5.802	-41209.818	10.159	-239099.364036	-1522899.005851	358-47-04	89-51-57	5.609
45-2-9	-149900.781	4.978	-41209.937	-8.410	-205143.066386	1260665.568210	265-39-17	86-52-13	8.315
45-2-2	-149901.411	-2.754	-41218.228	-10.216	113514.999912	1531392.814776	222-11-11	136-31-54	2.867
45-2-1K	-149903.535	-5.172	-41220.153	-1.868	213190.631316	280019.803380	178-55-43	136-44-32	3.049
45-2-62K	-149906.583	-2.854	-41220.096	10.335	117642.153984	-1549284.535305	88-55-07	89-59-24	10.280
合計				倍面積 面積	105.354790 52.67	-105.354790 52.67			30.120

面積 (座標法) 計算書

地番 = 45-2-14

測点名	[1] X (i)	[2] X (i+1)-X (i-1)	[3] Y (i)	[4] Y (i+1)-Y (i-1)	[2] * [3]	[1] * [4]	方向角	夾角	距離
45-2-33K	-149900.619	21.299	-41207.831	-2.519	-877685.592469	377599.659261	265-36-05	86-42-14	2.112
45-2-9	-149900.781	-7.054	-41209.937	-1.960	290694.895598	293805.530760	178-47-11	93-11-06	6.894
45-2-65	-149907.673	-13.328	-41209.791	0.268	549244.094448	-40175.256364	178-54-51	180-07-40	6.437
45-2-71	-149914.109	-12.881	-41209.669	0.236	530821.746389	-35379.729724	178-59-12	180-04-21	6.446
45-2-73	-149920.554	-8.012	-41209.555	0.142	330170.954660	-21288.718668	178-58-35	179-59-23	1.567
45-2-34	-149922.121	-1.526	-41209.527	2.137	62885.738202	-320383.572577	88-53-11	89-54-36	2.109
45-2-57K	-149922.080	21.502	-41207.418	1.696	-886041.901836	-254267.847680	358-53-51	90-00-40	21.465
合計				倍面積 面積	89.934992 44.96	-89.934992 44.96			47.030

面積 (座標法) 計算書

地番 = 45-2-15

測点名	[1] X (i)	[2] X (i+1)-X (i-1)	[3] Y (i)	[4] Y (i+1)-Y (i-1)	[2] * [3]	[1] * [4]	方向角	夾角	距離
45-2-57K	-149922.080	-21.286	-41207.418	9.388	877141.099548	-1407468.487040	88-52-59	89-59-08	8.977
45-2-35	-149921.905	22.148	-41198.443	8.546	-912463.115564	-1281232.600130	358-52-53	89-59-54	21.977
45-2-11	-149899.932	21.286	-41198.872	-9.388	-876959.189392	1407260.561616	265-36-54	86-44-01	8.985
45-2-33K	-149900.619	-22.148	-41207.831	-8.546	912671.040988	1281050.689974	178-53-51	93-16-57	21.465
合計				倍面積 面積	389.835580 194.91	-389.835580 194.91			61.404

面積 (座標法) 計算書

地番 = 45-2-16

測点名	[1] X (i)	[2] X (i+1)-X (i-1)	[3] Y (i)	[4] Y (i+1)-Y (i-1)	[2] * [3]	[1] * [4]	方向角	夾角	距離
45-2-12	-149899.335	23.538	-41190.996	-8.348	-969553.663848	1251359.648580	265-39-55	86-47-08	7.899
45-2-11	-149899.932	-22.570	-41198.872	-7.447	929858.541040	1116304.793604	178-52-53	93-12-58	21.977
45-2-35	-149921.905	-23.688	-41198.443	0.476	975908.717784	-71362.826780	178-25-49	179-32-56	1.716
45-2-37	-149923.620	-1.571	-41198.396	7.603	64722.680116	-1139869.282860	88-54-30	90-28-41	7.557
45-2-43	-149923.476	0.150	-41190.840	7.872	-6178.626000	-1180197.603072	88-54-44	180-00-14	0.316
45-2-36K	-149923.470	24.141	-41190.524	-0.156	-994380.439884	23388.061320	358-52-47	89-58-03	24.140
合計				倍面積 面積	377.209208 188.60	-377.209208 188.60			63.605

面積 (座標法) 計算書

地番 = 45-2-17

測点名	[1] X (i)	[2] X (i+1)-X (i-1)	[3] Y (i)	[4] Y (i+1)-Y (i-1)	[2] * [3]	[1] * [4]	方向角	夾角	距離
45-2-12	-149899.335	-24.723	-41190.996	-7.340	1018364.994108	1100261.118900	178-52-47	93-11-03	24.140
45-2-36K	-149923.470	-23.998	-41190.524	8.295	988490.194952	-1243615.183650	88-59-48	90-07-01	7.824
45-2-38	-149923.333	6.722	-41182.701	7.692	-276830.116122	-1153210.277436	358-51-37	89-51-49	6.586
45-2-101	-149916.748	24.586	-41182.832	-0.483	-1012521.107552	72409.789284	358-52-47	180-01-10	18.004
45-2-13	-149898.747	17.413	-41183.184	-8.164	-717122.782992	1223773.370508	265-41-44	86-48-57	7.834
合計				倍面積 面積	381.182394 190.59	-381.182394 190.59			64.388

面積 (座標法) 計算書

地番 = 45-2-18

測点名	[1] X (i)	[2] X (i+1)-X (i-1)	[3] Y (i)	[4] Y (i+1)-Y (i-1)	[2] * [3]	[1] * [4]	方向角	夾角	距離
45-2-14K	-149912.975	12.541	-41169.272	13.395	-516303.840152	-2008084.300125	358-54-43	90-03-50	12.269
45-2-4	-149900.708	15.039	-41169.505	-3.290	-619148.185695	493173.329320	312-12-03	133-17-20	4.127
45-2-3	-149897.936	1.961	-41172.562	-13.679	-80739.394082	2050453.866544	265-38-02	133-25-59	10.653
45-2-13	-149898.747	-15.313	-41183.184	-10.338	630638.096592	1549653.246486	178-52-41	93-14-39	14.505
45-2-39K	-149913.249	-14.228	-41182.900	13.912	585950.301200	-2085593.120088	88-50-53	89-58-12	13.631
合計				倍面積 面積	396.977863 198.48	-396.977863 198.48			55.185

面積 (座標法) 計算書

地番 = 45-2-19

測点名	[1] X (i)	[2] X (i+1)-X (i-1)	[3] Y (i)	[4] Y (i+1)-Y (i-1)	[2] * [3]	[1] * [4]	方向角	夾角	距離
45-2-39K	-149913.249	-3.773	-41182.900	-13.560	155383.081700	2032823.656440	178-53-12	90-02-19	3.500
45-2-101	-149916.748	-10.084	-41182.832	0.199	415287.677888	-29833.432852	178-51-37	179-58-25	6.586
45-2-38	-149923.333	-6.564	-41182.701	1.226	270323.249364	-183806.006258	88-54-05	90-02-28	1.095
45-2-79	-149923.312	0.274	-41181.606	13.629	-11283.760044	-2043304.819248	88-50-37	179-56-32	12.537
45-2-15	-149923.059	6.813	-41169.072	12.401	-280484.887536	-1859195.854659	358-50-19	89-59-42	6.561
45-2-100	-149916.499	10.084	-41169.205	-0.200	-415150.263220	29983.299800	358-54-39	180-04-20	3.525
45-2-14K	-149912.975	3.250	-41169.272	-13.695	-133800.134000	2053058.192625	268-50-53	89-56-14	13.631
合計				倍面積 面積	274.964152 137.48	-274.964152 137.48			47.435

面積 (座標法) 計算書

地番 = 45-2-20

測点名	[1] X (i)	[2] X (i+1)-X (i-1)	[3] Y (i)	[4] Y (i+1)-Y (i-1)	[2] * [3]	[1] * [4]	方向角	夾角	距離
45-2-16K	-149936.936	-13.600	-41177.441	5.887	560013.197600	-882678.742232	88-56-42	89-56-54	5.648
45-2-6	-149936.832	3.132	-41171.794	8.549	-128950.058808	-1281809.976768	43-46-58	134-50-16	4.194
45-2-5	-149933.804	13.773	-41168.892	2.722	-567019.149516	-408119.814488	359-02-25	135-15-27	10.747
45-2-15	-149923.059	10.572	-41169.072	-8.789	-435239.429184	1317673.765551	268-50-56	89-48-31	8.611
45-2-40K	-149923.232	-13.877	-41177.681	-8.369	571422.679237	1254707.528608	178-59-48	90-08-52	13.706
合計				倍面積 面積	227.239329 113.61	-227.239329 113.61			42.906

面積 (座標法) 計算書

地番 = 45-2-21

測点名	[1] X (i)	[2] X (i+1)-X (i-1)	[3] Y (i)	[4] Y (i+1)-Y (i-1)	[2] * [3]	[1] * [4]	方向角	夾角	距離
45-2-40K	-149923.232	13.665	-41177.681	-2.155	-562693.010865	323084.564960	268-50-00	89-50-12	1.915
45-41K	-149923.271	-13.738	-41179.596	-1.608	565725.289848	241076.619768	178-42-58	89-52-58	13.702
45-2-17	-149936.970	-13.665	-41179.289	2.155	562714.984185	-323114.170350	88-56-46	90-13-48	1.848
45-2-16K	-149936.936	13.738	-41177.441	1.608	-565695.684458	-241098.593088	358-59-48	90-03-02	13.706
合計				倍面積 面積	51.578710 25.78	-51.578710 25.78			31.171

面積 (座標法) 計算書

地番 = 45-2-22

測点名	[1] X (i)	[2] X (i+1)-X (i-1)	[3] Y (i)	[4] Y (i+1)-Y (i-1)	[2] * [3]	[1] * [4]	方向角	夾角	距離
45-2-77K	-149923.350	13.591	-41183.650	-6.423	-559726.987150	962957.677050	268-59-57	90-00-10	6.184
45-2-76K	-149923.458	-13.818	-41189.833	-5.928	569161.112394	888746.259024	178-56-04	89-56-07	13.712
45-2-75K	-149937.168	-13.591	-41189.578	6.423	559807.554598	-963046.430064	88-53-41	89-57-37	6.169
45-2-74K	-149937.049	13.818	-41183.410	5.928	-569072.359380	-888826.826472	358-59-47	90-06-06	13.701
合計				倍面積 面積	169.320462 84.66	-169.320462 84.66			39.766

面積 (座標法) 計算書

地番 = 45-2-23

測点名	[1] X (i)	[2] X (i+1)-X (i-1)	[3] Y (i)	[4] Y (i+1)-Y (i-1)	[2] * [3]	[1] * [4]	方向角	夾角	距離
45-2-76K	-149923.458	13.692	-41189.833	-1.262	-563971.193436	189203.403996	268-58-33	90-02-29	1.007
45-2-43	-149923.476	-13.730	-41190.840	-0.752	565550.233200	112742.453952	178-56-05	89-57-32	13.714
45-2-19	-149937.188	-13.692	-41190.585	1.262	563981.489820	-189220.731256	88-51-44	89-55-39	1.007
45-2-75K	-149937.168	13.730	-41189.578	0.752	-565532.905940	-112752.750336	358-56-04	90-04-20	13.712
合計				倍面積 面積	27.623644 13.81	-27.623644 13.81			29.440

面積 (座標法) 計算書

地番 = 45-2-24

測点名	[1] X (i)	[2] X (i+1)-X (i-1)	[3] Y (i)	[4] Y (i+1)-Y (i-1)	[2] * [3]	[1] * [4]	方向角	夾角	距離
45-2-20K	-149937.308	-13.593	-41196.812	6.487	559988.265516	-972643.316996	88-53-46	89-58-56	6.228
45-2-19	-149937.188	13.832	-41190.585	5.972	-569748.171720	-895424.886736	358-56-05	90-02-19	13.714
45-2-43	-149923.476	13.593	-41190.840	-6.487	-559907.088120	972553.588812	268-54-22	89-58-17	6.233
45-2-44K	-149923.595	-13.832	-41197.072	-5.972	569837.899904	895343.709340	178-54-50	90-00-28	13.715
合計				倍面積 面積	170.905580 85.45	-170.905580 85.45			39.890

面積 (座標法) 計算書

地番 = 45-2-25

測点名	[1] X (i)	[2] X (i+1)-X (i-1)	[3] Y (i)	[4] Y (i+1)-Y (i-1)	[2] * [3]	[1] * [4]	方向角	夾 角	距 離
45-2-44K	-149923.595	13.688	-41197.072	-1.584	-563905.521536	237478.974480	268-55-06	90-00-16	1.324
45-2-37	-149923.620	-13.738	-41198.396	-1.064	565983.564248	159518.731680	178-54-50	89-59-44	13.715
45-2-21	-149937.333	-13.688	-41198.136	1.584	563920.085568	-237500.735472	88-55-06	90-00-16	1.324
45-2-20K	-149937.308	13.738	-41196.812	1.064	-565961.803256	-159533.295712	358-54-50	89-59-44	13.715
合計				倍面積 面積	36.325024 18.16	-36.325024 18.16			30.078

面積 (座標法) 計算書

地番 = 45-2-26

測点名	[1] X (i)	[2] X (i+1)-X (i-1)	[3] Y (i)	[4] Y (i+1)-Y (i-1)	[2] * [3]	[1] * [4]	方向角	夾 角	距 離
45-2-53K	-149937.487	-15.272	-41206.146	8.314	629300.261712	-1246580.266918	88-53-55	90-01-39	8.011
45-2-21	-149937.333	13.867	-41198.136	7.750	-571294.551912	-1162014.330750	358-54-50	90-00-55	13.715
45-2-37	-149923.620	15.428	-41198.396	-0.307	-635608.853488	46026.551340	358-25-49	179-30-59	1.716
45-2-35	-149921.905	1.559	-41198.443	-8.054	-64228.372637	1207471.022870	268-53-02	90-27-13	8.009
45-2-55K	-149922.061	-15.582	-41206.450	-7.703	642078.903900	1154849.635883	178-52-16	89-59-14	15.429
合計				倍面積 面積	247.387575 123.69	-247.387575 123.69			46.880

面積 (座標法) 計算書

地番 = 45-2-27

測点名	[1] X (i)	[2] X (i+1)-X (i-1)	[3] Y (i)	[4] Y (i+1)-Y (i-1)	[2] * [3]	[1] * [4]	方向角	夾 角	距 離
45-2-23K	-149930.120	-5.832	-41219.649	-10.167	240392.992968	1524339.530040	178-57-10	90-03-06	5.636
45-2-8	-149935.755	-7.602	-41219.546	2.143	313350.988692	-321312.322965	133-57-23	135-00-13	2.834
45-2-7	-149937.722	-1.791	-41217.506	10.326	73820.553246	-1548256.917372	88-46-59	134-49-36	8.288
45-2-22	-149937.546	7.799	-41209.220	8.127	-321390.706780	-1218542.436342	358-48-18	90-01-19	7.625
45-2-45K	-149929.923	7.426	-41209.379	-10.429	-306020.848454	1563619.166967	268-54-04	90-05-46	10.272
合計				倍面積 面積	152.979672 76.48	-152.979672 76.48			34.655

面積 (座標法) 計算書

地番 = 45-2-28

測点名	[1] X (i)	[2] X (i+1)-X (i-1)	[3] Y (i)	[4] Y (i+1)-Y (i-1)	[2] * [3]	[1] * [4]	方向角	夾 角	距 離
45-2-45K	-149929.923	1.271	-41209.379	10.248	-52377.120709	-1536481.850904	358-49-35	89-55-31	1.074
45-2-46	-149928.849	0.877	-41209.401	-10.290	-36140.644677	1542767.856210	268-54-03	90-04-28	10.270
45-2-24K	-149929.046	-1.271	-41219.669	-10.248	52390.199299	1536472.863408	178-55-59	90-01-56	1.074
45-2-23K	-149930.120	-0.877	-41219.649	10.290	36149.632173	-1542780.934800	88-54-04	89-58-05	10.272
合計				倍面積 面積	22.066086 11.03	-22.066086 11.03			22.690

面積 (座標法) 計算書

地番 = 45-2-29

測点名	[1] X (i)	[2] X (i+1)-X (i-1)	[3] Y (i)	[4] Y (i+1)-Y (i-1)	[2]*[3]	[1]*[4]	方向角	夾角	距離
45-2-69K	-149913.534	-0.980	-41219.962	-10.263	40395.562760	1538562.599442	178-53-44	90-01-17	0.778
45-2-68K	-149914.312	-0.575	-41219.947	10.293	23701.469525	-1543068.013416	88-52-07	89-58-23	10.280
45-2-71	-149914.109	0.980	-41209.669	10.263	-40385.475620	-1538568.500667	358-53-39	90-01-32	0.777
45-2-70K	-149913.332	0.575	-41209.684	-10.293	-23695.568300	1543057.926276	268-52-27	89-58-48	10.280
合計				倍面積 面積	15.988365 7.99	-15.988365 7.99			22.115

面積 (座標法) 計算書

地番 = 45-2-30

測点名	[1] X (i)	[2] X (i+1)-X (i-1)	[3] Y (i)	[4] Y (i+1)-Y (i-1)	[2]*[3]	[1]*[4]	方向角	夾角	距離
45-2-70K	-149913.332	5.861	-41209.684	10.171	-241529.957924	-1524768.499772	358-55-00	90-02-33	5.660
45-2-65	-149907.673	5.465	-41209.791	-10.388	-225211.507815	1557240.907124	268-55-08	90-00-08	10.283
45-2-63K	-149907.867	-5.861	-41220.072	-10.171	241590.841992	1524712.915257	178-53-17	89-58-09	5.668
45-2-69K	-149913.534	-5.465	-41219.962	10.388	225267.092330	-1557301.791192	88-52-27	89-59-10	10.280
合計				倍面積 面積	116.468583 58.23	-116.468583 58.23			31.891

面積 (座標法) 計算書

地番 = 45-2-32

測点名	[1] X (i)	[2] X (i+1)-X (i-1)	[3] Y (i)	[4] Y (i+1)-Y (i-1)	[2]*[3]	[1]*[4]	方向角	夾角	距離
45-2-73	-149920.554	6.654	-41209.555	10.155	-274208.378970	-1522443.225870	358-59-12	90-09-09	6.446
45-2-71	-149914.109	6.242	-41209.669	-10.392	-257230.753898	1557907.420728	268-52-07	89-52-55	10.280
45-2-68K	-149914.312	-6.654	-41219.947	-10.155	274277.527338	1522379.838360	178-54-28	90-02-21	6.452
45-2-66K	-149920.763	-6.242	-41219.824	10.392	257294.141408	-1557976.569096	88-50-03	89-55-35	10.271
合計				倍面積 面積	132.535878 66.26	-132.535878 66.26			33.449

面積 (座標法) 計算書

地番 = 45-2-33

測点名	[1] X (i)	[2] X (i+1)-X (i-1)	[3] Y (i)	[4] Y (i+1)-Y (i-1)	[2]*[3]	[1]*[4]	方向角	夾角	距離
45-2-66K	-149920.763	-8.492	-41219.824	-10.114	350038.745408	1516298.596982	178-55-41	90-05-38	8.284
45-2-24K	-149929.046	-8.086	-41219.669	10.423	333302.243534	-1562710.446458	88-54-03	89-58-22	10.270
45-2-46	-149928.849	6.925	-41209.401	10.142	-285375.101925	-1520578.386558	358-55-38	90-01-35	6.729
45-2-34	-149922.121	8.295	-41209.527	-0.154	-341833.026465	23088.006634	358-58-35	180-02-57	1.567
45-2-73	-149920.554	1.358	-41209.555	-10.297	-55962.575690	1543731.944538	268-50-03	89-51-28	10.271
合計				倍面積 面積	170.284862 85.14	-170.284862 85.14			37.121

面積 (座標法) 計算書

地番 = 45-2-34

測点名	[1] X (i)	[2] X (i+1)-X (i-1)	[3] Y (i)	[4] Y (i+1)-Y (i-1)	[2]*[3]	[1]*[4]	方向角	夾角	距離
45-2-62K	-149906.583	-1.478	-41220.096	-10.254	60923.301888	1537142.102082	178-55-45	90-00-38	1.284
45-2-63K	-149907.867	-1.090	-41220.072	10.305	44929.878480	-1544800.569435	88-55-08	89-59-23	10.283
45-2-65	-149907.673	1.478	-41209.791	10.254	-60908.071098	-1537153.278942	358-47-43	89-52-35	1.284
45-2-64K	-149906.389	1.090	-41209.818	-10.305	-44918.701620	1544785.338645	268-55-07	90-07-24	10.280
合計				倍面積 面積	26.407650 13.20	-26.407650 13.20			23.131

面積 (座標法) 計算書

地番 = 45-2-37

測点名	[1] X (i)	[2] X (i+1)-X (i-1)	[3] Y (i)	[4] Y (i+1)-Y (i-1)	[2]*[3]	[1]*[4]	方向角	夾角	距離
45-2-55K	-149922.061	15.366	-41206.450	-3.381	-633178.310700	506886.488241	268-52-58	90-00-42	3.078
45-2-34	-149922.121	-6.788	-41209.527	-2.951	279730.269276	442420.179071	178-55-38	90-02-40	6.729
45-2-46	-149928.849	-15.425	-41209.401	0.307	635655.010425	-46028.156643	178-48-28	179-52-50	8.699
45-2-22	-149937.546	-8.638	-41209.220	3.255	355965.242360	-488046.712230	88-54-02	90-05-34	3.075
45-2-53K	-149937.487	15.485	-41206.146	2.770	-638077.170810	-415326.838990	358-52-16	89-58-14	15.429
合計				倍面積 面積	95.040551 47.52	-95.040551 47.52			37.010

面積 (座標法) 計算書

地番 = 45-2-39

測点名	[1] X (i)	[2] X (i+1)-X (i-1)	[3] Y (i)	[4] Y (i+1)-Y (i-1)	[2]*[3]	[1]*[4]	方向角	夾角	距離
45-2-17	-149936.970	13.738	-41179.289	1.770	-565721.072282	-265388.436900	358-42-58	89-47-31	13.702
45-41K	-149923.271	13.658	-41179.596	-2.317	-562430.922168	347372.218907	268-49-53	90-06-55	2.010
45-2-79	-149923.312	-13.738	-41181.606	-1.770	565752.903228	265364.262240	178-59-46	90-09-53	13.699
45-2-78	-149937.009	-13.658	-41181.366	2.317	562455.096828	-347404.049853	88-55-27	89-55-41	2.077
合計				倍面積 面積	56.005606 28.00	-56.005606 28.00			31.488

面積 (座標法) 計算書

地番 = 45-2-40

測点名	[1] X (i)	[2] X (i+1)-X (i-1)	[3] Y (i)	[4] Y (i+1)-Y (i-1)	[2]*[3]	[1]*[4]	方向角	夾角	距離
45-2-74K	-149937.049	-13.659	-41183.410	2.284	562524.197190	-342456.219916	88-52-44	89-52-57	2.044
45-2-78	-149937.009	13.737	-41181.366	1.804	-565708.424742	-270486.364236	358-59-46	90-07-02	13.699
45-2-79	-149923.312	13.676	-41181.606	-1.335	-563199.643656	200147.621520	268-54-05	89-54-19	1.095
45-2-38	-149923.333	-0.038	-41182.701	-2.044	1564.942638	306443.292652	268-58-25	180-04-20	0.949
45-2-77K	-149923.350	-13.716	-41183.650	-0.709	564874.943400	106295.655150	178-59-47	90-01-22	13.701
合計				倍面積 面積	56.014830 28.00	-56.014830 28.00			31.488