

48街区

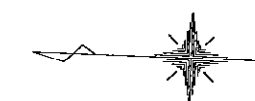

S = 1 / 250

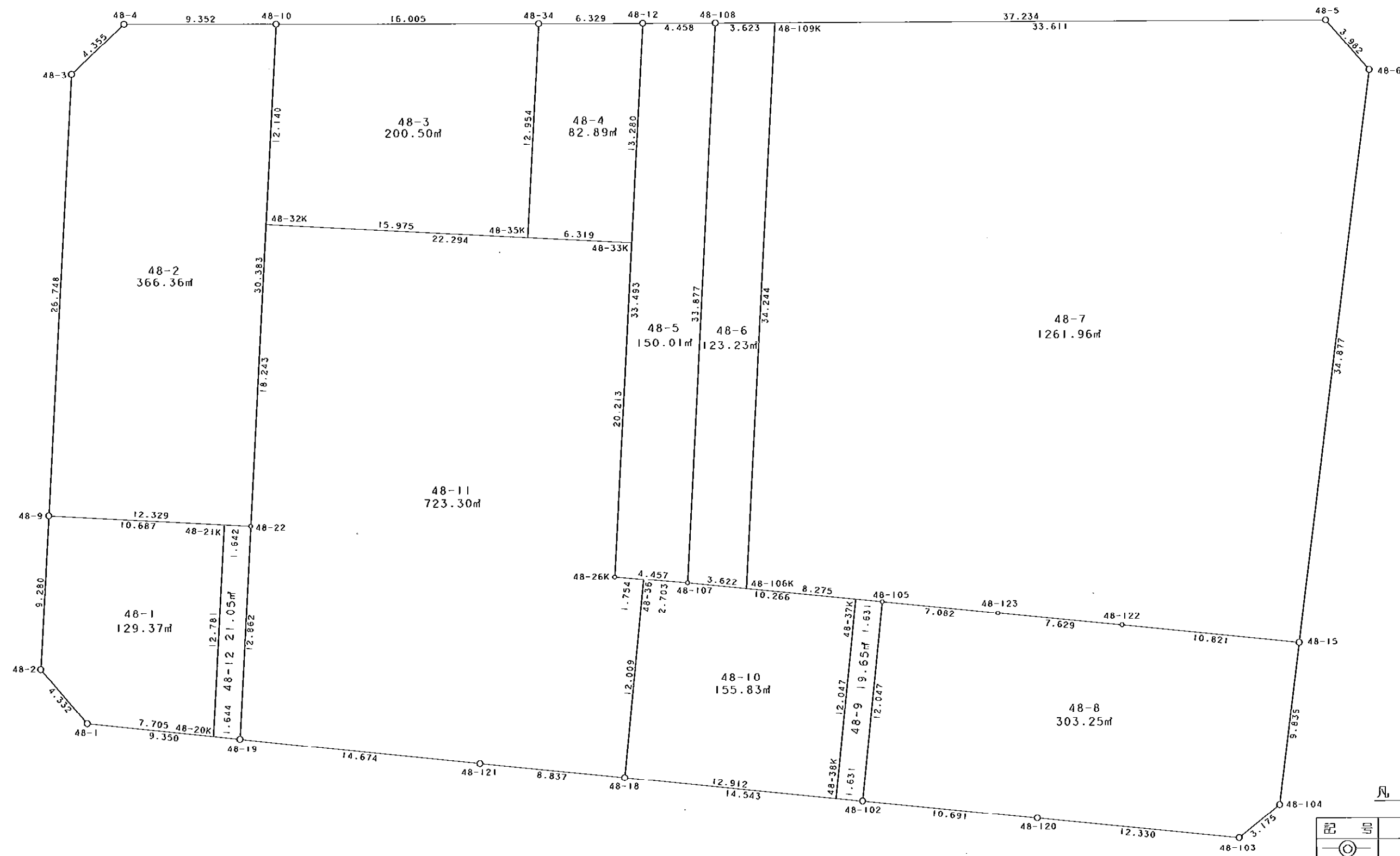

凡例

記号	名称
⊙	地区界点
○	街区点
○	画地点(折れ点)
┆	画地点(直線中)

面積 (座標法) 計算書

地番 = 48街区

測点名	[1] X (i)	[2] X (i+1)-X (i-1)	[3] Y (i)	[4] Y (i+1)-Y (i-1)	[2] * [3]	[1] * [4]	方向角	夾角	距離
48-2	-149985.700	-2.947	-41318.509	-12.416	121765.646023	1862222.451200	226-23-04	136-07-53	4.332
48-1	-149988.688	-12.324	-41321.645	-3.641	509247.952980	546108.813008	183-05-46	136-42-42	9.350
48-19	-149998.024	-23.988	-41322.150	-1.304	991235.734200	195597.423296	183-07-17	180-01-31	14.674
48-121	-150012.676	-23.477	-41322.949	-1.264	970138.873673	189616.022464	183-00-58	179-53-41	8.837
48-18	-150021.501	-23.347	-41323.414	-1.246	964777.746658	186926.790246	183-04-42	180-03-44	14.543
48-102	-150036.023	-25.198	-41324.195	-1.340	1041287.065610	201048.270820	182-59-50	179-55-08	10.691
48-120	-150046.699	-22.988	-41324.754	-1.227	949973.444952	184107.299673	183-06-20	180-06-30	12.330
48-103	-150059.011	-14.701	-41325.422	1.424	607525.028822	-213684.031664	138-47-31	135-41-11	3.175
48-104	-150061.400	-3.157	-41323.330	11.898	130457.752810	-1785430.537200	94-28-42	135-41-11	9.836
48-15	-150062.168	-3.514	-41313.524	44.575	145175.723336	-6689021.138600	94-30-57	180-02-15	34.877
48-6	-150064.914	0.016	-41278.755	37.637	-660.460080	-5647993.168218	46-04-43	131-33-46	3.982
48-5	-150062.152	39.954	-41275.887	1.105	-1649136.789198	-165818.677960	357-17-10	131-12-27	37.234
48-108	-150024.960	41.645	-41277.650	-1.971	-1719007.734250	295699.196160	357-19-32	180-02-22	4.458
48-12	-150020.507	10.775	-41277.858	-0.508	-444768.919950	76210.417556	357-16-59	179-57-27	6.329
48-34	-150014.185	22.310	-41278.158	-1.047	-920915.704980	157064.851695	357-19-30	180-02-31	16.005
48-10	-149998.197	25.330	-41278.905	-1.176	-1045594.663650	176397.879672	357-22-15	180-02-45	9.352
48-4	-149988.855	12.352	-41279.334	-3.576	-509882.333568	536360.145480	313-43-31	136-21-16	4.355
48-3	-149985.845	3.114	-41282.481	-29.895	-128553.645834	4483826.836275	270-13-22	136-29-51	26.748
48-9	-149985.741	0.145	-41309.229	-36.028	-5989.838205	5403686.276748	270-15-11	180-01-49	9.280
合計				倍面積 面積	7074.879349 3537.43	-7074.879349 3537.43			240.388

地番	筆種別	面積	坪数
48-1	筆界	129.37	39.13
48-2	筆界	366.36	110.82
48-3	筆界	200.50	60.65
48-4	筆界	82.89	25.07
48-5	筆界	150.01	45.37
48-6	筆界	123.23	37.27
48-7	筆界	1261.96	381.74
48-8	筆界	303.25	91.73
48-9	筆界	19.65	5.94
48-10	筆界	155.83	47.13
48-11	筆界	723.30	218.79
48-12	筆界計	21.05	6.36
	筆合	3537.40	1070.00

面積 (座標法) 計算書

地番 = 48-1
測点名

	[1] X (i)	[2] X (i+1)-X (i-1)	[3] Y (i)	[4] Y (i+1)-Y (i-1)	[2]*[3]	[1]*[4]	方向角	夾角	距離
48-21K	-149996.428	10.641	-41309.280	12.832	-439572.048480	-1924754.164096	0-16-24	90-04-02	10.687
48-9	-149985.741	10.728	-41309.229	-9.229	-443165.408712	1384218.403689	270-15-11	89-58-47	9.280
48-2	-149985.700	-2.947	-41318.509	-12.416	121765.646023	1862222.451200	226-23-04	136-07-53	4.332
48-1	-149988.688	-10.682	-41321.645	-3.552	441397.811890	532759.819776	183-05-41	136-42-37	7.705
48-20K	-149996.382	-7.740	-41322.061	12.365	319832.752140	-1854705.263430	90-12-22	87-06-41	12.781
合計				倍面積 面積	258.752861 129.37	-258.752861 129.37			44.785

面積 (座標法) 計算書

地番 = 48-2
測点名

	[1] X (i)	[2] X (i+1)-X (i-1)	[3] Y (i)	[4] Y (i+1)-Y (i-1)	[2]*[3]	[1]*[4]	方向角	夾角	距離
48-9	-149985.741	-12.225	-41309.229	-26.807	505005.324525	4020667.758987	180-16-27	90-03-05	12.329
48-22	-149998.070	-12.456	-41309.288	30.324	514548.491328	-4548541.474680	90-14-22	89-57-55	30.383
48-10	-149998.197	9.215	-41278.905	29.954	-380385.109575	-4493045.992938	357-22-15	87-07-53	9.352
48-4	-149988.855	12.352	-41279.334	-3.576	-509882.333568	536360.145480	313-43-31	136-21-16	4.355
48-3	-149985.845	3.114	-41282.481	-29.895	-128553.645834	4483826.836275	270-13-22	136-29-51	26.748
合計				倍面積 面積	732.726876 366.36	-732.726876 366.36			83.167

面積 (座標法) 計算書

地番 = 48-3
測点名

	[1] X (i)	[2] X (i+1)-X (i-1)	[3] Y (i)	[4] Y (i+1)-Y (i-1)	[2]*[3]	[1]*[4]	方向角	夾角	距離
48-34	-150014.185	15.924	-41278.158	12.207	-657313.387992	-1831223.156295	357-19-30	87-02-31	16.005
48-10	-149998.197	16.039	-41278.905	-12.887	-662072.357295	1933026.764739	270-14-27	92-54-57	12.140
48-32K	-149998.146	-15.924	-41291.045	-12.207	657518.600580	1831027.368222	180-14-25	89-59-58	15.975
48-35K	-150014.121	-16.039	-41291.112	12.887	662268.145368	-1933231.977327	90-16-59	90-02-34	12.954
合計				倍面積 面積	401.000661 200.50	-401.000661 200.50			57.074

面積 (座標法) 計算書

地番 = 48-4
測点名

	[1] X (i)	[2] X (i+1)-X (i-1)	[3] Y (i)	[4] Y (i+1)-Y (i-1)	[2]*[3]	[1]*[4]	方向角	夾角	距離
48-34	-150014.185	6.386	-41278.158	-13.254	-263602.316988	1988288.007990	270-16-59	93-00-00	12.954
48-35K	-150014.121	-6.255	-41291.112	-12.980	258275.905560	1947183.290580	180-14-09	89-57-10	6.319
48-33K	-150020.440	-6.386	-41291.138	13.254	263685.207268	-1988370.911760	90-17-21	90-03-12	13.280
48-12	-150020.507	6.255	-41277.858	12.980	-258193.001790	-1947266.180860	357-16-59	86-59-38	6.329
合計				倍面積 面積	165.794050 82.89	-165.794050 82.89			38.882

面積 (座標法) 計算書

地番 = 48-5
測点名

	[1] X (i)	[2] X (i+1)-X (i-1)	[3] Y (i)	[4] Y (i+1)-Y (i-1)	[2] * [3]	[1] * [4]	方向角	夾角	距離
48-26K	-150020.339	-4.286	-41311.351	-33.669	177060.450386	5051034.793791	182-15-46	91-58-31	4.457
48-107	-150024.793	-4.621	-41311.527	33.701	190900.566267	-5055985.548893	90-16-57	88-01-11	33.877
48-108	-150024.960	4.286	-41277.650	33.669	-176916.007900	-5051190.378240	357-19-32	87-02-35	4.458
48-12	-150020.507	4.621	-41277.858	-33.701	-190744.981818	5055841.106407	270-17-15	92-57-43	33.493
合計				倍面積 面積	300.026935 150.01	-300.026935 150.01			76.285

面積 (座標法) 計算書

地番 = 48-6
測点名

	[1] X (i)	[2] X (i+1)-X (i-1)	[3] Y (i)	[4] Y (i+1)-Y (i-1)	[2] * [3]	[1] * [4]	方向角	夾角	距離
48-109K	-150028.579	3.450	-41277.478	34.072	-142407.299100	-5111773.743688	357-16-44	86-59-46	3.623
48-108	-150024.960	3.786	-41277.650	-34.049	-156277.182900	5108199.863040	270-16-57	93-00-13	33.877
48-107	-150024.793	-3.450	-41311.527	-34.072	142524.768150	5111644.747096	183-05-09	92-48-12	3.622
48-106K	-150028.410	-3.786	-41311.722	34.049	156406.179492	-5108317.332090	90-16-58	87-11-49	34.244
合計				倍面積 面積	246.465642 123.23	-246.465642 123.23			75.366

面積 (座標法) 計算書

地番 = 48-7
測点名

	[1] X (i)	[2] X (i+1)-X (i-1)	[3] Y (i)	[4] Y (i+1)-Y (i-1)	[2] * [3]	[1] * [4]	方向角	夾角	距離
48-106K	-150028.410	-8.094	-41311.722	-34.688	334377.077868	5204185.486080	183-04-33	92-47-35	8.275
48-105	-150036.673	-15.334	-41312.166	-0.830	633480.753444	124530.438590	183-07-29	180-02-56	7.082
48-123	-150043.744	-14.690	-41312.552	-0.775	606881.388880	116283.901600	182-55-22	179-47-53	7.629
48-122	-150051.363	-18.424	-41312.941	-0.972	761149.624984	145849.924836	183-05-19	180-09-57	10.821
48-15	-150062.168	-13.551	-41313.524	34.186	559839.563724	-5130025.275248	94-30-57	91-25-38	34.877
48-6	-150064.914	0.016	-41278.755	37.637	-660.460080	-5647993.168218	46-04-43	131-33-46	3.982
48-5	-150062.152	36.335	-41275.887	1.277	-1499759.354145	-191629.368104	357-17-13	131-12-30	33.611
48-109K	-150028.579	33.742	-41277.478	-35.835	-1392784.662676	5376274.128465	270-16-58	92-59-45	34.244
合計				倍面積 面積	2523.931999 1261.96	-2523.931999 1261.96			140.521

面積 (座標法) 計算書

地番 = 48-8
測点名

	[1] X (i)	[2] X (i+1)-X (i-1)	[3] Y (i)	[4] Y (i+1)-Y (i-1)	[2]*[3]	[1]*[4]	方向角	夾角	距離
48-102	-150036.023	-10.026	-41324.195	-12.588	414316.379070	1888653.457524	182-59-50	89-54-15	10.691
48-120	-150046.699	-22.988	-41324.754	-1.227	949973.444952	184107.299673	183-06-20	180-06-30	12.330
48-103	-150059.011	-14.701	-41325.422	1.424	607525.028822	-213684.031664	138-47-31	135-41-11	3.175
48-104	-150061.400	-3.157	-41323.330	11.898	130457.752810	-1785430.537200	94-28-42	135-41-11	9.836
48-15	-150062.168	10.037	-41313.524	10.389	-414663.840388	-1558995.863352	3-05-19	88-36-37	10.821
48-122	-150051.363	18.424	-41312.941	0.972	-761149.624984	-145849.924836	2-55-22	179-50-03	7.629
48-123	-150043.744	14.690	-41312.552	0.775	-606881.388880	-116283.901600	3-07-29	180-12-07	7.082
48-105	-150036.673	7.721	-41312.166	-11.643	-318971.233686	1746876.983739	273-05-35	89-58-06	12.047
合計				倍面積 面積	606.517716 303.25	-606.517716 303.25			73.611

面積 (座標法) 計算書

地番 = 48-9
測点名

	[1] X (i)	[2] X (i+1)-X (i-1)	[3] Y (i)	[4] Y (i+1)-Y (i-1)	[2]*[3]	[1]*[4]	方向角	夾角	距離
48-38K	-150034.394	-0.979	-41324.107	-12.117	40456.300753	1817966.752098	183-05-32	89-59-57	1.631
48-102	-150036.023	-2.279	-41324.195	11.941	94177.840405	-1791580.150643	93-05-35	90-00-03	12.047
48-105	-150036.673	0.979	-41312.166	12.117	-40444.610514	-1817994.366741	3-05-32	89-59-57	1.631
48-37K	-150035.044	2.279	-41312.078	-11.941	-94150.225762	1791568.460404	273-05-35	90-00-03	12.047
合計				倍面積 面積	39.304882 19.65	-39.304882 19.65			27.356

面積 (座標法) 計算書

地番 = 48-10
測点名

	[1] X (i)	[2] X (i+1)-X (i-1)	[3] Y (i)	[4] Y (i+1)-Y (i-1)	[2]*[3]	[1]*[4]	方向角	夾角	距離
48-37K	-150035.044	9.601	-41312.078	12.580	-396637.260878	-1887440.853520	3-04-36	89-59-01	10.266
48-107	-150024.793	12.952	-41311.527	0.658	-535066.897704	-98716.313794	2-16-07	179-11-31	2.703
48-36	-150022.092	3.292	-41311.420	-11.887	-135997.194640	1783312.607604	272-49-15	90-33-08	12.009
48-18	-150021.501	-12.302	-41323.414	-12.687	508360.639028	1903322.783187	183-04-36	90-15-21	12.912
48-38K	-150034.394	-13.543	-41324.107	11.336	559652.381101	-1700789.890384	93-05-35	90-00-59	12.047
合計				倍面積 面積	311.666907 155.83	-311.666907 155.83			49.937

面積 (座標法) 計算書

地番 = 48-11

測点名	[1] X (i)	[2] X (i+1)-X (i-1)	[3] Y (i)	[4] Y (i+1)-Y (i-1)	[2] * [3]	[1] * [4]	方向角	夾角	距離
48-32K	-149998.146	22.370	-41291.045	-18.150	-923680.676650	2722466.349900	270-14-19	89-59-59	18.243
48-22	-149998.070	0.122	-41309.288	-31.105	-5039.733136	4665689.967350	270-12-18	179-57-59	12.862
48-19	-149998.024	-14.606	-41322.150	-13.661	603551.322900	2049123.005864	183-07-17	92-54-59	14.674
48-121	-150012.676	-23.477	-41322.949	-1.264	970138.873673	189616.022464	183-00-58	179-53-41	8.837
48-18	-150021.501	-9.416	-41323.414	11.529	389101.266224	-1729597.885029	92-49-15	89-48-17	12.009
48-36	-150022.092	1.162	-41311.420	12.063	-48003.870040	-1809716.495796	2-15-15	89-26-00	1.754
48-26K	-150020.339	1.652	-41311.351	20.282	-68246.351852	-3042712.515598	90-17-11	268-01-56	20.213
48-33K	-150020.440	22.193	-41291.138	20.306	-916374.225634	-3046315.054640	0-14-20	89-57-09	22.294
合計				倍面積 面積	1446.605485 723.30	-1446.605485 723.30			110.886

面積 (座標法) 計算書

地番 = 48-12

測点名	[1] X (i)	[2] X (i+1)-X (i-1)	[3] Y (i)	[4] Y (i+1)-Y (i-1)	[2] * [3]	[1] * [4]	方向角	夾角	距離
48-20K	-149996.382	-1.596	-41322.061	-12.870	65950.009356	1930453.436340	183-06-09	92-53-47	1.644
48-19	-149998.024	-1.688	-41322.150	12.773	69751.789200	-1915924.760552	90-12-18	87-06-09	12.862
48-22	-149998.070	1.596	-41309.288	12.870	-65929.623648	-1930475.160900	0-16-45	90-04-27	1.642
48-21K	-149996.428	1.688	-41309.280	-12.773	-69730.064640	1915904.374844	270-12-22	89-55-37	12.781
合計				倍面積 面積	42.110268 21.05	-42.110268 21.05			28.929