

西部第5地区土地区画整理事業 出来形確認測量 (原子図)

14街区

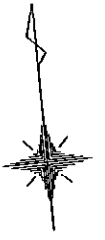

S = 1 / 250

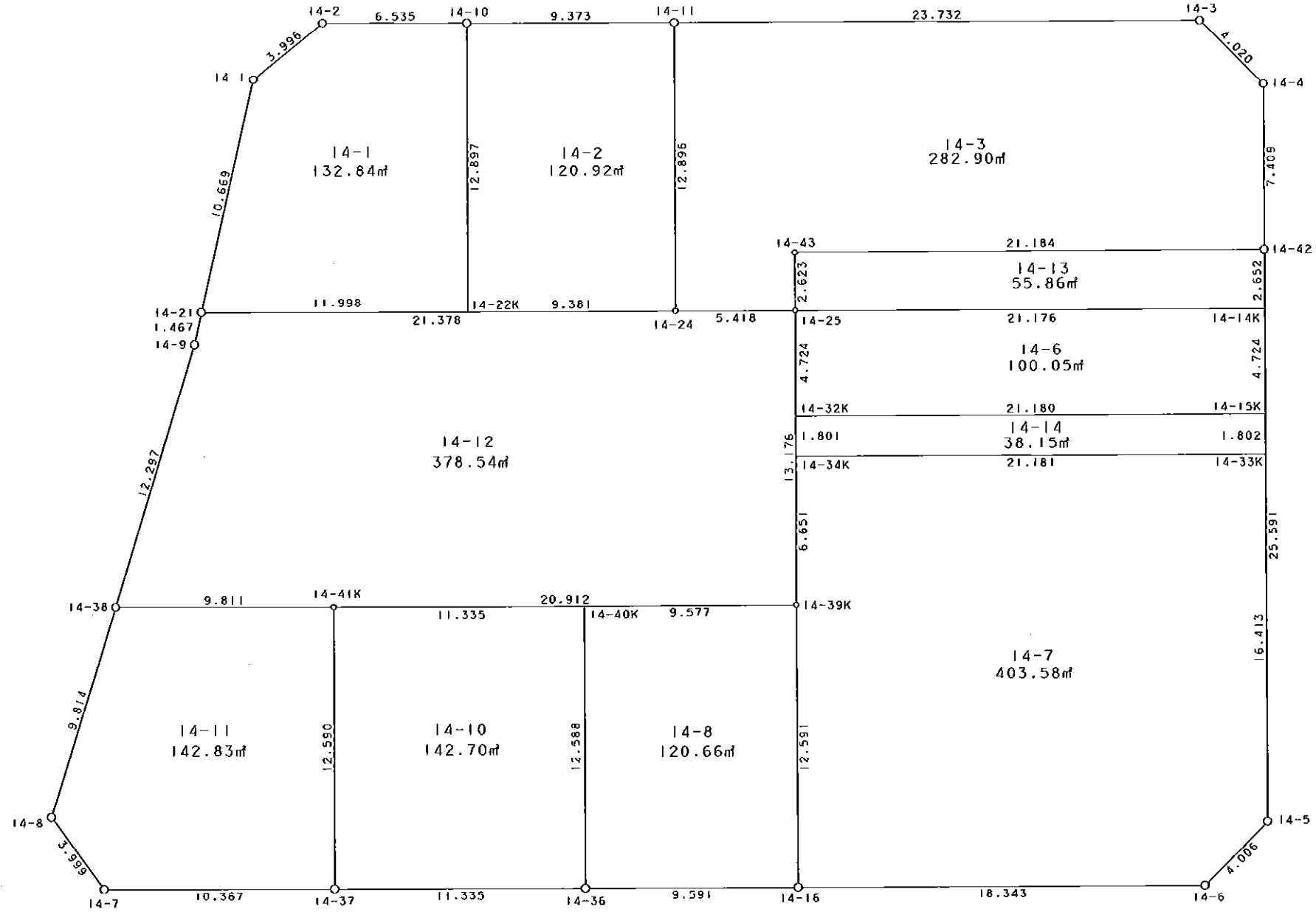

凡 例

記号	名称
⊙	地区界点
○	街区点
○	画地点 (折れ点)
	画地点 (直線中)

地番	筆種別	面積	坪数
14-1	筆界	132.84	40.18
14-2	筆界	120.92	36.57
14-3	筆界	282.90	85.57
14-6	筆界	100.05	30.26
14-7	筆界	403.58	122.08
14-8	筆界	120.66	36.49
14-10	筆界	142.70	43.16
14-11	筆界	142.83	43.20
14-12	筆界	378.54	114.51
14-13	筆界	55.86	16.90
14-14	筆界	38.15	11.54
	筆合	1919.03	580.46
	筆計		

面積 (座標法) 計算書

地番 = 14-1
測点名

	[1] X (i)	[2] X (i+1)-X (i-1)	[3] Y (i)	[4] Y (i+1)-Y (i-1)	[2]*[3]	[1]*[4]	方向角	夾角	距離
14-2	-149936.814	-1.584	-41788.609	-9.839	66193.156656	1475228.312946	236-31-29	141-04-52	3.996
14-1	-149939.018	-12.346	-41791.942	-6.644	515963.315932	996194.835592	198-04-48	141-33-19	10.669
14-21	-149949.160	-11.257	-41795.253	8.635	470489.163021	-1294810.996600	95-19-56	77-15-08	11.998
14-22K	-149950.275	11.726	-41783.307	13.150	-489951.057882	-1971846.116250	5-21-23	90-01-27	12.897
14-10	-149937.434	13.461	-41782.103	-5.302	-562428.888483	794968.275068	275-26-37	90-05-14	6.535
合計				倍面積 面積	265.689244 132.84	-265.689244 132.84			46.095

面積 (座標法) 計算書

地番 = 14-2
測点名

	[1] X (i)	[2] X (i+1)-X (i-1)	[3] Y (i)	[4] Y (i+1)-Y (i-1)	[2]*[3]	[1]*[4]	方向角	夾角	距離
14-10	-149937.434	-11.969	-41782.103	-10.536	500089.990807	1579740.804624	185-21-23	90-01-05	12.897
14-22K	-149950.275	-13.712	-41783.307	8.136	572932.705584	-1219995.437400	95-19-40	89-58-17	9.381
14-24	-149951.146	11.969	-41773.967	10.536	-499992.611023	-1579885.274256	5-19-18	89-59-38	12.896
14-11	-149938.306	13.712	-41772.771	-8.136	-572788.235952	1219898.057616	275-20-18	90-01-00	9.373
合計				倍面積 面積	241.849416 120.92	-241.849416 120.92			44.547

面積 (座標法) 計算書

地番 = 14-3
測点名

	[1] X (i)	[2] X (i+1)-X (i-1)	[3] Y (i)	[4] Y (i+1)-Y (i-1)	[2]*[3]	[1]*[4]	方向角	夾角	距離
14-11	-149938.306	-10.629	-41772.771	-24.825	444002.782959	3722218.446450	185-19-18	89-58-34	12.896
14-24	-149951.146	-13.344	-41773.967	4.199	557431.815648	-629644.862054	95-20-13	90-00-55	5.418
14-25	-149951.650	2.109	-41768.572	5.629	-88089.918348	-844077.837850	5-07-02	89-46-49	2.623
14-43	-149949.037	0.677	-41768.338	21.329	-28277.164826	-3198263.010173	95-14-37	270-07-35	21.184
14-42	-149950.973	5.441	-41747.243	21.781	-227146.749163	-3266082.142913	5-18-46	90-04-09	7.409
14-4	-149943.596	10.456	-41746.557	-1.899	-436501.999992	284742.888804	319-59-04	134-40-18	4.020
14-3	-149940.517	5.290	-41749.142	-26.214	-220852.961180	3930540.712638	275-20-44	135-21-40	23.732
合計				倍面積 面積	565.805098 282.90	-565.805098 282.90			77.282

面積 (座標法) 計算書

地番 = 14-6
測点名

	[1] X (i)	[2] X (i+1)-X (i-1)	[3] Y (i)	[4] Y (i+1)-Y (i-1)	[2]*[3]	[1]*[4]	方向角	夾角	距離
14-15K	-149958.318	2.740	-41747.922	21.524	-114389.306280	-3227702.836632	5-17-00	89-57-46	4.724
14-14K	-149953.614	6.668	-41747.487	-20.650	-278372.243316	3096542.129100	275-19-18	90-02-18	21.176
14-25	-149951.650	-2.740	-41768.572	-21.524	114445.887280	3227559.314600	185-19-54	90-00-36	4.724
14-32K	-149956.354	-6.668	-41769.011	20.650	278515.765348	-3096598.710100	95-19-14	89-59-20	21.180
合計				倍面積 面積	200.103032 100.05	-200.103032 100.05			51.804

面積 (座標法) 計算書

地番 = 14-7
測点名

	[1] X (i)	[2] X (i+1)-X (i-1)	[3] Y (i)	[4] Y (i+1)-Y (i-1)	[2] * [3]	[1] * [4]	方向角	夾角	距離
14-34K	-149958.147	-4.657	-41769.178	-21.707	194519.061946	3255141.496929	185-19-23	90-00-00	6.651
14-39K	-149964.769	-19.160	-41769.795	-1.773	800309.272200	265887.535437	185-16-04	179-56-41	12.591
14-16	-149977.307	-14.238	-41770.951	17.108	594734.800338	-2565811.768156	95-19-04	90-03-00	18.343
14-6	-149979.007	0.852	-41752.687	21.352	-35573.289324	-3202351.757464	50-25-44	135-06-40	4.006
14-5	-149976.455	18.895	-41749.599	4.599	-788858.673105	-689741.716545	5-16-56	134-51-12	16.413
14-33K	-149960.112	18.308	-41748.088	-19.579	-764323.995104	2936069.032848	275-19-23	90-02-27	21.181
合計				倍面積 面積	807.176951 403.58	-807.176951 403.58			79.185

面積 (座標法) 計算書

地番 = 14-8
測点名

	[1] X (i)	[2] X (i+1)-X (i-1)	[3] Y (i)	[4] Y (i+1)-Y (i-1)	[2] * [3]	[1] * [4]	方向角	夾角	距離
14-36	-149976.420	-13.421	-41780.501	8.380	560736.103921	-1256802.399600	95-18-23	89-58-25	9.591
14-16	-149977.307	11.651	-41770.951	10.706	-486673.350101	-1605657.048742	5-16-04	89-57-41	12.591
14-39K	-149964.769	13.421	-41769.795	-8.380	-560592.418695	1256704.764220	275-17-25	90-01-21	9.577
14-40K	-149963.886	-11.651	-41779.331	-10.706	486770.985481	1605513.363516	185-19-58	90-02-33	12.588
合計				倍面積 面積	241.320606 120.66	-241.320606 120.66			44.347

面積 (座標法) 計算書

地番 = 14-10
測点名

	[1] X (i)	[2] X (i+1)-X (i-1)	[3] Y (i)	[4] Y (i+1)-Y (i-1)	[2] * [3]	[1] * [4]	方向角	夾角	距離
14-36	-149976.420	11.491	-41780.501	12.457	-480099.736991	-1868256.263940	5-19-58	90-03-12	12.588
14-40K	-149963.886	13.579	-41779.331	-10.117	-567321.535649	1517184.634662	275-17-23	89-57-25	11.335
14-41K	-149962.841	-11.491	-41790.618	-12.457	480215.991438	1868087.110337	185-19-55	90-02-32	12.590
14-37	-149975.377	-13.579	-41791.788	10.117	567490.689252	-1517300.889109	95-16-46	89-56-51	11.335
合計				倍面積 面積	285.408050 142.70	-285.408050 142.70			47.848

面積 (座標法) 計算書

地番 = 14-11
測点名

	[1] X (i)	[2] X (i+1)-X (i-1)	[3] Y (i)	[4] Y (i+1)-Y (i-1)	[2] * [3]	[1] * [4]	方向角	夾角	距離
14-38	-149961.927	-8.142	-41800.386	-13.550	340338.742812	2031984.110850	202-40-00	107-19-16	9.814
14-8	-149970.983	-12.485	-41804.168	-1.724	521925.037480	258549.974692	149-01-44	126-21-44	3.999
14-7	-149974.412	-4.394	-41802.110	12.380	183678.471340	-1856683.220560	95-20-28	126-18-44	10.367
14-37	-149975.377	11.571	-41791.788	11.492	-483572.778948	-1723517.032484	5-19-55	89-59-27	12.590
14-41K	-149962.841	13.450	-41790.618	-8.598	-562083.812100	1289380.506918	275-20-44	90-00-49	9.811
合計				倍面積 面積	285.660584 142.83	-285.660584 142.83			46.581

面積 (座標法) 計算書

地番 = 14-12

測点名	[1] X (i)	[2] X (i+1)-X (i-1)	[3] Y (i)	[4] Y (i+1)-Y (i-1)	[2] * [3]	[1] * [4]	方向角	夾角	距離
14-21	-149949.160	0.592	-41795.253	-21.742	-24742.789776	3260194.636720	198-06-50	102-47-01	1.467
14-9	-149950.554	-12.767	-41795.709	-5.133	533605.816803	769696.193682	202-21-15	184-14-25	12.297
14-38	-149961.927	-12.287	-41800.386	5.091	513601.342782	-763456.170357	95-20-44	72-59-29	9.811
14-41K	-149962.841	-2.842	-41790.618	30.591	118768.936356	-4587513.269031	95-17-24	179-56-40	20.912
14-39K	-149964.769	11.191	-41769.795	22.046	-467445.775845	-3306123.297374	5-19-33	90-02-09	13.176
14-25	-149951.650	13.623	-41768.572	-4.172	-569013.256356	625598.283800	275-20-13	90-00-40	5.418
14-24	-149951.146	2.490	-41773.967	-26.681	-104017.177830	4000846.526426	275-19-49	179-59-36	21.378
合計					757.096134	-757.096134			84.459
				倍面積 面積	378.54	378.54			

面積 (座標法) 計算書

地番 = 14-13

測点名	[1] X (i)	[2] X (i+1)-X (i-1)	[3] Y (i)	[4] Y (i+1)-Y (i-1)	[2] * [3]	[1] * [4]	方向角	夾角	距離
14-25	-149951.650	-4.577	-41768.572	20.851	191174.754044	-3126641.854150	95-19-18	90-12-16	21.176
14-14K	-149953.614	0.677	-41747.487	21.329	-28263.048699	-3198360.633006	5-16-43	89-57-25	2.652
14-42	-149950.973	4.577	-41747.243	-20.851	-191077.131211	3126627.738023	275-14-37	89-57-54	21.184
14-43	-149949.037	-0.677	-41768.338	-21.329	28277.164826	3198263.010173	185-07-02	89-52-25	2.623
合計					111.738960	-111.738960			47.635
				倍面積 面積	55.86	55.86			

面積 (座標法) 計算書

地番 = 14-14

測点名	[1] X (i)	[2] X (i+1)-X (i-1)	[3] Y (i)	[4] Y (i+1)-Y (i-1)	[2] * [3]	[1] * [4]	方向角	夾角	距離
14-33K	-149960.112	-0.171	-41748.088	21.256	7138.923048	-3187552.140672	5-17-12	89-57-49	1.802
14-15K	-149958.318	3.758	-41747.922	-20.923	-156888.690876	3137577.887514	275-19-14	90-02-02	21.180
14-32K	-149956.354	0.171	-41769.011	-21.256	-7142.500881	3187472.260624	185-19-16	90-00-02	1.801
14-34K	-149958.147	-3.758	-41769.178	20.923	156968.570924	-3137574.309681	95-19-23	90-00-07	21.181
合計					76.302215	-76.302215			45.964
				倍面積 面積	38.15	38.15			