

**BLOCK NO. 24**

**街区計算**

街区略図

工区

2

ブロック

24

記入者



点検者



$X = -152,686.110$

$Y = -36,581.718$

$W = 6.000$

$X = -152,719.59$

$Y = -36,435.89$

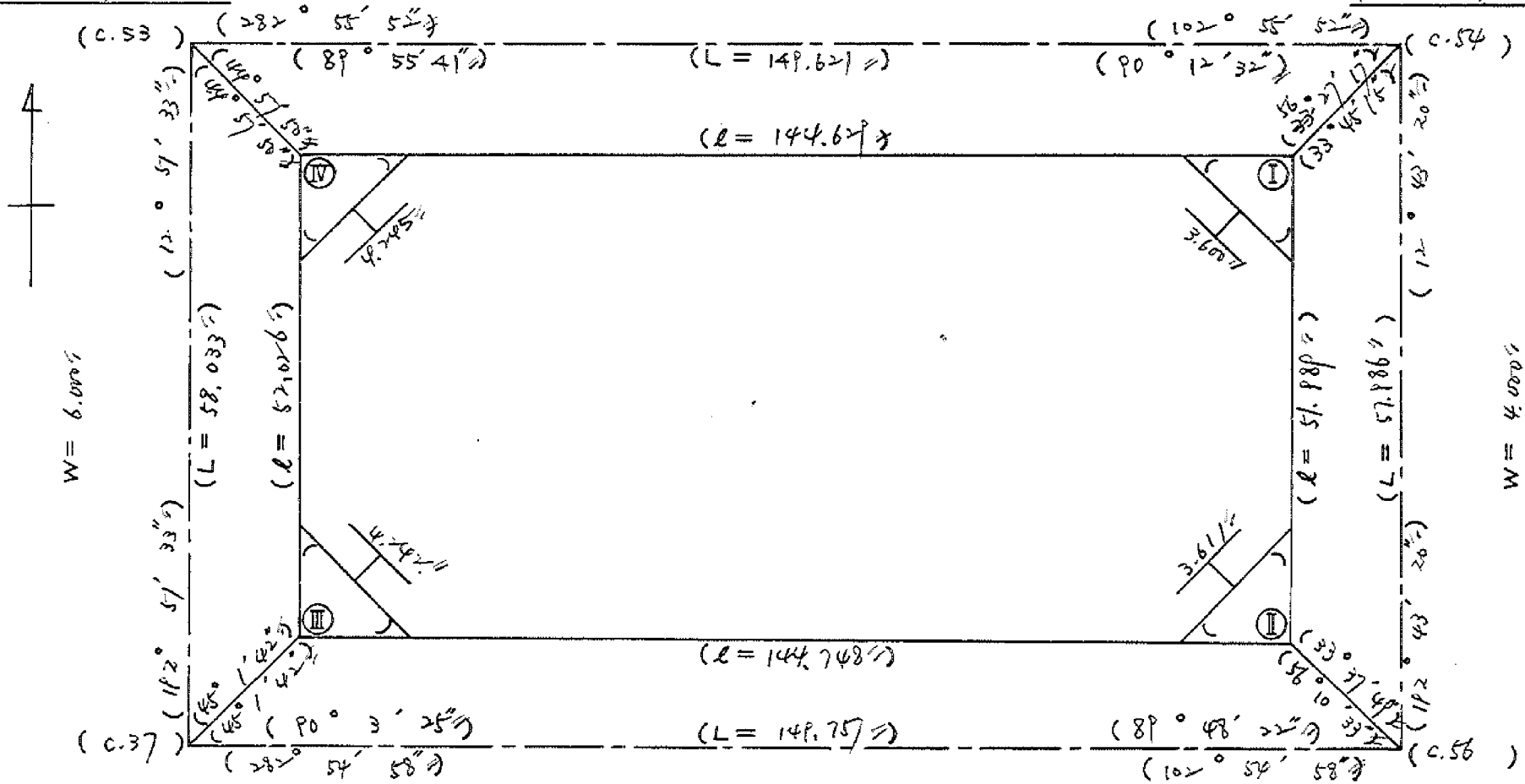

$X = -152,742.684$

$Y = -36,594.624$

$W = 6.000$

$X = -152,776.158$

$Y = -36,448.656$

# 面積計算書

工区

2

ブロック

24

計算者



精算者



備考

全体

点	①	②	③	④	⑤	⑥	③ × ⑤		② × ⑥	
	X	X-(定数)	X <sub>n-1</sub> -X <sub>n+1</sub>	Y	Y-(定数)	Y <sub>n-1</sub> -Y <sub>n+1</sub>	+	-	+	-
I	<sup>-157</sup> 722.071	<sup>-157,600</sup> 122.071	<sup>-36</sup> ↑ 83.079	438.501	<sup>-36,400</sup> 38.501	-129.517			3,198.624577	15,810.269707
II	772.785	172.785	+ 18.358	449.945	49.945	+ 152.530			916.890310	26,354.896050
III	740.429	140.429	- 83.079	591.031	191.031	+ 129.517	15,870.664449			18,187.942793
IV	689.706	89.706	- 18.358	579.462	179.462	- 152.530	3,294.563396			13,682.856180
							19,165.227845	14,115.514889	29,493.125887	44,542.838043
							15,049.712956			15,049.712956
									$\frac{1}{2} = 7,524.856478$	
							25キリ I	II	III	IV
							7.524.85, -(2.00 + 2.00 + 4.50 + 4.50) = 7.511.85,			

# 地 地 計 算

BN024

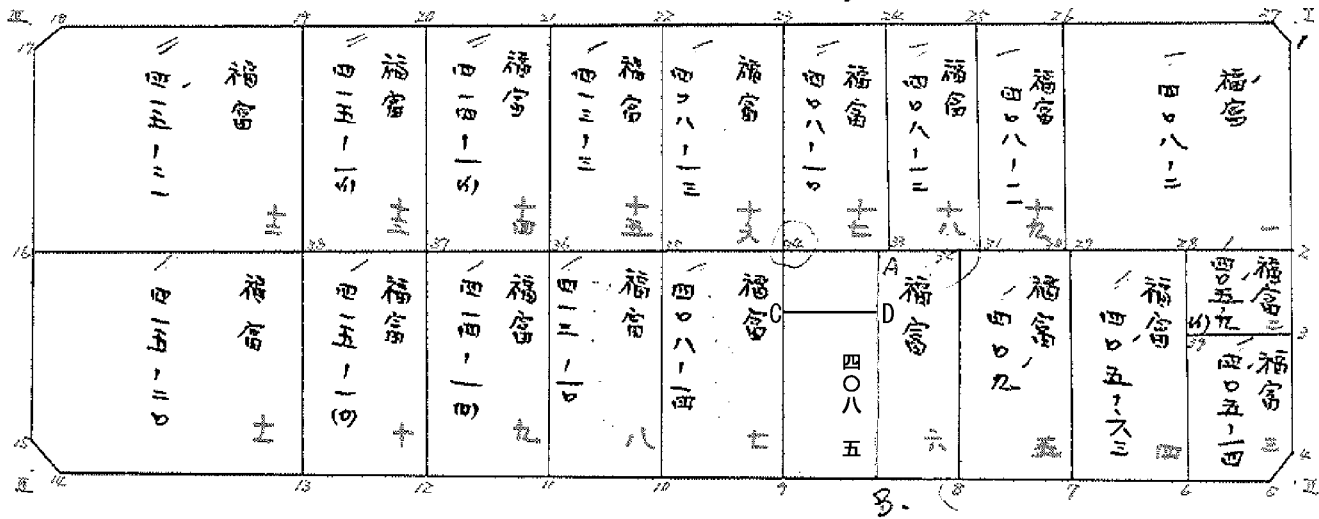

面積計算書						工区	ブロック	計測者	精算者	備考
						2	24			1. 福富 408-2 2. 福富 605-9(4)
点	① X	② X-(定数)	③ X <sub>n-1</sub> -X <sub>n+1</sub>	④ Y	⑤ Y-(定数)	⑥ Y <sub>n-1</sub> -Y <sub>n+1</sub>	③ × ⑤ +	③ × ⑤ -	② × ⑥ +	② × ⑥ -
1	<del>726.822</del>	<del>24.022</del>	<del>+25.779</del>	<del>438.941</del>	<del>38.941</del>	<del>+3.767</del>	<del>1003.860039</del>		<del>90.490.874</del>	
2	<del>747.402</del>	<del>47.402</del>	<del>+17.552</del>	<del>444.217</del>	<del>44.217</del>	<del>+30.594</del>	<del>776.096784</del>		<del>1454.956988</del>	
30	<del>741.574</del>	<del>41.574</del>	<del>-31.144</del>	<del>469.635</del>	<del>69.635</del>	<del>+19.602</del>	<del>2168.712464</del>		<del>8149.33548</del>	
26	<del>716.258</del>	<del>16.258</del>	<del>-19.951</del>	<del>463.819</del>	<del>63.819</del>	<del>-29.185</del>	<del>273.252859</del>		<del>474.689.790</del>	
27	<del>721.623</del>	<del>21.623</del>	<del>+7.764</del>	<del>440.450</del>	<del>40.450</del>	<del>-24.878</del>	<del>316.253800</del>		<del>537.936994</del>	
							<del>3441.965309</del>	<del>1673.977099</del>	<del>1012.426724</del>	<del>2360.381610</del>
							<del>1347.954686</del>			<del>1347.954686</del>
							<del>× 1/2 = 673.977343</del>			
2	<del>747.402</del>	<del>47.402</del>	<del>+12.173</del>	<del>444.217</del>	<del>44.217</del>	<del>-9.651</del>	<del>598.253541</del>		<del>457.476702</del>	
3	<del>756.872</del>	<del>56.872</del>	<del>+6.764</del>	<del>446.354</del>	<del>46.354</del>	<del>+13.939</del>	<del>313.538456</del>		<del>792.738808</del>	
39	<del>754.166</del>	<del>54.166</del>	<del>+12.173</del>	<del>458.156</del>	<del>58.156</del>	<del>+9.651</del>	<del>707.932988</del>		<del>522.756066</del>	
28	<del>744.699</del>	<del>44.699</del>	<del>-6.764</del>	<del>456.005</del>	<del>56.005</del>	<del>-13.939</del>	<del>378.817824</del>		<del>623.059361</del>	
							<del>1086.750808</del>	<del>851.791987</del>	<del>1080.536063</del>	<del>15.494874</del>
							<del>234.958811</del>			<del>234.958811</del>
							<del>× 1/2 = 117.4794055</del>			

面積計算書

工  
区

ブロック

計算名

積算名

備考  
197

福富408-2

地点番	点	①	②	③	④	⑤	⑥	⑦	⑧	⑨	⑩	⑪	⑫	⑬	
		X	X-(定数)	$X_{n-1}-X_{n+1}$	Y	Y-(定数)	$Y_{n-1}-Y_{n+1}$	+	-	+	-	+	-	+	-
A	6	733.211	3.211	0.	454.402	14.402	0.								
	3	744.473	14.473	-14.191	456.990	16.990	10.185		241	105090	147	407505			
	4	747.402	17.402	8.398	444.217	4.217	15.329	35	414366		266	755258			
	7	736.075	6.075	14.191	441.661	1.661	-10.185	23	571251				61	273875	
	6	<del>744.473</del> 733.211	3.211	-8.398	454.402	14.402	-15.329	120	947996				49	221419	
	3	744.473	14.473	0.	456.990	16.990	0.								
								58	985617	362	053086	414	162763	111	095294
								303	067469	303	067469				
								1/2		151.5337345 m <sup>2</sup>					
								<u>151.56 m<sup>2</sup></u>							

面積計算書						工区	2	ブロック	24	計算者	精算者	備考	福富. 405-14	福富. 405-83		
点	①	②	③	④	⑤	⑥	③ × ⑤		② × ⑥							
	X	X-(定数)	X <sub>n-1</sub> -X <sub>n+1</sub>	Y	Y-(定数)	Y <sub>n-1</sub> -Y <sub>n+1</sub>	+	-	+	-						
3	<sup>-152</sup> 756.872	<sup>-152.700</sup> 56.872	+16.668	<sup>-36</sup> 466.354	<sup>-36.400</sup> 46.354	-8.651							772.628472	491.999672		
4	770.834	70.834	+15.466	469.505	49.505	+5.540							765.646330	392.420360		
5	772.338	72.338	-0.760	451.896	51.896	+12.261							39.439440	886.936218		
6	770.074	70.074	-18.172	461.766	61.766	+6.262							1122.411752	438.803388		
39	754.166	54.166	-13.202	458.156	58.156	-15.412							767.775512	834.806392		
													1929.626704	1538.272802	1326.806064	1718.159966
													391.353902		391.353902	
													$\frac{1}{2} = 195.676951$			
28	<sup>-152</sup> 744.699	<sup>-152.700</sup> 44.699	+28.377	<sup>-36</sup> 456.005	<sup>-36.400</sup> 56.005	-7.333							1589.253885	327.777767		
6	770.074	70.074	+22.345	461.766	61.766	+18.983							1380.037738	1330.214742		
7	767.042	67.042	-28.377	474.988	74.988	+7.333							2127.934476	491.618986		
29	741.697	41.697	+22.343	469.099	69.099	-18.983							1543.878957	791.534151		
													3671.813433	2969.291623	1119.311918	1821.833728
													702.521810		702.521810	
													$\frac{1}{2} = 351.260905$			



面積計算書

工区

2

ブロック

24

計算者



新算者



備考

5. 福富 409

6. 福富 408-5

点	①	②	③	④	⑤	⑥	③ × ⑤		② × ⑥	
	X	X-(定数)	X <sub>n-1</sub> -X <sub>n+1</sub>	Y	Y-(定数)	Y <sub>n-1</sub> -Y <sub>n+1</sub>	+	-	+	-
	-152	-152.700		-36	-36.600					
29	741.697	41.697	+28.258	469.099	69.099	-6.818		1952.599542		284.290146
7	767.042	67.042	+22.454	474.988	74.988	+18.492				1239.740664
8	764.151	64.151	-28.258	487.591	87.591	+6.818	2475.146478			437.381518
32	738.784	38.784	-22.454	481.806	81.806	-18.492	1836.371924			777.193728
							4312.018402	3636.380096	1001.483874	1677.122182
							675.638308			675.638308
							1/2 = 337.819154			
<del>32</del>	<del>738.784</del>	<del>38.784</del>	<del>+29.813</del>	<del>481.806</del>	<del>81.806</del>	<del>-13.606</del>		<del>2438.882278</del>		<del>527.685104</del>
<del>8</del>	<del>764.151</del>	<del>64.151</del>	<del>+20.918</del>	<del>487.591</del>	<del>87.591</del>	<del>+25.188</del>		<del>1932.228538</del>		<del>1615.835388</del>
<del>9</del>	<del>759.702</del>	<del>59.702</del>	<del>-29.813</del>	<del>506.994</del>	<del>106.994</del>	<del>+13.606</del>	<del>3189.812122</del>			<del>812.305412</del>
<del>34</del>	<del>734.338</del>	<del>34.338</del>	<del>-20.918</del>	<del>501.197</del>	<del>101.197</del>	<del>-25.188</del>	<del>2116.838846</del>			<del>864905544</del>
							<del>5306.652968</del>	<del>4271.110316</del>	<del>1392.600648</del>	<del>2428.160800</del>
							<del>1035.540152</del>			<del>1035.540152</del>
							1/2 = 517.770076			

五福富四〇九

六福富四〇八五

地番 408-18

座標による面積計算書

頁	X	1		2		3		4		1×4		2×3		
		X <sub>2</sub> +X <sub>1</sub> m	X <sub>2</sub> -X <sub>1</sub> m	Y	Y <sub>2</sub> +Y <sub>1</sub> m	Y <sub>2</sub> -Y <sub>1</sub> m	+	-	+	-				
32	738 784			481 806										
2	764 151	-1502 935	+ 25 367	487 591	- 969 317	+ 5 705				8694 4789			2459 6937	
③	762 669	-1526 820	- 1 482	494 056	- 981 647	+ 6 465				9870 8910	1454 8008			
④	787 802	-1499 971	- 25 367	488 271	- 982 327	- 5 705	8677 2222					2491 8 6890		
32	788 784	-1476 086	+ 1 482	481 806	- 970 077	6 465	9542 8959						1437 6541	
計														
差							18220 2281	18565 3702	26373 4898	26028 3478	345 1421	345 1420		
												1/2	172 5710	
												X 0.3025坪		

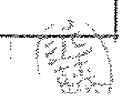



面積計算書

地番	① X	② X - (定数) X <sub>n-1</sub> - X <sub>n+1</sub>	③ Y	④ Y - (定数) Y <sub>n-1</sub> - Y <sub>n+1</sub>	⑤ ③ × ⑤ +	⑥ ② × ⑥ +	③ × ⑤		② × ⑥	
							-	-	-	-
9	-759.702	(-740.000) + 19.702	+ 21.997	-506.994	(-480.000) + 26.994	- 8.593	593.247138			169.299286
C	-740.692	+ 0.692	+ 16.045	-502.649	+ 22.649	+ 17.274	363.403205		11.953608	
D	-743.657	+ 3.657	- 21.977	-489.720	+ 9.720	+ 8.593		213.616440	31.424601	
B	-762.669	+ 22.669	- 16.045	-494.056	+ 14.056	- 17.274		225.528520		391.584306
福富408-19							956.650343	439.144960	43.378209	560.883592
							517.505383			517.505383
							$\times \frac{1}{2}$ 258.7526915		$\times \frac{1}{2}$	258.7526915
C	-740.692	(-730.000) + 10.692	+ 9.319	-502.649	(-480.000) + 22.649	- 11.477	211.066031			122.712084
34	-734.338	+ 4.338	+ 3.390	-501.197	+ 21.197	+ 14.378	71.857830		62.371764	
A	-737.302	+ 7.302	- 9.319	-488.271	+ 8.271	+ 11.477		77.077449	83.805054	
D	-743.657	+ 13.657	- 3.390	-489.720	+ 9.720	- 14.378		32.950800		196.360346
福富408-5							282.923861	110.028249	146.176818	319.072430
							172.895612			172.895612
							$\times \frac{1}{2}$ 86.447806		$\times \frac{1}{2}$	86.447806

12-4

面積計算書		工区	2	ブロック	24	計区	精算者	備考	不福富 408-600 8. 福富 413-300	
									408-14 413-10	
点	①	②	③	④	⑤	⑥	③ × ⑤	② × ⑥		
	X	X-(定数)	X <sub>n-1</sub> -X <sub>n+1</sub>	Y	Y-(定数)	Y <sub>n-1</sub> -Y <sub>n+1</sub>	+	-	+	-
24	-152 734.338	-152.700 34.338	+28.420	-36 501.197	-36.500 1.197	-7.533		34.018740	258.668156	
9	759.702	59.702	+22.306	506.994	6.994	+19.128		156.008160	1141.977856	
10	756.644	56.644	-28.420	520.325	20.325	+7.533	577.636500		626.699252	
25	731.282	31.282	-22.306	514.527	14.527	-19.128	324.039262		598.362096	
							901.575762	190.026906	257.030250	1588.679108
							711.648858			711.648858
							V <sub>2</sub> = 755.824429			
25	-152 731.282	-152.700 31.282	+28.314	-36 514.527	-36.500 14.527	-7.072		611.317478	221.226304	
10	756.644	56.644	+22.410	520.325	20.325	+19.670		455.483250	1057.543480	
11	753.692	53.692	-28.314	533.197	33.197	+7.072	939.939858		379.709824	
26	728.330	28.330	-22.410	527.297	27.297	-19.670	613.916770		528.921100	
							153.906628	866.800728	780.147406	1437.253704
							687.105900			687.105900
							V <sub>2</sub> = 343.507950			

面積計算書						工区	ノ	ブロック	24	計算者	縮尺者	備考
	①	②	③	④	⑤	⑥	③ × ⑤	② × ⑥				9. 福富 415-1(10)
点	X	X-(定数)	X <sub>n-1</sub> -X <sub>n+1</sub>	Y	Y-(定数)	Y <sub>n-1</sub> -Y <sub>n+1</sub>	+	-	+	-		10. 福富 415-1(10)
36	<sup>-152</sup> 728.330	<sup>-152.700</sup> 28.330	+ 28.520	<sup>-36</sup> 527.397	<sup>-36.500</sup> 27.397	- 7.977						781.362440, 225.988410
11	753.692	53.692	+ 22.202	533.197	33.197	+ 19.578						737.039794, 1051.181976
12	750.532	50.532	- 28.520	546.975	46.975	+ 7.977	1339.727000					403.093764
37	725.172	25.172	- 22.202	541.174	41.174	- 19.578	914.145148					492.817416
							2253.872149	518.402234	718.805826	1454.275740		
							735.469914			735.469914		
							1/2 367.734957					
37	<sup>-152</sup> 725.172	<sup>-152.700</sup> 25.172	+ 28.502	<sup>-36</sup> 541.174	<sup>-36.500</sup> 41.174	- 8.337						1177.658748, 209.858964
12	750.532	50.532	+ 22.118	526.975	46.975	+ 19.940						1038.993050, 1007.608080
13	747.290	47.290	- 28.602	561.114	61.114	+ 8.337	1747.982628					394.256730
38	721.930	21.930	- 22.118	555.312	55.312	- 19.940	1223.390816					437.284200
							2971.373444	2216.651798	647.143164	401.864810		
							754.721646			754.721646		
							1/2 377.360823					

面積計算書						工区	≧	ブロック	≧	計算者	精算者	備考	11. 福富 415-20	12. 福富 415-21
点	①	②	③	④	⑤	⑥	③ × ⑤	② × ⑥						
	X	X-(定数)	X <sub>n-1</sub> -X <sub>n+1</sub>	Y	Y-(定数)	Y <sub>n-1</sub> -Y <sub>n+1</sub>	+ -	+ -						
12	-152 721.930	-152.700 21.930	+32.223	-36 555.312	-36.500 55.312	-24.132		1782.318576	529.214760					
13	747.290	47.290	+19.170	561.114	61.114	+32.794		1171.555380	1550.828260					
14	741.100	41.100	-9.786	588.106	88.106	+29.250	862.205316		1202.175000					
15	737.504	37.504	-26.033	590.364	90.364	-2.860	2352.446012		107.261440					
16	715.067	15.067	-15.576	585.246	85.246	-35.052	1327.621204		528.128484					
								4542.272532	2953.873956					
								1588.398576	1588.398576					
								1/2 = 794.199288						
19	-152 696.582	-152.600 96.582	+31.553	-36 549.513	-36.500 49.513	-21.226		1562.283689	2050.049532					
28	721.930	121.930	+18.485	555.312	55.312	+35.733		1022.442320	4356.924690					
16	715.067	115.067	-29.300	585.246	85.246	+24.817	2497.707800		2855.617739					
17	692.630	92.630	-24.690	580.129	80.129	-8.708	1978.385010		806.622040					
18	690.377	90.377	+3.952	576.538	76.538	-30.616		302.478176	2766.982232					
								4476.092810	2887.204185					
								1588.888625	1588.888625					
								1/2 = 794.4443125						





面積計算書						工区	ブロック	計算者	積算者	備考
点	①	②	③	④	⑤	⑥	③ × ⑤	② × ⑥		
	X	X-(定数)	X <sub>n-1</sub> -X <sub>n+1</sub>	Y	Y-(定数)	Y <sub>n-1</sub> -Y <sub>n+1</sub>	+	-		
22	<sup>-152</sup> 705.945	<sup>-152.700</sup> 5.945	+28.291	<sup>-36</sup> 508.734	<sup>-36.500</sup> 8.734	-7.075	247.093574	42.060875		
35	731.282	31.282	+22.385	514.527	14.527	+18.663	325.186895	583.815966		
36	728.330	28.330	-28.291	527.397	27.397	+7.075	775.088527	200.434750		
21	702.991	2.991	-22.385	821.602	21.602	-18.663	483.560770	55.821033		
							1258.649297	572.280489		
							686.368808	686.368808		
							1/2 343.184404			
23	<sup>-152</sup> 709.005	<sup>-152.700</sup> 9.005	+28.393	<sup>-36</sup> 495.408	<sup>-36.400</sup> 95.408	-7.537	2708.919344	67.870685		
24	734.338	34.338	+22.277	501.197	101.197	+19.119	2254.365569	656.508222		
35	731.282	31.282	-28.393	514.527	114.527	+7.537	3251.765111	235.772434		
22	705.945	5.945	-22.277	508.734	108.734	-19.119	2422.267318	113.662455		
							5874.032429	4963.284913		
							181.533140	892.280656		
							710.747516	710.747516		
							1/2 355.373758			

15. 福富 413-3  
 16. 福富 408-6  
 408-13

面積計算書

工区

ノ

ブロック

24

計算者

監

精算者

備考

17.福富 408-10  
18.福富 408-12

項	①	②	③	④	⑤	⑥	③ ×	⑤	② ×	⑥
	X	X-(定数)	X <sub>n-1</sub> -X <sub>n+1</sub>	Y	Y-(定数)	Y <sub>n-1</sub> -Y <sub>n+1</sub>	+	-	+	-
24	<sup>-152</sup> 712.259	-152.700 12.259	+28.578	<sup>-36</sup> 481.234	-36.400 81.234	- 8.367			2321.505252	102.571053
23	737.583	37.583	+22.079	487.041	87.041	+ 19.963			1921.778239	750.269429
24	734.338	34.338	- 28.378	501.197	101.197	+ 8.367	2892.007866			287.306046
23	709.005	9.005	-22.079	495.408	95.408	- 19.963	2106.513232			179.766815
							4998.521098	243.283491	282.337868	1037.575475
							755.237607			755.237607
							1/2 377.6188035			
25	<sup>-152</sup> 713.981	-152.700 13.981	+ 27.046	<sup>-36</sup> 473.734	-36.400 73.734	- 1.689			1994.209764	23.613909
21	739.302	39.302	+ 23.602	479.545	79.545	+ 13.307			1877.421090	522.991714
23	737.583	37.583	- 27.046	487.041	87.041	+ 1.689	2354.110886			63.477687
24	712.259	12.254	- 23.602	481.234	81.234	- 13.307	1917.284868			163.090592
							4271.395754	3871.630854	186.704501	586.469401
							399.764900			399.764900
							1/2 199.982450			

11-10-10 1010101010

11-10-10 1010101010

面積計算書

工  
区

2

ブ  
ロ  
ック

24

計  
算  
者



精  
算  
者



備  
考

19補窟 408-11

点	①	②	③	④	⑤	⑥	③ ×	⑤	② ×	⑥
	X	X-(定数)	X <sub>n-1</sub> -X <sub>n+1</sub>	Y	Y-(定数)	Y <sub>n-1</sub> -Y <sub>n+1</sub>	+	-	+	-
26	<sup>-152</sup> 716.258	<sup>-152.700</sup> 16.258	+27.593	<sup>-36</sup> 463.819	<sup>-36.400</sup> 63.819	- 4.099			1760.95766766	641542
20	741.574	41.574	+23.044	469.635	69.635	+ 15.726			1604.668940	653.792724
21	739.302	39.302	- 27.593	479.645	79.645	+ 4.099	2194.885185			161.098898
25	713.981	13.981	-23.044	473.734	73.734	- 15.726	1699.126296		219.865206	
							3894.0114813365	626607	286306748	814.891622
							528.384874			328.384874
							1/2 = 264.192437			

12補窟 408-11

面積計算書						工区	Z	ブロック	Z	計算者	精算者	備考	隅切 1. Z.
点	①	②	③	④	⑤	⑥	③ × ⑤	② × ⑥					
	X	X-(定数)	X <sub>n-1</sub> -X <sub>n+1</sub>	Y	Y-(定数)	Y <sub>n-1</sub> -Y <sub>n+1</sub>	+ -	+ -					
I	<sup>-152</sup> 722.071	-152.700 22.071	+ 2.399	<sup>-36</sup> 438.501	-36.400 38.501	- 1.509	92.363899	33.305139					
1	724.022	24.022	- 0.448	438.941	38.941	+ 1.949	17.445568	46.818878					
27	721.623	21.623	- 1.951	440.450	40.450	- 0.440	78.917950	9.514120					
							96.363518	92.363899					
							42.819259	46.818878					
							3.999619	3.999619					
							1/2 = 1.9998095						
4	<sup>-152</sup> 770.834	-152.700 70.834	+ 0.447	<sup>-36</sup> 449.505	-36.400 49.505	- 1.949	22.128735	138.055466					
II	772.785	72.785	+ 1.504	449.945	49.945	+ 2.389	75.117280	173.883365					
5	772.338	72.338	- 1.951	451.894	51.894	- 0.440	101.245194	31.828720					
							101.245194	97.246015					
							169.884186	173.883365					
							3.999179	3.999179					
							1/2 = 1.9995895						

1

2

面積計算書		工区	Z	ブロック	ZL	計算者	精算者	備考
								陽切3.4.
点	①	②	③	④	⑤	⑥	③ × ⑤	② × ⑥
	X	X-(定数)	X <sub>n-1</sub> -X <sub>n+1</sub>	Y	Y-(定数)	Y <sub>n-1</sub> -Y <sub>n+1</sub>	+ -	+ -
14	<sup>-152</sup> 741.100	<sup>-152.700</sup> 41.100	+ 2.925	<sup>-36</sup> 588.106	<sup>-36.500</sup> 88.106	+ 0.667	257.710050	27.413700
15	740.429	40.429	- 3.596	591.031	91.031	+ 2.258	327.347476	91.288682
	737.504	37.504	+ 0.671	590.364	90.364	- 2.925	60.634244	109.699200
							327.347476	318.344294
							9.003182	9.003182
							1/2 4.501591	
17	<sup>-152</sup> 692.630	<sup>-152.600</sup> 92.630	- 0.671	<sup>-36</sup> 580.129	<sup>-36.500</sup> 80.129	+ 2.924	53.766559	270.850120
18	689.706	89.706	- 2.253	579.462	79.462	- 3.591	179.027886	322.134246
	690.377	90.377	+ 2.924	576.538	76.538	+ 0.667	223.797112	60.281459
							532.794445	322.134246
							8.997333	8.997333
							1/2 4.4986665	

陽切3.4

計年月日

計算者



検査者



B. NO. 24

各筆面積計算書

地番	算式	隅切	地積	摘要
	福富 408の2		673.97	
	" 405の9(1)		117.47	
	" 405の14		<del>117.96</del>	
	" 405の63		195.67	
	" 409		<del>196.59</del>	
	" 408の5		351.26	
	" 408の14		<del>349.82</del>	
	" 413の10		337.81	
	" 414の10)		517.77	
	" 415の10)		355.82	
	" 415の20		343.50	
	" 415の21		367.73	
	" 415の1(1)		377.36	
	" 414の1(1)		784.19	
	" 413の3		784.44	
	" 408の13		377.12	
	" 408の10		367.42	
	" 408の12		343.18	
	" 408の11		355.37	
	計		377.61	
	全体		199.88	
			264.19	
			7,511.78	
			7,511.85	
			0.07	

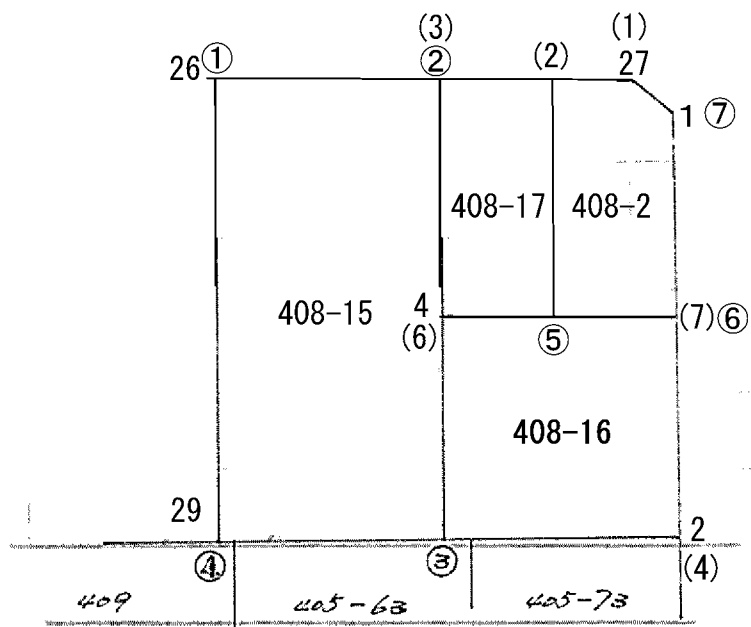

# 座標法面積計算 ( 408-15 )

測点	X	$\Delta x$	Y	$\Delta y$	(+) F <sub>1</sub>	(-) F <sub>2</sub>
					$\Delta x \cdot \Delta y$	$\Delta x \cdot \Delta y$
①	+ 716.258		+ 460.819			
②	+ 719.161	+ 2.903	+ 431.175	+ 914.994	2656.2752	
③	+ 744.473	+ 25.312	+ 469.990	+ 908.165	22987.47290	
④	+ 741.574	- 2.899	+ 469.635	+ 926.625		2686.01875
①	+ 716.258	- 25.316	+ 460.819	+ 923.454		23631.21164
	-	-	-	-		
	-	-	-	-		
	-	-	-	-		
	-	-	-	-		
	-	-	-	-		
	-	-	-	-		
	-	-	-	-		
	-	-	-	-		
	-	-	-	-		
	-	-	-	-		
				$\bar{z} =$	25640.70062	26317.607339
				$F = (F_1) \sim (F_2) =$	673.90277	
計算者				$F / 2 =$	336.951385	
点検者				$\times 0.3025 =$	102.0295	



# 面積計算書

工区

ブロック

A

計算者

精算者

備考

福富408-2

点	①	②	③	④	⑤	⑥	③ × ⑤		② × ⑥	
	X	X - (定数)	X <sub>n-1</sub> - X <sub>n+1</sub>	Y	Y - (定数)	Y <sub>n-1</sub> - Y <sub>n+1</sub>	+	-	+	-
1	721.623	11.623	0	440.450	10.450	0				
2	719.161	9.161	-11.002	451.175	21.175	-13.818		232.967350		176.586698
6	732.625	22.625	16.383	454.268	24.268	9.634		397.582644	217.969250	
7	735.544	25.544	8.602	441.541	11.541	15.327	99.275682		391.512888	
5	724.023	14.023	13.921	438.941	8.941	1.091	124.467661		15.299093	
11	721.623	11.623	4.862	440.450	10.450	-12.234	50.807900			142.195782
2	719.161	9.161	0	451.175	21.175	0				
								355.998751	355.998751	
								1/2	177.9993755	
									178.00	

# 面積計算書

工  
区

ブ  
ロック

計  
算  
者

精  
算  
者

備  
考

福富408-2

点	①	②	③	④	⑤	⑥	③ × ⑤		② × ⑥	
	X	X - (定数)	$X_{n-1} - X_{n+1}$	Y	Y - (定数)	$Y_{n-1} - Y_{n+1}$	+	-	+	-
(1)	721.623	1.623	0	440.450	10.450	0				
(2)	720.635	0.635	12.461	444.756	14.756	7.458	183.874516		4.735830	
⑤	734.084	14.084	14.909	447.908	17.908	-3.215	266.990372			45.280060
⑥	735.544	15.544	-10.062	441.541	11.541	-8.967		116.125542		139.383048
⑦	724.022	4.022	-13.921	438.941	8.941	-1.091		124.467661		4.388002
Y	721.623	1.623	-3.387	440.450	10.450	5.815		35.394150	9.437745	
Z	720.635	0.635	0	444.756	14.756	0				
							174.877535			174.877535
								174.877535 ÷ Z = 87.4387675		87.44 m <sup>2</sup>

# 面積計算書

工  
区

ブ  
ロ  
ック

計  
算  
者

精  
算  
者

備  
考

福富408-17

点	①	②	③	④	⑤	⑥	③ × ⑤		② × ⑥	
	X	X - (定数)	X <sub>n-1</sub> - X <sub>n+1</sub>	Y	Y - (定数)	Y <sub>n-1</sub> - Y <sub>n+1</sub>	+	-	+	-
(2)	720.635	10.635	0	444.756	4.756	0				
(3)	719.161	9.161	11.990	451.175	11.175	9.512	133.98825		87.139432	
4	732.625	22.625	14.923	454.268	14.268	-3.267	212.921364			73.915875
⑤	734.084	24.084	-11.990	447.908	7.908	-9.512		94.81692		229.087008
2	720.635	10.635	-14.923	444.756	4.756	3.267		70.973788	34.744565	
3	719.161	9.161	0	451.175	11.175	0				
							181.118906			181.118906
								181.118906 ÷ 2 = 90	559453	
									90.56	m <sup>2</sup>



# 公園字

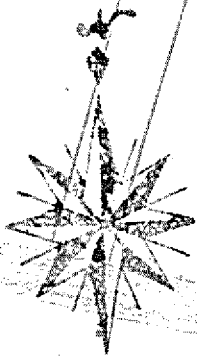

416-1

416-21

416-7

416-11

416-9

416-22

416-32

416-31

408-7

408-5

408-13

413-3

408-11

408-3

408-10

408-19

408-14

408-12

408-5

408-15

408-4

408-2

491 水

408-9

408-15

408-17

493

408-16

408-6

# 面積計算書

工  
区

フ  
ロ  
ッ  
ク

計  
算  
書

結  
算  
書

備 197

考 福富408-16

地 番	点	①	②	③	④	⑤	⑥	③	×	⑤	②	×	⑥
		X	X-(定数)	X <sub>n-1</sub> -X <sub>n,1</sub>	Y	Y-(定数)	Y <sub>n-1</sub> -Y <sub>n,1</sub>			+	-		+
B	9	720.427	10.427	0.	445.660	5.660	0.						
	2	719.161	9.161	-12.784	451.175	11.175	-8.742			142 861200			80 085462
	6	733.211	23.211	-15.299	454.402	14.402	2.329			220 336198	54 058419		
	8	734.460	24.460	12.784	448.846	8.846	8.742	113 087264			213 829320		
	9	720.427	10.427	15.299	445.660	5.660	-2.329	86 592340					24 284483
	2	719.161	9.161	0.	451.175	11.175	0.						
								199 679604	363 197398	267 887739	104 369945		
										163 517794	163 517794		
													81 758897 m <sup>2</sup>

1/2

# 面積計算書

工  
区フ  
ロ  
ツ  
ク計  
算  
書積  
算  
書

備 197

考

福富408-17

地 番	点	①	②	③	④	⑤	⑥	⑦	⑧	⑨	⑩
		X	X-(定数)	X <sub>n-1</sub> -X <sub>n.1</sub>	Y	Y-(定数)	Y <sub>n-1</sub> -Y <sub>n.1</sub>	+	-	+	-
C	1	721.623	1.623	0.	440.450	10.450	0.				
	9	720.427	0.427	-12.837	445.660	15.660	-8.396		201 027420		3 585092
	8	734.460	14.460	-15.648	448.846	18.846	3.999		294 902208	57 825540	
	7	736.075	16.075	10.438	441.661	11.661	9.905	121 717518		159 222875	
	5	724.022	4.022	14.452	438.941	8.941	1.211	129 215332		4 870642	
	1	721.623	1.623	3.595	440.450	10.450	-6.719	37 567750			10 904937
	9	720.427	0.427	0.	445.660	15.660	0.				
								288 500600	495 929628	221 919057	14 490029
									207 429028	207 429028	
								1/2		103 714514 m <sup>2</sup>	