

BLOCK NO. 29

街区計算

面地計算

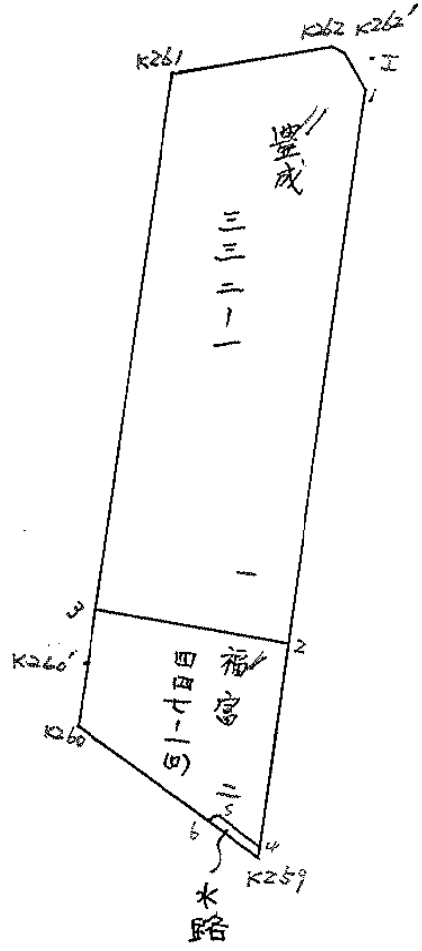

面積計算書

工区

2

ブロック

3-2P

計算者

精算者

備考

1 豊成 332-1
2 福島 447-1(0)

点	①	②	③	④	⑤	⑥	③ × ⑤		② × ⑥					
	X	X-(定数)	X _{n-1} -X _{n+1}	Y	Y-(定数)	Y _{n-1} -Y _{n+1}	+	-	+	-				
1	152,393.977	93.977	+54.249	571.721	71.721	+38.827			3890.792	529	3648.804	979		
2	152,444.039	144.039	+36.218	611.064	111.064	+56.976			4022.515	952	8206.766	066		
3	152,430.195	130.195	-62.026	628.697	128.697	-19.691	7982.560	122			2563.669	745		
K261	152,382.013	82.013	-41.576	591.373	91.373	-55.104	3798.923	848			4519.244	352		
K262	152,388.619	88.619	+7.777	573.593	73.593	-19.136			572.332	761	1695.813	184		
K262'	152,389.790	89.790	+5.358	572.237	72.237	-1.872			387.045	846	168.086	880		
							11781.483	976	8872.687	088	8946.814	161	11855.611	063
							2908.796	882				2908.796	882	
									$V_2 = 1454.398$	441				
2	152,444.039	44.039	+33.749	611.064	111.064	-1.990			3748.299	936	87.637	610		
K259	152,463.944	63.944	-3.112	626.707	126.707	+26.603	396.312	184				1701.102	232	
K260	152,440.927	40.927	-26.723	637.667	137.667	+7.432	3678.875	241				304.169	664	
K260'	152,437.221	37.221	-10.732	634.139	134.139	-8.970	1439.579	748				333.872	370	
3	152,430.195	30.195	+6.818	628.697	128.697	-23.075			877.656	146	696.749	625		
							5512.767	173	4262.75	082	1118.259	605	5005.271	696
							887.012	091				887.012	091	
									$V_2 = 443.506$	045				

面積計算書

工区

Z

ブロック

ZP

計算者



精算者



備考

福富 447-1 (P)
水路敷

点	①	②	③	④	⑤	⑥	③ × ⑤		② × ⑥	
	X	X-(定数)	X _{n-1} -X _{n+1}	Y	Y-(定数)	Y _{n-1} -Y _{n+1}	+	-	+	-
Z	-152, 444.03P	-152, 400 44.03P	+33.222	-36, 611.064	-36, 600 11.064	-2.404			367.568208	105.869756
4	463.417	63.417	+14.866	626.293	26.293	+17.431			390.871738	1,105.421727
5	458.905	58.905	-5.185	628.495	28.495	+3.134	147.746575			184.608270
6	458.232	58.232	-17.978	629.427	29.427	+9.172	529.038606			534.103909
K260	440.927	40.927	-21.011	637.667	37.667	+4.712	791.421337			192.848024
K260	437.221	37.221	-10.732	634.139	34.139	-8.970	366.379748			333.872370
3	430.195	30.195	+6.818	628.697	28.697	-23.075			195.656146	696.749625
									1,834.586266	954.096092
									880.490174	1,361.491751
									<u>1/2 = 440.245087</u>	2,016.931925
										880.490174
4	-152, 463.417	-152, 400 63.417	+5.039	-36, 626.293	-36, 600 26.293	-1.788			132.490427	113.389596
K259	463.944	63.944	-5.185	626.707	26.707	+3.134	138.495795			200.400496
6	458.232	58.232	-5.039	629.427	29.427	+7.788	148.282653			104.118916
5	458.905	58.905	+5.185	628.495	28.495	-3.134			147.746575	184.608270
									286.758448	280.227002
									6.521446	297.997866
										304.519312
										6.521446
									<u>1/2 = 3.260723</u>	

面積計算書

工区

2

ブロック

202P

計算者



精算者



備考

隅切I

点	①	②	③	④	⑤	⑥	③	×	⑤	②	×	⑥
	X	X-(定数)	X _{n-1} -X _{n+1}	Y	Y-(定数)	Y _{n-1} -Y _{n+1}	+		-	+		-
I	⁻¹⁵² 91.618	^{-152.300} 91.618	+ 4187	⁻³⁶ 569.867	^{-36.500} 69.867	- 0.516			292.533129	47.274889		
1	93.977	93.977	- 1.828	71.721	71.721	+ 2.370	131.105988					222.725490
K282	89.790	89.790	- 2.259	72.237	72.237	- 1.854	170.407083			166.470660		
							301.513071		292.133129	213.741148		222.725490
							8.979942					8.979942
									$\frac{1}{2} = 4.489971$			

