

BLOCK NO. 14-2

街区計算

画地略図

工区

ズ

ブロック

14-2

記入者



点検者



$$\begin{aligned} X &= -152,635.654 \\ Y &= -36,167.593 \end{aligned}$$

$$\begin{aligned} W &= 6.000 \\ 102-55-0 \\ L &= 61.134 \\ L &= 56.130 \end{aligned}$$

$$\begin{aligned} X &= -152,649.322 \\ Y &= -36,108.006 \\ (c.18) \end{aligned}$$

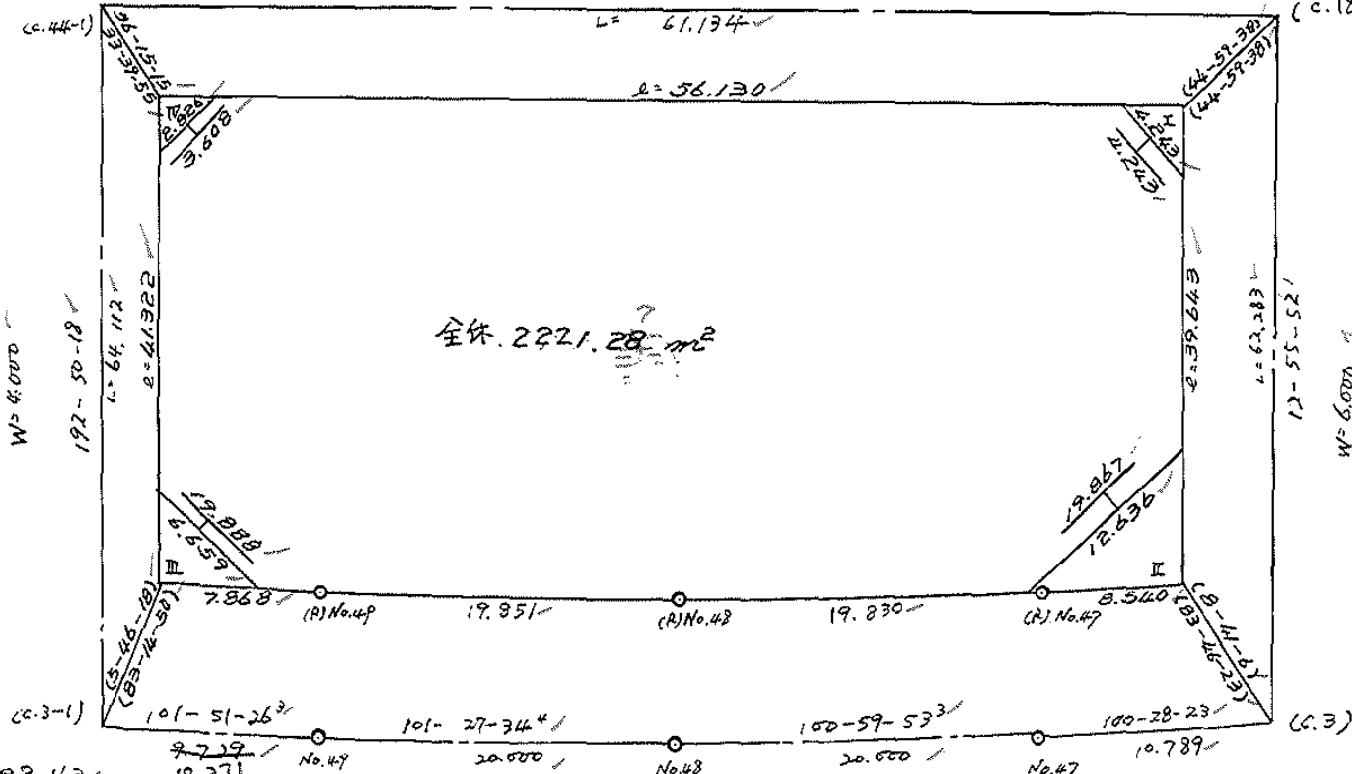

$$\begin{aligned} X &= -152,698.163 \\ Y &= -36,181.839 \end{aligned}$$

$$W = 39.500$$

$$\begin{aligned} X &= -152,710.025 \\ Y &= -36,101.944 \end{aligned}$$

面積計算書

工区

Z

ブロック

14-Z

計算者



精算者



備考

全体

点	①	②	③	④	⑤	⑥	③ ×	⑤	② ×	⑥
	X	X-(定数)	X _{n-1} -X _{n-1}	Y	Y-(定数)	Y _{n-1} -Y _{n-1}	+	-	+	-
I	-152. 651.575	-152.630 21.575	+51.187	-36 111.601	-36.110 1.601	- 45.837			81.950387	988.933275
II (R)	690.213	60.213	+37.085	120.473	10.473	+17.270			388.391205	1039.878510
NO.47 (R)	688.660	58.660	- 5.336	128.871	18.871	+ 27.864	100.695656			1634.502240
NO.48 (R)	684.877	54.877	- 7.728	148.337	38.337	+ 38.921	296.268336			2135.867717
NO.49 (R)	680.932	50.932	- 5.562	167.792	57.792	+ 27.155	321.439104			1383.058460
III	679.315	49.315	- 41.906	175.492	65.492	- 1.482	2744.507752		73.084830	
IV	639.026	9.026	- 27.740	166.310	56.310	- 63.891	1562.039400		576.680166	
...							111.210			
							5024.950248		470.341592	1638698271
							4554.608656			4554.608656
							1/2 = 2277.304328			
			I	II	III	IV				
			2277.30	- (4.50	+ 38.26	+ 11.27	+ 1.99)			= 2221.28
					56.020					

面地計算

画地略図

工区

2

ブロック

14-2

記入者

点検者

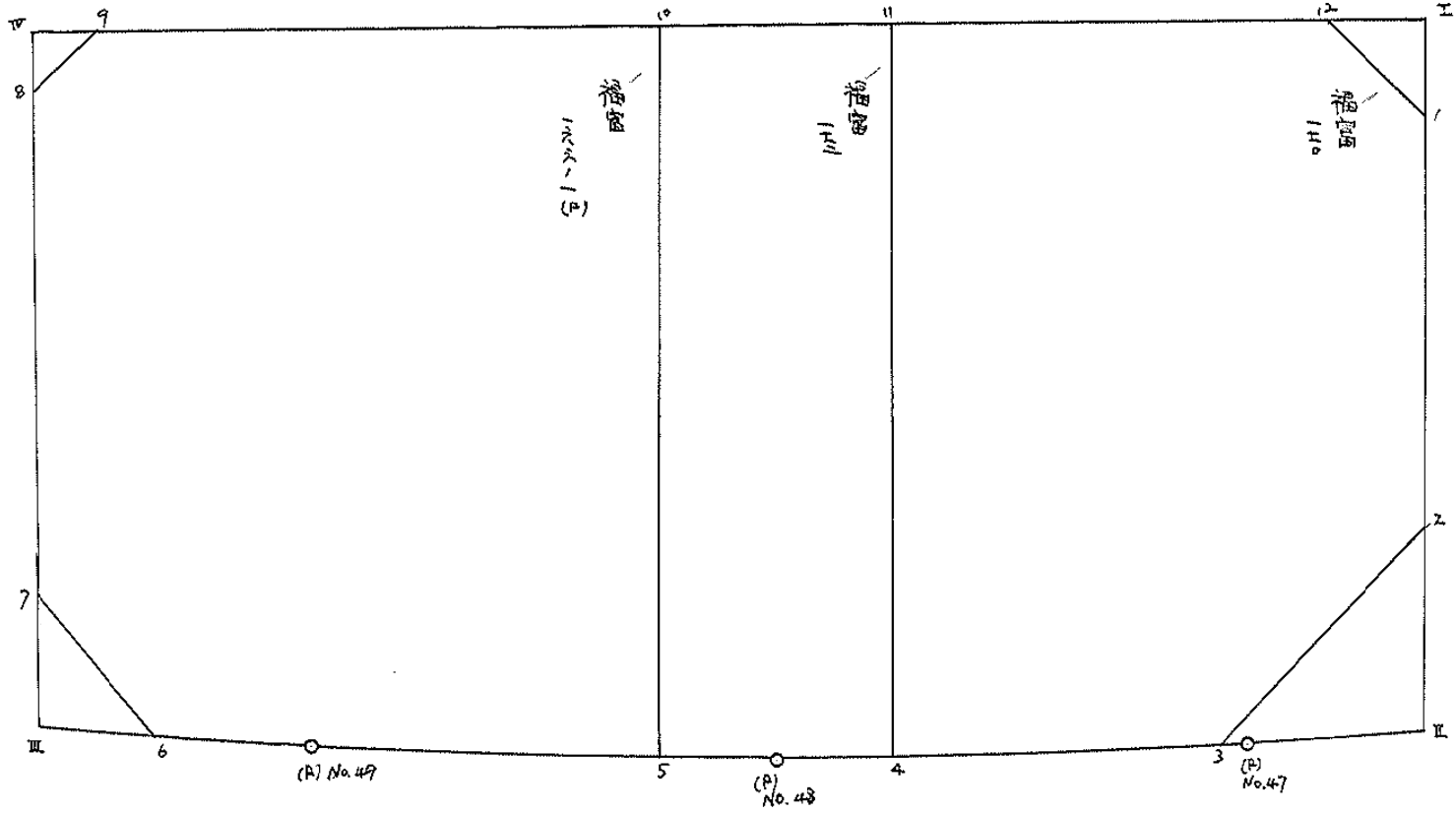

面積計算書

工区 2

ブロック

14-2

計算者

三和測量

精算者

監理者

備考

福富

170

172

点	① X	② X-(定数)	③ X _{n-1} -X _{n-1}	④ Y	⑤ Y-(定数)	⑥ Y _{n-1} -Y _{n-1}	⑦ +	⑧ +	⑨ -	
1	-152, 654.499	-152.640 14.499	+30.280	-36, 112.272	-36.110 2.272	+3.990	69.932160		57.851010	
2	681.684	41.684	+34.121	118.515	8.515	+16.805	290.540315		200.499620	
3	688.620	48.620	+4.204	129.077	19.077	+24.619	80.199708		1196.975780	
4	685.888	45.888	-42.208	143.134	33.134	+5.023	1398.453604		230.495424	
11	646.414	6.414	-34.984	134.100	24.100	-28.609	843.114400	183.498126		
12	650.904	10.904	+8.085	114.525	4.525	-21.828	36.584625	238.012512		
							2241.568004	477.256808	421.510638	2185.821834
							1764.311196		1764.311196	
							1/2 = 882.155598			
4	-152, 685.888	-152.640 45.888	+38.463	-36, 143.134	-36.130 13.134	+14.237	505.173042		653.307456	
(P) No.48	684.877	44.877	-1.906	148.337	18.337	+9.617	34.950322		431.582109	
5	683.982	43.982	-40.654	152.751	22.751	-4.686	924.919154	206.099652		
10	644.223	4.223	-37.568	143.651	13.651	-18.651	512.840768	78.763173		
11	646.414	6.414	+41.665	134.100	4.100	-0.517	170.826500	3.316038		
							1472.710244	675.999542	288.1788631084	889.565
							796.710702		796.710702	
							1/2 = 398.355351			

面積計算書

工区 2

ブロック

14-2

計算者



精算者



備考

福富 166-1 (四)

点	①	②	③	④	⑤	⑥	③	×	⑤	②	×	⑥
	X	X-(定数)	X _{n-1} -X _{n+1}	Y	Y-(定数)	Y _{n-1} -Y _{n+1}	+		-	+		-
5	-152, 683.982	-152.630 53.982	+36.709	-36, 152.751	-36.140 12.751	+24.141			468.076459			1303.179462
(A) No.49	680.932	50.932	-3.691	167.792	27.792	+18.092	102.380272					921.461744
6	680.291	50.291	-6.248	170.843	30.843	+6.644	192.707064					334.133404
7	674.684	44.684	-39.315	174.436	34.436	-4.089	133.851340			182.712876		
8	640.976	10.976	-35.211	166.754	26.754	-10.075	942.035094			110.583200		
9	639.473	9.473	+3.247	164.361	24.361	-23.103		79.100167		218.834719		
10	644.223	14.223	+44.509	143.651	3.651	-11.610		162.502359		165.129030		
							2591.173770		709.678985	677.279875		2558.774610
							1881.494735					1881.494735
							1/2 = 940.7473925					

面積計算書

工区

2

ブロック

14-2

計算者



精算者



備考

橋功 I. II

点	① X	② X-(定数)	③ X _{n-1} -X _{n+1}	④ Y	⑤ Y-(定数)	⑥ Y _{n-1} -Y _{n+1}	③ ×	⑤	② ×	⑥
							+	-	+	-
I	-152 631.575	-152.650 1.575	+3.595	-36 111.601	-36.110 1.601	-2.253		5.755595	3.548475	
1	654.499	4.499	-0.671	112.272	2.272	+2.924	1.524512			13.155076
1B	650.904	0.904	-2.924	114.525	4.525	-0.671	13.231100		0.606584	
							14.735612	5.755595	4.155059	13.155076
							9.000017			9.000017
							1/2 = 4.5000085			
2	-152 681.684	-152.680 1.684	+4.593	-36 118.515	-36.110 8.515	-8.604		13.564395	14.489136	
II	690.213	10.213	+6.976	120.473	10.473	+10.356		73.059648		105.765828
(R) 10.47	688.660	8.660	-4.593	128.871	18.871	+8.604	30.061303			74.510640
3	688.620	8.620	-6.976	129.077	19.077	-10.356	133.081152		89.268720	
							163.142655	86.624043	103.757856	180.276468
							76.518612			76.518612
							1/2 = 38.259306			

面積計算書

工区

2

ブロック

14-E

計算者



精算者



備考

精功. III. IV

点	①	②	③	④	⑤	⑥	③ ×	⑤	② ×	⑥
	X	X-(定数)	X _{n-1} -X _{n+1}	Y	Y-(定数)	Y _{n-1} -Y _{n+1}	+	-	+	-
6	-152 680.298	-152.670 10.298	+ 4.63	-36 170.843	-36.170 0.843	+ 1.056		3.903933		10.867296 10.866245
Ⅱ	679.315	9.315	-5.608	175.492	5.492	+ 3.593	30.773644 30.788152			33.468795
7	674.684	4.684	+ 0.975	174.436	4.436	- 4.649	30.773644 30.788152 22.560175 22.559119	4.327536 4.325100	21.775916	44.336091 44.335035 22.560175 22.559119
							1/2 = 11.2795595 11.2800875			
Ⅳ	-152 639.025	-152.630 9.026	- 1.503	-36 166.310	-36.160 16.310	- 2.393	9.483930		21.599218	
9	639.473	9.473	+ 1.950	164.361	4.361	+ 0.444		8.503950		4.206012
8	640.976	10.976	- 0.447	166.754	6.754	+ 1.949	3.019038 12.502968 3.999018	8.503950	21.599218	21.392224 25.598236 3.999018
							1/2 = 1.9995091			

