

BLOCK NO. 15

街 区 計 算

圖地計算

画地略図

工区

21

ブロック

15

記入者

点検者

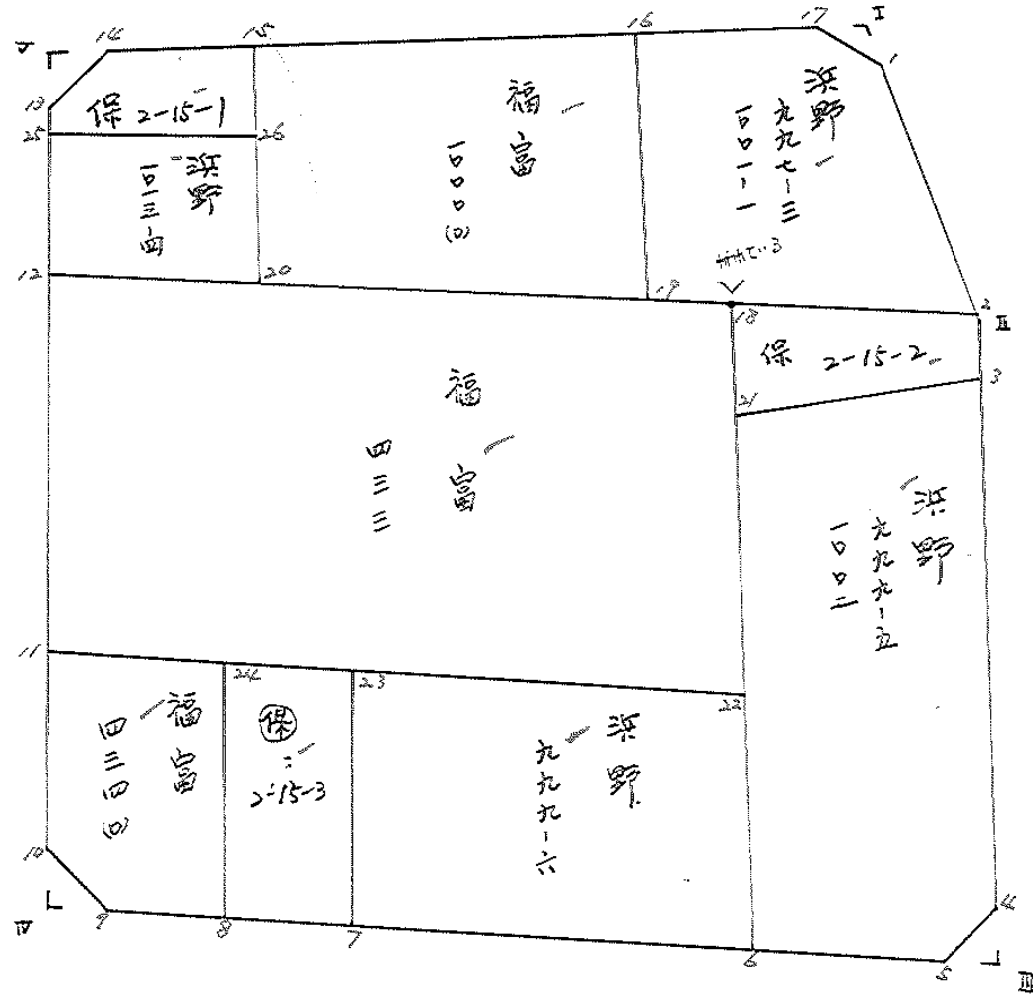

面積計算書

工区

γ

ブロック

15

計算者



精算者



備考

浜野 997-3.1001-1. 保 2-15-2

点	①	②	③	④	⑤	⑥	③ ×	⑤	② ×	⑥
	X	X-(定数)	X _{n-1} -X _{n+1}	Y	Y-(定数)	Y _{n-1} -Y _{n+1}	+	-	+	-
16	-152, 553.157	-152, 550 3.157	-23.068	-36, 126.102	-36, 120 26.102	-23.086	602.120936		72.882502	
17	555.652	5.652	+5.862	105.960	5.960	-23.217		34.937520	131.222484	
1	559.019	9.019	+28.908	102.885	2.885	-3.905		83.399580	35.219195	
2	584.560	34.560	+20.997	102.055	2.055	+20.513		43.148835		708.929280
18	580.016	30.016	-5.840	123.398	23.398	+26.991	136.644320			810.161856
19	578.720	28.720	-26.859	129.046	29.046	+2.704	780.146514			77.658880
							1578.911770	161.485935	239.324181	1596.750016
							1357.425935			1357.425935
							1/2 = 678.7129 175			
18	-152, 580.016	-152, 580 0.016	-3.913	-36, 123.398	-36, 120 23.398	-22.293	91.556374		0.356688	
2	-152, 584.560	-152, 580 4.560	+5.665	-36, 102.055	-36, 100 2.055	-21.379		11.641575	97.488240	
II	-152, 585.681	-152, 580 5.681	+6.363	-36, 100.019	-36, 100 2.019	+0.707		12.846897		4.016467
3	-152, 590.923	-152, 580 10.923	+2.792	-36, 102.762	-36, 100 2.762	+22.329		7.711504		243.899667
21	-152, 588.473	-152, 580 8.473	-10.907	-36, 124.348	-36, 120 24.348	+20.636	255.563636			174.848800
							257.120010	32.199876	97.844922	422.764962
							324.920034			324.920034
							1/2 = 162.460017			

面積計算書

工区

2

ブロック

15

計算者



精算者



備考

浜野 999-5 .1002. 浜野 999-6

点	①	②	③	④	⑤	⑥	③ × ⑤	② × ⑥
	X	X-(定数)	X _{n-1} -X _{n+1}	Y	Y-(定数)	Y _{n-1} -Y _{n+1}	+	-
21	-152,588.473	-152,590 8.473	- 50.215	-36,124.348	-36,100 24.348	- 27.506	1222.634820	233.058338
3	-152,590.923	10.923	+ 54.224	-36,102.762	2.762	- 14.251	149.766689	145.663673
4	-152,642.697	62.697	+ 54.074	-36,110.097	10.097	+ 10.680	545.985179	669.603960
5	-152,644.997	64.997	- 1.559	-36,113.442	13.442	+ 20.171	20.256078	1311.054487
6	-152,641.138	61.138	- 56.524	-36,130.268	30.268	+ 10.906	1710.868432	666.771028
							2954.459330	398.722011
							2258.707464	2647.429675
								2258.707464
								分筆後の座標なし
								1/2 = 1129.353732
22	-152,610.931	-152,600 10.931	- 36.425	-36,126.877	-36,120 6.877	+ 23.695	250.349025	259.010065
23	-152,604.713	4.713	+ 23.225	-36,153.963	33.963	+ 33.831	788.790675	159.445503
7	-152,634.156	34.156	+ 36.425	-36,160.704	40.704	- 23.695	1482.643200	809.326420
6	-152,641.138	41.138	- 23.225	-36,120.268	10.268	- 33.831	238.470300	1391.739678
							488.823325	2271.433975
								2201.066098
								1782.610550
								1782.610550
								1/2 = 891.305275

面積計算書

工区

ブロック

計算者

精算者

備考

⑧ 2-15-3

福富434(10)

点	①	②	③	④	⑤	⑥	③ × ⑤	② × ⑥
	X	X-(定数)	X _{n-1} -X _{n+1}	Y	Y-(定数)	Y _{n-1} -Y _{n+1}	+ -	+ -
23	-152,604.713	-152,600- 4.713	-32.234	-36,153.963	-36,150- 2.963	+ 5.416	127.743342	25.525608
24	-152,601.922	1.922	+26.654	-36,166.120	16.120	+ 18.899	429.662480	36.323878
2	-152,631.367	31.367	+ 32.234	-36,172.862	22.862	- 5.416	736.733708	169.883672
7	-152,634.156	34.156	- 26.654	-36,160.704	10.704	- 18.899	285.304416	645.516244
							412.047758	1166.596188
							753.548430	753.548430
							1/2 = 376.774215	
8	-152,631.367	-152,590- 41.367	+ 26.432	-36,172.862	-36,160- 12.862	+ 19.880	339.968384	22.375960
9	-152,628.354	38.354	- 6.608	-36,186.000	26.000	+ 15.392	171.808000	590.344768
10	-152,624.759	34.759	- 30.118	-36,188.254	28.254	- 3.821	850.953972	132814139
11	-152,598.236	8.236	- 22.837	-36,182.179	22.179	- 22.134	506.501823	182.295624
24	-152,601.922	11.922	+ 33.131	-36,166.120	6.120	- 9.317	202.761720	111.072744
							1529.262795	542.730104
							986.533691	426.187037
							1/2 = 493.2668455	

面積計算書

工区

→

ブロック

15

計算者



精算者



備考

保 2-15-1

浜野 1013-4-

点	①	②	③	④	⑤	⑥	③ ×	⑤	② ×	⑥
	X	X-(定数)	X _{n-1} -X _{n+1}	Y	Y-(定数)	Y _{n-1} -Y _{n+1}	+	-	+	-
25	-152, 553.182	-152, 540 13.182	- 4.496	36, 171.860	-36, 150 21.860	+ -4.531	98.282560			191.547642
13	550.570	10.570	- 5.167	171.262	21.262	- 4.245	109.860754		44.869650	
14	548.015	8.015	- 1.060	167.615	17.615	- 15.716	18.671900		125.963740	
15	549.510	9.510	+ 7.051	155.546	5.546	- 10.884		39.104846	103.506840	
26	555.066	15.066	+ 3.672	156.731	6.731	+ 16.314		24.716232		245.786724
							226.815214	63.821078	274.340230	437.334366
							162.994136			162.994136
							$\frac{1}{2} = 81.497068$			
25	-152, 553.182	-152, 550 3.182	+ 13.046	36, 171.860	-36, 150 21.860	+ 18.548		285.185560		59.019736
13	568.112	18.112	+ 18.378	175.279	25.279	- 11.610		464.577462	210.280320	
20	571.560	21.560	- 13.046	160.250	10.250	- 18.548	133.721600		399.894880	
26	555.066	5.066	- 18.378	156.731	6.731	+ 11.610	123.702318			58.816260
							267.423818	749.763022	610.175200	117.835996
								492.339204	492.339204	
							$\frac{1}{2} = 246.169602$			

面積計算書

工
区

2

ブ
ロ
ック

15

計
算
者



精
算
者



備
考

福富 1000 (D)

福富 433

点	①	②	③	④	⑤	⑥	③ ×	⑤	② ×	⑥
	X	X-(定数)	X _{n-1} -X _{n+1}	Y	Y-(定数)	Y _{n-1} -Y _{n+1}	+	-	+	-
15	549.510	9.510	+ 18.403	155.526	35.546	+ 34.148		654.153038		324.747486
20	571.560	31.560	+ 29.210	160.250	40.250	- 26.500		1175.702500	836.340000	
19	578.720	38.720	- 18.403	129.046	9.046	- 34.148	166.473538		1322.210560	
16	553.157	13.157	- 29.210	126.102	6.102	+ 26.500	178.239420			348.660500
							344.712958	1829.855538	2158.550560	673.407980
								1485.142580	1286.142580	
								$\frac{1}{2} = 742.571290$		
12	568.112	18.112	- 18.220	175.279	55.279	- 58.781	1007.183380		1064.641472	
18	580.016	30.016	+ 42.819	123.398	3.398	- 48.406		145.498962	1452.954496	
22	610.931	60.931	+ 18.220	126.873	6.873	+ 58.781		125.226060		3581.585111
11	598.236	48.236	- 42.819	182.179	62.179	+ 48.406	2662.442601			2334.911816
							3669.625981	270.725022	2617.525968	5916.496927
							3398.900959			3398.900959
								$\frac{1}{2} = 1699.4504795$		

面積計算書

工
区

2

ブ
ロ
ック

15

計
算
者



精
算
者



備
考

陽切 I

Ⅱ

点	①	②	③	④	⑤	⑥	③ × ⑤		② × ⑥	
	X	X-(定数)	X _{n-1} -X _{n+1}	Y	Y-(定数)	Y _{n-1} -Y _{n+1}	+	-	+	-
17	-152,555.652	5.652	-2.998	-36,105.960	5.960	+0.097	17.868080			0.548244
I	-152,556.021	6.021	+3.367	-36,102.982	2.982	-3.075		10.040394	18.514575	
1	-152,559.019	9.019	-0.369	-36,102.885	2.885	+2.978	1.064565			26.858582
							18.932645	10.040394	18.514575	27.406826
							8.892251			8.892251
										$\frac{1}{2} = 4.4461255$
4	-152,642.698	2.698	+0.671	-36,110.097	0.097	-2.924		0.065087	7.888952	
II	-152,645.668	5.668	+2.299	-36,110.518	0.518	+3.345		1.190882		18.959460
5	-152,644.997	4.997	-2.970	-36,113.440	3.440	-0.421	10.222740		2.103737	
							10.222740	1.255969	9.992689	18.959460
							8.966771			8.966771
										$\frac{1}{2} = 4.4833855$

面積計算書

工
区

2

ブ
ロ
ック

15

計
算
者



精
算
者



備
考

陽切 Ⅲ

点	①	②	③	④	⑤	⑥	③	×	⑤	②	×	⑥
	X	X-(定数)	X _{n-1} -X _{n+1}	Y	Y-(定数)	Y _{n-1} -Y _{n+1}	+		-	+		-
Ⅱ	152,642.697	2.697	+ 0.671	36,110.097	0.097	- 2.924			0.065087	7.886028		
Ⅲ	152,645.668	5.668	+ 2.300	36,110.518	0.518	+ 3.345			1.191400			18.959460
Ⅴ	152,644.997	4.997	- 2.971	36,112.442	3.442	- 0.421	10.226182			2.103737		
							10.226182		1.256487	9.989765		18.959460
							8.969695					8.969695
									1/2 = 4.4848475			

面積計算書

工区

2

ブロック

15

計算者



精算者



備考

陽切

IV

V

点	①	②	③	④	⑤	⑥	③ ×	⑤	② ×	⑥
	X	X-(定数)	X _{n-1} -X _{n+1}	Y	Y-(定数)	Y _{n-1} -Y _{n+1}	+	-	+	-
10	-152,644.759	-152,624. 0.759	+0.671	-36,188.254	-36,185. 3.254	-2.924		2.183424	2.219316	
9	-152,628.254	4.354	+2.924	-36,186.000	1.000	+0.670		2.924000		2.917180
10	-152,627.683	3.683	-2.595	-36,188.924	3.924	+2.254	14.106720			2.321482
							14.106720	5.107424	2.219316	11.218662
							2.999346			8.999346
								1/2 = 4.499673		
13	-152,550.570	-152,545. 5.570	-0.369	-36,171.262	-36,165. 6.262	+2.977	2.310678			16.521290
7	-152,547.646	2.646	-2.555	-36,170.542	5.592	-3.647	14.287560		9.649962	
14	-152,548.015	3.015	+2.924	-36,167.615	2.615	+0.670		7.646260		2.020250
							16.598238	7.646260		18.601940
							2.951972			2.951972
								1/2 = 4.475989		

計年月
算日

計算者



検査者



B.NO. 15

各筆面積計算書

地番	算式	隅切	地積	摘要
	浜野 997-3 1001-1 /		678 71 //	
	保 2-15-2 /		162 46 //	
	浜野 999-5 1002 /		1129 35 //	
	' 999-6 /		891 30 //	
	保 2-15-3 /		376 77 //	
	福富 434 (D) /		493 26 //	
	' 433 /		1699 45 //	
	浜野 1013-4 /		266 16 //	
	保 2-15-1 /		81 49 //	
	福富 1000 (D) /		742 57 //	
	隅切 /	I 4 44 //		
		II 4 48 //		
		III 4 47 //		
		IV 4 47 //		
		V 4 47 //		
		17 88 //		
	計		6501 52 //	
	全体		6501 65 //	
	差		- 0 13 //	