

**BLOCK NO. 73**

**街 区 計 算**



# 面積計算書

工区

3

ブロック

73

計算者



精算者



備考

全体

点	①	②	③	④	⑤	⑥	③ × ⑤		② × ⑥		
	X	X-(定数)	X <sub>n-1</sub> -X <sub>n+1</sub>	Y	Y-(定数)	Y <sub>n-1</sub> -Y <sub>n+1</sub>	+	-	+	-	
	-152	-151.950		-38	-38.100						
I	002.941	52.941	+69.972	145.204	45.204	-33.205		3163.014289	1757.905905		
II	015.196	115.196	+31.218	159.478	59.478	+149.523		1856.704206		17224.651508	
III	034.159	84.159	-95.518	294.727	194.727	+140.039	10599.933586			11785.542201	
IV	-151	969.478	19.678	-62.978	299.517	199.517	-1.741	12565.181626		26.259398	
K129	971.181	21.181	+14.709	292.986	192.986	-56.159		2839.631076	1189.503779		
K130	984.387	34.387	+23.600	243.358	143.358	-97.893		2383.248800	3366.266591		
K131	996.781	46.781	+10.837	195.093	95.093	-50.675		1030.522861	2269.277175		
K132	995.224	45.224	+8.160	192.683	92.683	-49.889		756.293280	2256.180136		
								31165.115212	13028.494487	10873.372986	29009.993709
								18136.620725			18136.620725
								x 1/2 = 9068.3103625			

# 面地計算

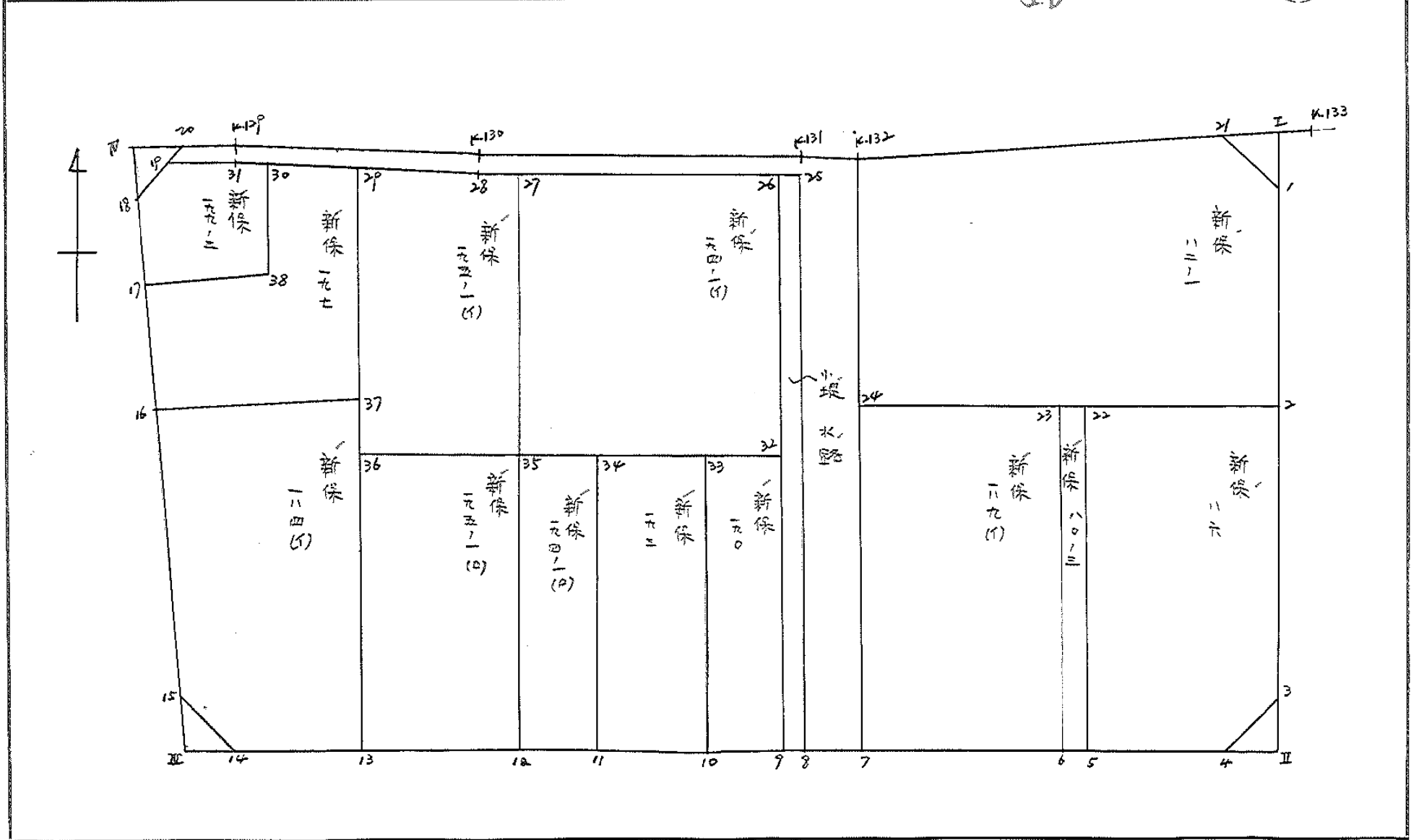

# 面積計算書

工区 3

ブロック 73

計算者



精算者



備考

新係

82-1  
86

点	①	②	③	④	⑤	⑥	③ × ⑤	② × ⑥
	X	X-(定数)	X <sub>n-1</sub> -X <sub>n+1</sub>	Y	Y-(定数)	Y <sub>n-1</sub> -Y <sub>n+1</sub>	+ -	+ -
1	-152.005.865	-151.990.15.865	+29.293	-38.145.874	-38.140.5.874	+ 3.645	172.067082	57.827925
2	031.753	41.753	+15.177	151.810	11.810	+ 52.725	179.240370	2201.426925
24	021.042	31.042	-36.529	198.599	58.599	+ 40.873	2140552871	1268.779666
K.132	-151.995.224	5.224	-18.582	192.683	52.683	- 50.434	978.955306	263.467216
21	-152.002.460	12.460	+ 10.641	148.165	8.165	- 46.899	86.883765	583.240140
							3119.518377	438.191217
							846.707356	3528.034516
							2681.327160	2681.327160
							1/2 = 1340.663580	
2	-152.031.753	-152.020.11.753	+36.408	-38.151.810	-38.150.1.810	- 18.731	65.898480	220.145443
3	062.271	42.271	+32.772	158.807	8.807	+ 10.592	288.623004	447.734432
4	064.525	44.525	- 2.979	162.402	12.402	+ 26.399	36.945558	1175.415475
5	059.292	39.292	-38.662	185.206	35.206	+ 15.136	1361.134372	594.723712
22	025.863	5.863	- 27.539	177.538	27.538	- 33.396	758.368982	195.800748
							2156.448912	354.522484
							415.946191	2217.873619
							1801.926428	1801.927428
							1/2 = 900.963214	

# 面積計算書

工区 3

ブロック

73

計算者



精算者



備考

新保

80-3  
189-(1)

点	①	②	③	④	⑤	⑥	⑧	⑤	②	⑥
	X	X-(定数)	X <sub>n-1</sub> -X <sub>n+1</sub>	Y	Y-(定数)	Y <sub>n-1</sub> -Y <sub>n+1</sub>	+	-	+	-
5	-152.020 059.292	-152.020 39.292	+33.183	-38.170 185.206	-38.170 15.206	+8.740		504.580.698		343.412.080
6	059.046	39.046	-33.674	186.278	16.278	-6.595	548.145372		257.508370	
23	025.618	5.618	-33.183	178.611	8.611	-8.740	285.738813		49.101320	
22	025.863	5.863	+33.674	177.538	7.538	+6.595		253.834612		38.666485
								833.884185758.415310	306.609690	382.078565
								75.468875		75.468875
								1/2=37.7344375		
6	-152.020 059.046	-152.020 39.046	+28.843	-38.170 186.278	-38.170 16.278	+27.645		469.506354		1079.465716
7	054.461	34.461	-38.004	206.257	36.257	+12.321	1377.911028		02.208191426593981	
24	021.042	1.042	-28.843	198.599	28.599	-27.645	824.880957		28.807132	
23	025.618	5.618	+38.004	178.611	8.611	-12.321		327.25244469.219378		02.208191426593981
								2202.791985796.758798	98.026510	1504.059697
								1406.033187		1406.033187
								1/2=703.0165935		





# 面積計算書

工区 3

ブロック

73

計算者



精算者



備考

新保

17°  
193

点	①	②	③	④	⑤	⑥	③ ×	⑤	② ×	⑥	
	X	X-(定数)	X <sub>n-1</sub> -X <sub>n+1</sub>	Y	Y-(定数)	Y <sub>n-1</sub> -Y <sub>n+1</sub>	+	-	+	-	
9	-152, 053.678	-152.020 33.678	+26.768	-38 209.668	-38.200 9.668	+17.419		258.793024		586.637087	
10	051.218	31.218	-31.694	220.390	20.390	+4.034	646.240660			125.933412	
33	021.984	1.984	-26.768	213.702	13.702	-17.419	-366.275136		34.559296		
32	024.450	4.450	+31.694	202.971	2.971	-4.034		94.162874	17.951300		
								1013.015796	352.955898	52.510596	712.570494
								660.059898			660.059898
								Y <sub>2</sub> =330.029999			
10	-152, 051.218	-152.000 51.218	+23.889	-38, 220.390	-38.200 20.390	+29.980		487.096710		1535.515640	
11	045.873	45.873	-34.588	243.682	43.682	+16.613	1510.873016			762.088149	
34	016.630	16.630	-23.889	227.003	37.003	-29.980	883.964667		498.567400		
33	021.984	21.984	+34.588	213.702	13.702	-16.613		473.924776	365.220192		
								2394.837683	961.021486	867.787592	2297.603789
								1433.816197			1433.816197
								Y <sub>2</sub> =716.9080985			



# 面積計算書

工区 3

ブロック

73

計算者



簡算者



備考

新保

199-3

195-1 (9)

点	①	②	③	④	⑤	⑥	⑦ ×	⑧	⑨ ×	⑩	
	X	X-(定数)	X <sub>n-1</sub> -X <sub>n+1</sub>	Y	Y-(定数)	Y <sub>n-1</sub> -Y <sub>n+1</sub>	+	-	+	-	
17	-151.987.690	-151.970 17.690	-14.272	-38.298.179	-38.280 18.179	+11.089	259.450688			196.164410	
18	972.670	2.670	-16.529	299.294	19.294	-0.643	3189.10526			1.716810	
19	971.161	1.161	-0.518	297.536	17.536	-6.067	9.083648			7.043787	
31	972.152	2.152	+3.091	293.227	13.227	-12.200		40.884657		26.254400	
30	974.252	4.252	+14.790	285.336	5.336	-5.022		78.919440		21.353544	
38	986.942	16.942	+13.438	288.205	8.205	+12.843		110.258790		217.586106	
								587.444862	230.062887	56.368541	413.750516
								357.381975			357.381975
								Y <sub>2</sub> = 178.6909875			
29	-151.979.314	-151.970 9.314	-23.010	-38.266.312	-38.230 36.312	-29.363	835.539120			273.486982	
28	985.359	15.359	+6.885	243.592	13.592	-26.620		93.580920		408.856580	
27	986.199	16.199	+29.166	239.692	9.692	+2.571		282.676872		41.647629	
35	-152.014.525	-152.014 44.525	+22.170	246.163	16.163	+33.263		358.333710		1481.035075	
36	-152.028.369	-152.028 38.369	-35.211	272.955	42.955	+20.149	1512.488535			773.096981	
								2348.027625	734.591502	682.343562	2295.779685
								1613.436123			1613.436123
								Y <sub>2</sub> = 806.7180615			

# 面積計算書

工区 3

ブロック

73

計算者



精算者



備考

新保

184 (1)

1P7

点	①	②	③	④	⑤	⑥	③	⑤	②	⑥	
	X	X-(定数)	X <sub>n-1</sub> -X <sub>n-1</sub>	Y	Y-(定数)	Y <sub>n-1</sub> -Y <sub>n-1</sub>	+	-	+	-	
13	-152, 037.621	-152.000 37.621	+29.015	-38, 279.643	-38.270 9.643	+19.431		279.791645		731.013651	
14	074.830	34.830	-6.454	291.802	21.802	+15.306	140.710108			533.107980	
15	031.167	31.167	-27.199	294.949	24.949	+4.896	678.587851			152.593632	
16	007.631	7.631	-25.352	296.698	26.698	-22.578	676.847696		172.292718		
37	005.815	5.815	+29.990	272.371	2.371	-17.055		71.106290	99.174825		
								1496.145655	350.897935	271.467543	1416.715263
								1145.247720			1145.247720
								1/2 = 572.623860			
16	-152, 007.631	-151.970 37.631	-18.125	-38, 296.698	-38.260 36.698	+25.808	665.151250			971.180848	
17	-151, 987.690	17.690	-20.689	298.179	38.179	-8.493	789.885331		150.241170		
38	986.942	16.942	-13.438	288.205	28.205	-12.843	379.018790		217.586106		
30	974.252	4.252	-7.628	285.336	25.336	-21.893	193.263008		93.089036		
29	979.314	9.314	+31.563	266.312	6.312	-12.965		199.225656	120.756010		
37	-152, 005.815	35.815	+28.317	272.371	12.371	+30.386		350.309607		1088.274590	
								2027.318379	549.535263	581.672322	2059.455438
								1477.783116			1477.783116
								1/2 = 738.891558			

# 面積計算書

工区

3

ブロック

73

計算者



精算者



備考

水鏡各

点	①	②	③	④	⑤	⑥	③	×	⑤	②	×	⑥
	X	X-(定数)	X <sub>n-1</sub> -X <sub>n+1</sub>	Y	Y-(定数)	Y <sub>n-1</sub> -Y <sub>n+1</sub>	+		-	+		-
20	-151.970 970.351	-151.970 0.351	+ 0.020	-38.190 296.593	-38.190 108.593	- 4550			2.131860	1.597050		
K-129	971.181	1.181	+ 14.038	292.986	102.986	-57.235			1445.511496	62.870535		
K-130	984.387	14.387	+ 23.600	243.358	53.358	-97.893			1259.248800	1408.386591		
K-131	994.781	24.781	+ 10.837	195.093	5.093	-30.673			55.192841	1253.777175		
K-132	995.224	25.224	+ 59.680	192.683	2.683	+ 11.164			160.121440			281.600736
7	-151.970 054.461	84.461	+ 58.678	206.257	16.257	+ 16.011			953.928246			1352.305071
8	053.902	83.902	- 58.717	208.694	18.694	- 10.890	1097.655598			913.692780		
25	-151.970 995.744	25.744	- 68.543	195.367	3.367	+ 34.898	367.870281					898.41412
28	985.359	15.359	- 23.592	243.592	53.592	+ 97.860	1264.342464					1503.031740
31	972.152	2.152	- 14.198	293.227	103.227	+ 53.944	1465.616946					116.087488
19	971.161	1.161	- 1.861	297.536	107.536	+ 3.366	193.672336					3.907926
			166.851			217.243	4389.157625	3876.134683	3642.324131	4155.347073		
							513.022942					513.022942
						1/2	256.511471					

# 面積計算書

工区 3

ブロック

73

計算者



精算者



備考

スリット

I II

点	①	②	③	④	⑤	⑥	③	×	⑤	②	×	⑥
	X	X-(定数)	X <sub>n-1</sub> -X <sub>n+1</sub>	Y	Y-(定数)	Y <sub>n-1</sub> -Y <sub>n+1</sub>	+	-	+	-		
I	-152, 002.941	-152.000 2.941	+3.405	-38, 145.204	-38.140 5.204	-2.291			17.719620	6.737831		
1	005.865	5.865	-0.481	145.874	5.874	+2.961	2.825394					17.366265
2	002.460	2.460	-2.924	148.165	8.165	-0.670	23.874460			1.648200		
							26.699854	17.719620		8.386031		17.366265
							8.980234					8.980234
							1/2=4.490117					
II	-152, 065.196	-152.060 5.196	+2.234	-38, 159.478	-38.150 9.478	+3.593			21.363412			18.679620
4	064.525	4.525	-2.923	162.402	12.402	-0.671	36.275850			3.036275		
3	062.271	2.271	+0.671	158.807	8.807	-2.924			5.909497	6.640404		
							36.275850	27.272909		9.676679		18.679620
							9.002941					9.002941
							1/2=4.5014705					

# 面積計算書

工区

3

ブロック

73

計算者

(10)

精算者

(10)

備考

2377

Ⅱ, Ⅳ

点	①	②	③	④	⑤	⑥	③	⑤	②	⑥
	X	X-(定数)	X <sub>n-1</sub> -X <sub>n+1</sub>	Y	Y-(定数)	Y <sub>n-1</sub> -Y <sub>n+1</sub>	+	-	+	-
Ⅲ	-152, 034.159	-152.030 4.159	-3.663	-38, 294.727	-38.290 4.727	+3.147	17.315001			13.088373
15	031.167	1.167	+0.671	294.949	4.949	-2.925		3.320779	3.413475	
14	034.830	4.830	+2.992	291.802	1.802	-0.222		5.391584	1.072260	
							17.315001	8.712363	4.485735	13.088373
							8.602638			8.602638
							1/2=4.301319			
Ⅳ	-151, 969.678	-151.960 9.678	-2.319	-38, 299.517	-38.290 9.517	-2.701	22.069923		26.140278	
20	970.751	10.351	+2.992	296.593	6.593	-0.223		19.726256	2.308273	
18	972.670	12.670	-0.673	299.294	9.294	+2.924	6.254862			37.047080
							28.324785	19.726256	28.448551	37.047080
							8.598529			8.598529
							1/2=4.2992645			

計年月  
算日

計算者



検査者



B.NO. 73

各筆面積計算書

地番	算式	隅切	地積	摘要
新保 82-1			1340.66	
" 86			900.96	
" 80-3			37.73	
" 187-(A)			703.01	
" 184-1(B)			1301.47	
" 190			330.02	
" 193			716.90	
" 194-1(B)			281.94	
" 195-1(B)			824.86	
" 199-3			178.69	
" 195-1(A)			806.71	
" 184(A)			572.62	
" 197			738.89	
水路	256.51			
小提	59.64			
スミ切 I		4.49		
" II		4.50		
" III		4.30		
" IV		4.29		
計		17.58	9068.19	
金休			9068.31	
			差 = -0.12	